

YEARS

1999 - 2018

**New Jersey Emergency
Preparedness Conference**

**April 30 - May 4, 2018
Tropicana Casino
Atlantic City, NJ**

CHARTER SPONSORS



Energy for a changing world.™



PSEG

verizon✓



SPECIAL SPONSORS



SPONSORS



Eastern DataCom



THE NEW JERSEY EMERGENCY PREPAREDNESS ASSOCIATION

BOARD OF DIRECTORS & TRUSTEES:

Mike Augustyniak
Trustee

Todd Beibel
Trustee
Verizon

Debbie Bell
Trustee
New Jersey EMS Task Force

Ed Conover
Vice President
NJ Department of Human Services

Kim Contos
Trustee
JCP&L

Lauren Di Giovanni
Executive Director
AtlantiCare

Ed Forte
Trustee

Pat Goelz
Secretary

John Hamilton
Trustee
Mount Laurel EMS

Karen Koptic
Trustee
Atlantic County OEM

Barry Kraus
Treasurer
Atlantic County OEM

Paul Malool
Trustee
US Department of Veterans Affairs

Anthony Mangeri
Trustee
American Military University

Nick Massa
Trustee
Witt Associates

Matthew Steintal
Trustee
Galloway Twsp. Ambulance Squad

William Stevenson
President
Valiant Energy

Andrew Sykes
Trustee
Atlantic City Electric

Gary Szatkowski
Trustee

Ed Velez
Trustee
NJ Transit

Michael J. Ward
Trustee
South Hackensack OEM

Michael Weber
Trustee
PSE&G

Phyllis Worrell
Trustee
Virtua

CONFERENCE SUB-COMMITTEE MEMBERS:

COMMITTEE: MANAGEMENT

Chair: Ed Conover • NJ Department of Human Services
Co-chair: Pat Goelz
Comm. members: John Hamilton • Mount Laurel EMS
Paul Malool • US Department of Veterans Affairs
Bill Stevenson • Valiant Energy

COMMITTEE: SCHOLARSHIP

Chair: Ed Forte
Co-chair: Mike Weber • PSE&G
Comm. members: Debbie Bell • NJ EMS Task Force
Anthony Mangeri • American Military Univ.
Matt Steintal • Galloway Twp. Ambulance

COMMITTEE: HIGHER EDUCATION

Chair: Michael Bradeis • Stockton University
Co-chair: Michael Brandenberger • Galloway Twp Ambulance Squad

COMMITTEE: REGISTRATION

Chair: Lauren Di Giovanni • AtlantiCare
Co-chair : Megan Petitt-Kraus
Comm. members: Karen Richardson

COMMITTEE: SPONSORS / EXHIBITORS

Chair: Lauren Di Giovanni • AtlantiCare
Co-chair: Karen Koptic • Atlantic County OEM
Comm. members: Matt Steintal • Galloway Twp. Ambulance

COMMITTEE: ANNIVERSARY

Chair: Phyllis Worrell • Virtua
Gary Szatkowski
Nick Massa • Witt Associates

THE NEW JERSEY EMERGENCY PREPAREDNESS ASSOCIATION

CONFERENCE SUB-COMMITTEE MEMBERS (continued):

COMMITTEE: VOLUNTEERS

Chair: Michael Ward • South Hackensack OEM
Co-chair: Robert Haffner

COMMITTEE: LOGISTICS

Chairs: Barry Kraus • Atlantic County OEM
Co-chair: Abby Kraus
Comm. members: Stan Carr
Jamie Van Pelt
Andrew Taylor

COMMITTEE: MARKETING / PUBLIC RELATIONS

Chair: Lisa Fagan

COMMITTEE: IT & COMMUNICATIONS

Chair: Ed Velez • NJ Transit
Co-chair: Wayne DeBiasio • Springfield Public Schools
Comm. members: Bill Szemcsak • Cape May FD
Mark Tonkery • NJSP

COMMITTEE: WAYS & MEANS

Chair: Mike Weber • PSE&G
Co-chair: Ed Forte
Comm. members: Anthony Mangeri • American Military Univ.

COMMITTEE: YOUNG PROFESSIONALS

Chair: Paul Malool • US Dept of Veterans Affairs
Co-chair: Jennifer Whytlaw • Rutgers University
Comm. members: Jamie Bodrog-Powell • NJ Dept of Human Services

COMMITTEE: TRAINING

Chair: John Hamilton • Mount Laurel EMS
Co-chair: Mike Augustyniak

MANY THANKS

to the dedicated volunteers that make the New Jersey Emergency Preparedness Conference possible.

VOLUNTEERS (at the time of printing):

Kate Adams
Craig Adams
Katherine Bell
Bob Cassiello
Robert DeMarzio
Helene Dougin
Alison Dougin
Barbara Forsberg
Brett Geiger
Andrew Gilbert
Terry Halifko
Derek Hernandez
Walter Kain
John Kline
Alex Kloian
Eileen Korpar

Bradley Ladislaw
Erin Leswing
Alfred Piombino
Maria Ritz-O'Reilly
Rita Russomanno
Cyntha Smith
Dale Speroni
Arlene Tossaro
Cathy Umrichin
Velma Waterman
Phil Wilk
Marcel Wurms

**Our apologies if we have left any names off the volunteer list. Many thanks for your hard work and dedication.*

BREAKOUT SESSION SCHEDULE

Tuesday, May 1

7:00 - 5:00 **Registration**

10:30 - 11:45 **Breakout Session 1**

1. Bridging the Gap Created by Language Barriers **Bossa Nova**
2. Verizon **Mambo 1/2**
3. National Water Model Products **Mambo 3/4**

1:00 - 2:15 **Breakout Session 2**

1. Overview of the La Nina Winter of 2017-2018 & National Weather Service (NWS) Hazard Simplification **Mambo 3/4**
2. Striving for 25: Developing Resilience for your Career **Mambo 1/2**

2:30 - 3:45 **Breakout Session 3**

1. An Overview of Communications Technologies **Mambo 1/2**
2. Building Relationships that Weather the Storms **Mambo 3/4**

Wednesday, May 2

7:00 - 9:30 **Dedicated Exhibit Hall Time**

8:00 - 10:15 **Breakout Session 4**

1. Texas Deployment **Bossa Nova**
2. iSAT for Disaster Mental Health Responses **Pageant**
3. Parent/Student Reunification After a School Crisis **Mambo 3/4**

10:30 - 11:45 **Breakout Session 5**

1. Florida Deployment **Bossa Nova**
2. Deadly Rip Currants: The Summer of 2017 **Mambo 3/4**
3. Safeguarding the Dementia Journey **Pageant**

1:00 - 2:15 **Breakout Session 6**

1. Puerto Rico Deployment **Bossa Nova**
2. Assessment of Winter Storm Impacts Using Real-Time Road Temperature Data **Mambo 3/4**
3. Emergency Communications and Sustainability **Pageant**
4. Engaging the Faith-Based Community in Disaster Response and Recovery Efforts **Castanet 3/4**
5. Substance Abuse Disorders in Disasters **Tango**

2:30 - 3:45 **Breakout Session 7**

1. U.S. Virgin Islands Deployment **Bossa Nova**
2. Crisis Response to Las Vegas Shootings **Tango**
3. EMS Response to the Opioid Epidemic **Pageant**
4. Making Your Education Work For You **Castanet 3/4**
5. Tidal Total Water Level Forecasts, the Next Step **Mambo 3/4**



BREAKOUT SESSION SCHEDULE

Thursday, May 3



7:00 - 9:30 **Dedicated Exhibit Hall Time**

7:00 - 9:00 **Continental Breakfast**

9:30 - 10:45 **Breakout Session 8**

1. CERT and Damage Assessment **Castanet 1**
2. Communications Interoperability in New Jersey **Bossa Nova**
3. OHSP Toolbox: Programs and Resources to Strengthen State Preparedness **Mambo 1/2**
4. NWS Hurricane Update for 2018 **Castanet 3/4**

11:00 - 12:15 **Breakout Session 9**

1. An Emergency in a Healthcare Facility is NOT the Time to Exchange Business Cards **Mambo 1/2**
2. Earn Money Sleeping: Sleep Loss & Fatigue in First Responders **Castanet 3/4**
3. GPS and GIS: What Are They and Where Are We Going? **Castanet 1**
4. Terminal the Sequel - Re-Constitution of San Juan Intl Airport and the Port of San Juan post Maria **Bossa Nova**

1:30 - 2:45 **Breakout Session 10**

1. Active Shooter Training Without Robbing The Bank **Bossa Nova**
2. Collaborative Response Graphics (CRGs) - Using Visual Planning for Public Safety Emergency Responses **Mambo 3**
3. Domestic Operations and the National Guard **Castanet 3/4**
4. FEMA's Preliminary Damage Assessment and Individual Assistance Programs **Mambo 1/2**
5. The Coordinated Response to a Lost/Missing Person Incident **Castanet 1**

3:00 - 4:15 **Breakout Session 11**

1. Is the Decision to Evacuate Far More Stressful Than the Evacuation Itself? **Castanet 3/4**
2. Amateur Radio for Emergency Managers **Castanet 1**
3. Crisis Communications **Bossa Nova**
4. Dam Safety in New Jersey: Preparing for and Responding to Dam Emergencies **Mambo 3**
5. Public / Private Sector Partnerships - Electric Utility Partnerships **Mambo 1/2**

Friday, May 4

9:00 - 10:15 **Breakout Session 12**

1. Crisis Counseling: Working with Faith-based Leaders in Patterson, NJ and St. Thomas USVI **Castanet 1/2**
2. Damage Prediction Models, Drones and Mutual Assistance - Your Utility is Preparing **Castanet 3/4**
3. Hazardous Waste Operations & Emergency Response **Mambo 3/4**
4. Managing Substation Fires **Mambo 1/2**

10:30 - 11:45 **Breakout Session 13**

1. Modernizing New Jersey's Triage System **Castanet 1/2**
2. NJ Statewide Utility Safety Team **Castanet 3/4**
3. Overview of Flammability Products via Rail and Pipeline **Mambo 1/2**

Jared Maples **Acting Director, New Jersey Office of** **Homeland Security and Preparedness**

Jared Maples was named Acting Director of the New Jersey Office of Homeland Security and Preparedness (NJOHSP) on June 5, 2017. In his role, he serves as the federally designated Homeland Security Advisor (HSA) to the Governor and is the Cabinet level executive responsible for coordinating and leading New Jersey's Counterterrorism, Cybersecurity and Emergency Preparedness efforts.

Director Maples joined NJOHSP in January 2016 as Director of the Division of Administration. The Division of Administration encompasses all information technology and security, human resources, facilities management and financial activities for the Office, including oversight of millions of dollars in federal homeland security grant funding.

Prior to joining NJOHSP, Director Maples spent over a decade at the Central Intelligence Agency (CIA) in a variety of leadership roles and previously worked at the US Department of Defense in the Office of the Secretary of Defense. As a seasoned intelligence officer, his career focused on executive strategy development and execution, organizational and operational change management, emergency operations response, internal security investigations and personnel protection in high threat environments. Director Maples was fortunate to travel around the world on behalf of the US Government, including many deployments to areas of active hostilities.

In 2014, Director Maples was appointed to the Board of Trustees for the Government Employee Voluntary Investment Fund. As a Trustee, Director Maples and the rest of the Board maintain exclusive responsibility for the investment of nearly \$300 million in assets across Growth, Aggressive, Index, and Income funds.

Director Maples holds an MBA from Georgetown University, a Bachelor's degree from Villanova University, and an Associate's degree from Valley Forge Military College.

Commissions/Boards:

- Chair of the NJ Domestic Security Preparedness Task Force (DSPTF)
- Executive Member of the NJ Joint Terrorism Task Force (JTTF)
- Executive Member of the Philadelphia Joint Terrorism Task Force (JTTF)



- Executive Member of the Port of NY/NJ Area Maritime Security Committee (AMSC)
- Member of the National Governor's Assoc. Homeland Security Advisors Council
- Co-Chair of the Statewide Public Safety Communications Commission
- Executive Member of the Oyster Creek Safety Advisory Panel

Albert M. Ponenti

**Lieutenant Colonel New Jersey State Police
Deputy Superintendent of Homeland Security**

LTC Ponenti is a 24 year veteran with the New Jersey State Police and is the Deputy Superintendent of the Homeland Security Branch, commanding the Special Operations and Emergency Management Sections. He currently sits as the State Deputy Director for the Office of Emergency Management and is the former Northeast Regional Intelligence Group Co-Chairman. He is the former Task Force Commander and Director of the Office of the New Jersey Regional Operations and Intelligence Center. He served as the Bureau Chief for the Executive Protection Bureau and was the Unit Head for the Technical Emergency and Mission Specialist Unit. LTC Ponenti earned a Master of Arts degree in Security Studies (Homeland Defense and Security) from the Naval Postgraduate School in 2008, a Master of Arts Degree in Education from Seton Hall University in 1998, and is a graduate of the FBI National Academy Class #248. He is also an adjunct professor at Monmouth University teaching in the graduate studies for Homeland Security Program.

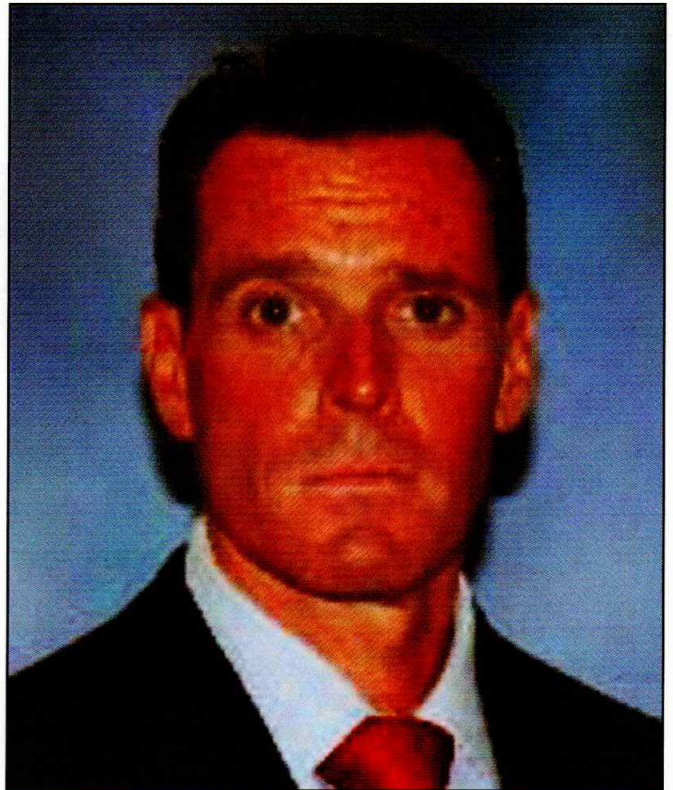

Bill Read

Bill Read retired as Director of the National Hurricane Center in 2012 after a long and distinguished career in the NWS. Bill served as an officer in the US Navy where he flew with the Navy Hurricane Hunters. Bill earned the Bachelor's and Master's of Science in Meteorology from Texas A&M University. He is a Fellow of the American Meteorological Society and has served as President of the National Weather Association. Bill has been recognized for numerous awards, most recently for the Neal Frank award given at the 2015 National Hurricane Conference.



WELCOME

Welcome to the 20th New Jersey Emergency Preparedness Conference!

Well, it's not really the 20th NJEPA Conference...20 years ago NJEPA didn't exist. But you can read about that in our history. Like all things in life, time is the ever present force for change. Hurricanes, tornados, oil spills...9/11, all shaped emergency management in New Jersey, and this shaped the NJEPA.

The only constant however is the people... the planners, the speakers, the sponsors and you the attendees. Many of your names have changed but the roles you perform in serving your communities have not. This conference is for you and dedicated to you; take advantage of it, learn from it, contribute to it. But most of all, take back what you learn this week, back to your community, to better serve those who have selected you.

Change is ongoing, this conference doesn't look like the first, fifth or even last year. As we strive to provide the best possible program for you, at the most reasonable rate, we have had to make tough decisions to save money. These all move our mission forward to train emergency managers.

We hope that you are reading this Monday morning and plan to stay the whole week. But whenever you are looking at it...Thank you! Enjoy your time with us and continue to make yourselves, your communities and this conference stronger in emergency management.

HISTORY

The New Jersey Emergency Preparedness Conference had its humble beginnings as a "grass roots". It started as a conversation at Atlantic County OEM looking for a way to provide higher level training and experiences to local emergency managers. County and State personnel had the opportunity, back then, to attend state, regional and national conferences and the Atlantic County and South Region OEM teams were brain storming ways to bring this kind of information to local EMCs and their teams at no cost. With the tremendous support of the Tropicana Casino Resort and Verizon, the Atlantic County Hurricane Seminar was born.

This first effort presented eight speakers on various topics related to coastal preparedness issues for hurricanes. The oneday seminar was well received by the approximately 200 people in attendance and they requested expanding the program for the following year.

In 2000 we expanded to a 2 day seminar adding a larger program of speakers which required us to recruit more sponsors to fund the popular program which was presented at no charge to attendees.

Expanding the conference would present a number of challenges including increased participation by our host the Tropicana Hotel Casino and the Atlantic County OEM, NJ State Police OEM, sponsors Verizon, State Farm and those behind the scenes people that made the simple seminar a huge success. Several of the local, county, and state emergency management officials had attended the very popular National Hurricane Conference for many years. A small group of them wanted to try and create a conference similar but unlike our friends at the NHC.

The 2001 New Jersey Hurricane Preparedness Conference would be different. It would feature 18 one hour breakout sessions, 2 continental breakfast, 2 sponsored lunches, and an exhibit area for 2 days with 32 exhibitors. This was a logistical and financial nightmare tackled by a handful of very dedicated emergency preparedness professionals. Due to unwavering dedication of a select group of people using creative and out of the box solutions the nearly \$60,000 conference came off very successfully with over 600 attendees.

At the after conference meeting the small group decided that we needed to invest the time and effort to continue our successes by forming the New Jersey Emergency Preparedness Association. This required a strong commitment and backing of our sponsors and partners who were behind us all the way and one current event in world history would be the rocket fuel to the creation of the New Jersey Emergency Preparedness Association and the New Jersey Emergency Preparedness Conference. That date was September 11, 2001. Edward Conover, Founding President and William Melfi, Founding Vice President.

The conference continues today 20 years later, tens of thousands of attendees and thousands of sponsors have made this program the success that it is.

In Honor of Kevin H. Tuno

Kevin H. Tuno, 56, of Burlington City, New Jersey, died Tuesday, Sept. 15, 2015, at his residence in Burlington City surrounded by his loving family. Born in Philadelphia, Kevin was a lifelong Burlington resident. He was the Burlington County Emergency Management Coordinator for the past 17 years, culminating a career with Burlington County that began as an emergency services dispatcher in 1982.

Kevin was also a former chief of the Burlington City Fire Department, a life member of the Young America Fire Co., and Endeavor Emergency Squad, and a member of the Independent Fire Company, all in Burlington. He was also a member of the NJ Preparedness Association.

Burlington County Freeholder Director Mary Ann O'Brien shared the news of Kevin's passing on the Burlington County Government Facebook page with a note about his legacy. "The entire Burlington County community is deeply saddened by the passing of our longtime emergency management coordinator Kevin Tuno. Kevin led the county's response during trying times, including through the Sept. 11 terrorist attacks, the devastating July 2004 flood, and Superstorm Sandy. He will be truly missed," she said.

Kevin had over 30 years of experience in emergency management and disaster response. As the emergency management coordinator, Kevin was instrumental in the formation of the Burlington County Community Emergency Response Teams (CERT). Kevin received a master's degree in administrative science, the Certified Public Manager designation from the state of New Jersey, he was a master exercise practitioner and an adjunct professor at Burlington County College. In his spare time, Kevin enjoyed playing the drums, was an avid music lover and enjoyed photography, and was a favorite uncle to all his nieces and nephews.

Barry E. Eck, president of the New Jersey Emergency Management Association, said in a statement: "Kevin was a talented and dedicated emergency management coordinator who loved his work. His experience and wisdom provided foresight with balance to the otherwise chaotic world of emergency management."

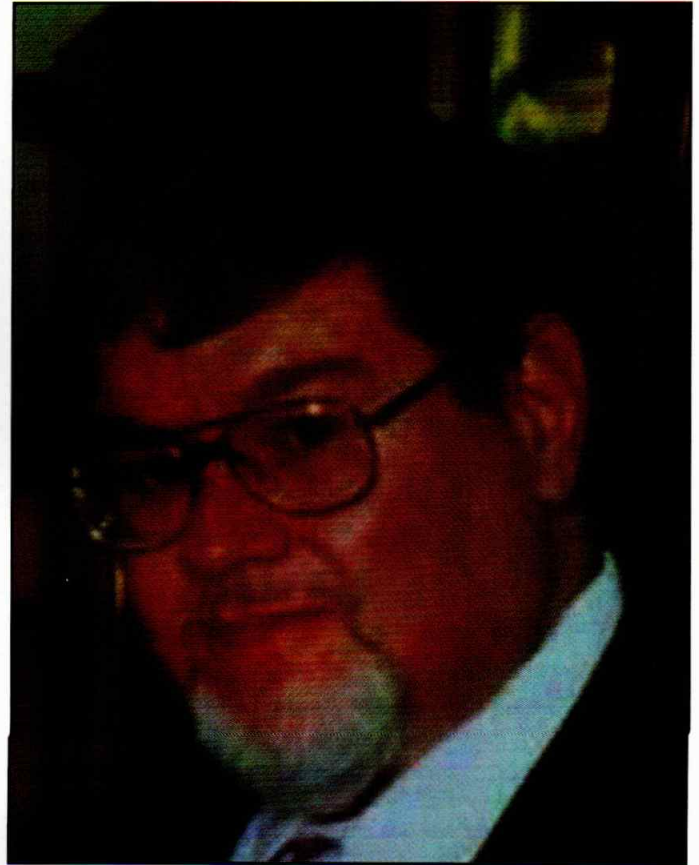

TRAINING & BREAKOUT SESSION SCHEDULE

APRIL 30 • MONDAY • TRAINING SESSIONS

PTEP / 8:00 - 5:00 / Pageant

NAEMT's Psychological Trauma in EMS Patients (PTEP) course gives EMS practitioners the resources they need to help alleviate patients' hidden wounds – intense fear, stress, and pain – during a medical emergency. PTEP educates EMS practitioners about the biological underpinnings of psychological trauma, the short and long-term impact on the brain and body, and warning signs that a patient is experiencing extreme psychological distress. EMS practitioners are also taught strategies and techniques to alleviate patients' distress and help patients cope with what they're experiencing to ward off lingering effects. The 8-hour classroom course features scenario-based interactive sessions and lectures. Topics covered include: • The invisible wounds of psychological trauma • Reducing psychological traumatic stress • Understanding the physiological stress response • Applying the eSCAPe principle to patient care • Patient simulations • Recognizing psychological trauma within EMS PTEP is designed for EMS practitioners and other responders. The course is accredited by CAPCE and recognized by NREMT. Students who successfully complete the course receive a certificate of completion, a wallet card good for 4 years, and 8 hours of CAPCE credit.

Law Enforcement and First Responder Tactical Casualty Care (NAEMT Curriculum) / 8:00 - 5:00 / Carousel

ERHMS Framework Training / 8:00 - 5:00 / Salon 1/2

The New Jersey Medical Reserve Corps (NJ MRC) is a network of community-based, locally organized units comprised of volunteers who help ensure their communities are healthy, prepared, and resilient. In addition to promoting healthy living throughout the year, NJ MRC volunteers are available to be deployed for service during emergencies and disasters. Recognizing the need to protect individuals who may be exposed to hazardous conditions present at emergencies and disasters, the National Institute for Occupational Safety and Health (NIOSH) worked with the U.S. National Response Team (NRT), federal agencies, state health departments, labor unions, and volunteer emergency responder groups to develop the Emergency Responder Health Monitoring and Surveillance™ (ERHMS) framework. The ERHMS framework provides recommendations for protecting emergency responders during small and large emergencies in any setting. The ultimate goal of this training is to ensure NJ MRC volunteers receive: 1) pre-deployment health screening using the ERHMS or comparable health and safety system; and 2) post-deployment, out-processing assessments to determine if they were adversely affected by their deployment duties and, if so, to what extent.

AWR 347 Climate Adaption Planning for Emergency Management / 8:00 - 5:00 / Castanet 1

This course will prepare participants to describe the principles of climate adaptation planning for emergency management and first response processes. This course will train participants to be able to discuss the impact of weather hazards on critical infrastructure and key resources and explain how climate change projects will affect those impacts. The processes of common weather hazards, climate variability, and climate change will be addressed

alongside risk assessment paradigms. Objectives Discuss weather hazards and changing climate patterns; Explain climate-related risks and vulnerabilities specific to emergency management; and Give examples of climate change mitigation and adaptation strategies relevant to emergency management and first response processes.

MGT-452 Physical and Cyber Security for Critical Infrastructure / 8:00 - 5:00 / Castanet 2

The national and economic security of the United States depends on the reliable functioning of critical infrastructure. This course encourages collaboration efforts among individuals and organizations responsible for both physical and cybersecurity toward the development of integrated risk management strategies that lead to enhanced capabilities necessary for the protection of our Nation's critical infrastructure. Participants will identify physical and cybersecurity concerns impacting overall infrastructure security posture, examine integrated physical and cybersecurity incidents and the evolving risks and impacts they pose to critical infrastructure and explore resources that can be applied to improve security within an organization, business, or government entity.

Mental Health First Aid / 8:00 - 5:00 / Castanet 3/4

Mental Health First Aid (MHFA) is an 8-hour course that teaches you how to identify, understand and respond to signs of mental illnesses and substance use disorders. The interactive training gives you the skills you need to reach out and provide initial help and support to anyone who may be developing a mental health or substance use problem or experiencing a crisis. Mental Health First Aid takes the fear and hesitation out of starting conversations about mental health and substance use problems by improving understanding and providing an action plan that teaches people to safely and responsibly identify and address a potential mental illness or substance use disorder. Tools like Mental Health First Aid give First Responders the skills to recognize and respond to immediate crisis – and like first aid or CPR, allows them to stabilize someone and deescalate crisis. Safely deescalating situations is, without question, now a critical mandate for our nation.

SERC/OPRA / 10:00 - Noon / Mambo 1/2

Public Assistance Updates / 1:00 - 5:00 / Mambo 1/2

This training is intended for applicants of the FEMA Public Assistance program. The session will cover Public Assistance program updates, Hurricane Sandy lessons learned, Winter Storm Jonas lessons learned, the project closeout process, how to get reimbursed for FEMA projects, and NJEMGrants overview.

Emergency Management Basic Course / 8:00 - Noon / Mambo 3

A four-hour introductory course for personnel who are new to the field of emergency management. Subject material will include New Jersey Emergency Management Laws and Directives, the Integrated Emergency Management System, the Role of the Emergency Management Coordinator, Training, Exercising Programs and Disaster Recovery. This course may be attended by all New Jersey personnel in the emergency management field.

Shelter Field Guide / 8:00 - 5:00 / Mambo 4

The Shelter Field Guide (SFG) is a tool that can assist emergency managers with their mass care planning efforts, specifically those surrounding sheltering. The SFG provides a comprehensive examination of the sheltering process and what is needed for your planning and response efforts. The class and guide go over aspects of sheltering and topics covering: facilities, staffing, feeding, resources, etc. This is an outstanding class for the emergency manager and each attendee will receive their own SFG.

Homeland Security Exercise & Evaluation / 8:00 - 5:00 / Bongo

About the course: HSEEP provides a set of guiding principles for exercise programs, as well as a common approach to exercise program management, design and development, conduct, evaluation, and improvement planning. HSEEP exercise and evaluation doctrine is flexible, adaptable, and is for use by stakeholders across the whole community and is applicable for exercises across all mission areas. In addition, U.S. Department of Health and Human Services (DHHS) grant guidance for the Public Health Emergency Preparedness (PHEP) program and the Healthcare Preparedness Program (HPP) require all grant recipients (including sub-grantees) to be trained in and use HSEEP. Training consists of a 2-day core curriculum, followed by a "hands-on" exercise on the third day. Students work through several modules and activities which describe and reinforce HSEEP exercise planning, design, conduct, and evaluation methodologies. Activities include developing exercise documentation, holding planning conferences, and honing exercise evaluation skills. A deliberate and detailed explanation of training and exercise management programs are a key component of this class. Course prerequisites: IS-120a: An Introduction to Exercises (mandatory and proof of completion required) IS-100: Incident Command System (desirable) IS-130: Exercise Evaluation and Improvement Planning (desirable) General exercise experience (desirable) Continuing Education: 19 contact hours/credits for NJ Public Health, EMT, Licensed Nursing Home Administrator (LNHA), and Certified Assisted Living Administrator (CALA); nursing CEs vary. You must be registered with NJLMN to receive all CEs except EMT. NOTE: You must attend all three days to get the HSEEP Certificate. Cost: Free to attend Target audience: Healthcare and public health sector emergency preparedness personnel; all emergency management and emergency responders also welcome. Class size limited to 40 students. Please e-mail your IS-120a certificate to Meena.Rathee@doh.nj.gov or fax it to 609-984-5647 with a cover page-Attention: Meena and let her know you will be attending the course at the conference.

sUAS Essentials for Emergency Management / 8:00 - Noon

Bossa Nova Developing your drone program Deploying a drone program should not be taken lightly, the drone industry is rapidly changing both on the regulatory front, the equipment and software being utilized. Should you obtain FAA Part 107 certification or operate under a certificate of authorization (CoA)? What equipment should you buy? Software? Volunteer program, in-house or outsource? Many organizations are publishing standards such as NFPA 2400 or from the Justice Technology Information Center. We will review a few of these publications and highlight important factors to consider when launching a drone program. Ongoing operational considerations shall be presented regarding integrating sUAS in your community. Topics discussed will be centered on maintaining your equipment, daylight ops part 107.29 waivers, special use maps and

emergency airspace authorizations procedures. Additionally, we will demonstrate equipment capabilities and how an aerial drone feed can be broadcasted privately to multiple stakeholders in near real time. Tentatively we will also have a guest speaker on the legal aspects of sUAS. Attendees will be provided with a sample SOG template, sUAS operating checklist, airspace cheat sheet and other goodies. Tentative agenda- 15m Intro 30m Intro to drones in public safety Answers to common questions, Case study, requirements, training, licenses 15m break 45m Operational Considerations & Developing your SOGs Nfpa 2400 overview, eCOA airspace procedures, waivers, and equipment maintenance 30m Legal aspects of suas ops to consider (guest speaker) 15m break 45m Drones as a service live demo (bring your sandals)

Amateur Radio Technician License Course / 8:00 - 5:00

Mariachi LEVEL 1: Technician Class License Exam Requirement: 35-question Technician Written Exam (Element 2). Privileges: All VHF/UHF Amateur bands (frequencies above 30 MHz). Limited operations in certain HF bands. The FCC Technician License exam covers basic regulations, operating practices and electronics theory, with a focus on VHF and UHF applications. Morse code is not required for this license. With a Technician Class license, you will have all ham radio privileges above 30 MHz. These privileges include the very popular 2-meter band. Many Technician licensees enjoy using small (2 meter) hand-held radios to stay in touch with other hams in their area. Technicians may operate FM voice, digital packet (computers), television, single-sideband voice and several other interesting modes. You can even make international radio contacts via satellites, using relatively simple station equipment. Technician licensees now also have additional privileges on certain HF frequencies. Technicians may also operate on the 80, 40 and 15 meter bands using CW, and on the 10 meter band using CW, voice and digital modes. Changes to the Technician Class rules as a result of the recent FCC rule changes are provided in the Technician Class rule changes supplement. ** There is a separate \$60.00 fee for this course. This covers your book, mailing of the book to you so you can study prior to the class and the test fee. You are required to registered for the conference and pay the course fee to attend this course!

Earthquake Tabletop Exercise / 1:00 - 5:00 / Tambora

This table top exercise (TTX) will involve the attendees to role play key leaders responding and recovering from a multi-county earthquake. Positions will include County Emergency Management, Sheriff, Department of Public Works, Town Mayors, Police Departments, Fire Departments, and Hospitals. Scenario timeline will start in 6-hour increments then accelerate to 12-hour, 24-hour, then weekly increments from day-0 to day-60. Purpose of the TTX is to facilitate planning considerations and teamwork when responding to a natural disaster event.

MAY 1 • TUESDAY • TRAINING SESSIONS

All Hazards Disaster Response Course (NAEMT Curriculum) / 8:00 - 5:00 / Carousel

AHDR Course empowers all responders with knowledge and skills to manage patients following a disaster or mass casualty event. Presented in the context of realistic scenarios, the course culminates with a large-scale mass casualty event. Interactive learning modules make for a highly engaging and practical course

with imperative skills including NIMS/ICS, highlighting a team-based approach to the most common MCIs. The New Jersey EMS Task Force has been approved for grant funding from the New Jersey Department of Health for New Jersey non-UASI residents and the Urban Areas Security Initiative (UASI) Grant Program for New Jersey UASI residents to attend this course at no cost. Out of State conference attendees can pay the tuition cost of 99.00 to attend this course.

ERHMS Framework Training / 8:00 - Noon / Salon 1/2

The New Jersey Medical Reserve Corps (NJ MRC) is a network of community-based, locally organized units comprised of volunteers who help ensure their communities are healthy, prepared, and resilient. In addition to promoting healthy living throughout the year, NJ MRC volunteers are available to be deployed for service during emergencies and disasters. Recognizing the need to protect individuals who may be exposed to hazardous conditions present at emergencies and disasters, the National Institute for Occupational Safety and Health (NIOSH) worked with the U.S. National Response Team (NRT), federal agencies, state health departments, labor unions, and volunteer emergency responder groups to develop the Emergency Responder Health Monitoring and Surveillance™ (ERHMS) framework. The ERHMS framework provides recommendations for protecting emergency responders during small and large emergencies in any setting. The ultimate goal of this training is to ensure NJ MRC volunteers receive: 1) pre-deployment health screening using the ERHMS or comparable health and safety system; and 2) post-deployment, out-processing assessments to determine if they were adversely affected by their deployment duties and, if so, to what extent.

PER 335 Critical Decision Making for Complex Coordinated Attack / 8:00 - 5:00 / Castanet 1

This course addresses the vulnerability of any community to a public safety situation, such as an active shooter at a shopping mall; a train derailment with hazardous chemicals; a bombing incident at a commercial district; a plane crash; or chemical, biological, radiological, nuclear, or explosive attack. These attacks, known as complex coordinated attacks, involve multiple threats that often exceed conventional response tactics. These attacks require a joint response involving members from varying disciplines and jurisdictions. The course will enhance the response capabilities of participants by providing them with the knowledge and tools to enable effective response. This course is taught through a combination of classroom instruction and practical exercises. Among the topics covered during the classroom instruction are characteristics of a complex coordinated attack, public safety response considerations, command operations and strategies, and critical information about situational domain awareness. Several notable case studies are also presented to provide real-life examples of the characteristics of a complex coordinated attack. Featured practical exercises allow participants to interact with responders from other disciplines to effectively address a variety of complex coordinated attack scenarios. Participants will work together to identify critical considerations and command strategies. Further, these exercises encourage collaborative decision-making and rapid strategizing.

MGT 310 Jurisdictional Threat and Hazard Identification and Risk Assessment / 8:00 - 5:00 / Castanet 2

The Jurisdictional Threat Hazard Identification and Risk

Assessment (THIRA) course prepares participants to conduct a jurisdictional THIRA. Participant activities focus on the jurisdictional process for determining the ability to respond to human-caused, natural, and technological disasters. Participants will identify threats and hazards of concern, give the threats and hazards context, examine the core capabilities, set capability targets, and apply the results. Objectives At the conclusion of the course, participants will be able to: - Identify the major components of the Threat and Hazard Identification and Risk Assessment (THIRA) process. - Conduct assessments to identify threats and hazards of concern. - Construct likely risk-based scenarios based on the results of a vulnerability assessment. - Estimate consequences for an assigned all-hazards scenario. - Conduct post-scenario surveys to identify jurisdictional required capabilities, compare those capabilities with current capabilities to determine "shortfalls and gaps" (Gap Analysis), and create a jurisdictional strategy to reduce these "shortfalls and gaps" by completing a needs assessment. Prerequisites Completion of the online courses IS-700.a: National Incident Management System (NIMS), An Introduction and AWR-160-W: WMD/Terrorism Awareness for Emergency Responders is recommended, but not required. Target Audience Emergency Management, Emergency Medical Services, Fire Service, Healthcare, Hazardous Materials, Law Enforcement, Other, Public Health, Public Safety Communications, Public Works

NJEMSTF Response to US Virgin Islands / 8:00 - Noon / Castanet 3/4

Within two weeks of each other hurricanes Maria and Irma struck the US Virgin Islands, in September of 2017. As a result, the islands were left heavily damaged, more than 95% of the islands were without power/water, roads were washed out, and record infrastructure damage was recorded that included emergency services and hospitals. As a result, the USVI Emergency Medical System was strained by excessive hours, increased workloads, and was hampered by the conditions as outlined above. The USVI EMS system requested the services of the NJ EMS Task Force (NJEMSTF) to assist with specialized vehicles, personnel, and equipment. through an Emergency Management Assistance Compact request (EMAC). The deployments consisted of over fifty EMS professionals from the NJEMSTF, 25 NJ State Police, and Disaster Response Crisis Counselors from the NJ Department of Health, Division of Mental Health and Addiction Services, Disaster and Terrorism Branch all of whom set aside their regular lives to deploy into an austere environment, one filled with many hazards, to help others, just as they do at home. Learn how the NJEMSTF; collaborated with USVI-DOH and NJDOH, EMS County Coordinators, Logistics and deployment of assets through the US Air Force base at Joint Base Maguire, Dix, Lakehurst, integration of EMS Services, community outreach, repopulation of long-term care facilities, and MORE. The two teams responded to over 600 emergency assignments., law enforcement interventions, and community missions. After meeting with USVI Hospital Administration (Schneider Medical Center), NJ Department of Health representatives assisted the USVI in developing an EMAC request for nurses. Back home, the Department of Health and the New Jersey Hospital Association collaborated to identify a total of 17 nurses who deployed for various time frames in November and December to provide Certified RN Anesthetists, Emergency Department Nurses, and a Certified Nurse Midwife. NJ nurses helped to resolve a nursing shortage at Schneider Regional Medical Center, the only hospital

on St. Thomas, after many nurses left employment as a result of the storms as well as lay-offs.

NJ Traffic Incident Management Safety Guidelines / 1:00 - 5:00 / Castanet 3/4

This course will cover the uniform operational guidelines to ensure safe operations and limit the liability risks by emergency responders dispatched to incidents on limited access highways in the State of New Jersey. These guidelines were formulated based on nationally recognized practices and procedures and input from representatives of those agencies listed under the State of New Jersey Highway Incident Traffic Safety Guidelines for Emergency Responders Committee and endorsed by the New Jersey Office of the Attorney General.

Violence and Mass Casualty Response for Hospitals and First Responders / 8:00 - Noon / Pageant

2017 was punctuated with several major incidents of mass violence. Ranging from the worst mass shooting incident in U.S. history in Las Vegas to the most deadly terror attack in New York City since 9/11 on Halloween day involving a vehicular ramming on a crowded bike path. Incidents of mass violence involving mass shootings, bombings and vehicular ramming attacks produce serious psychological consequences for victims and witnesses, as well as first responders and first receivers with rates of Posttraumatic Stress Disorder (PTSD), Acute Stress Disorder (ASD) and other related conditions being two to three times higher than natural disasters. Such events are likely to entail several foreseeable psychological hazards. It is important for leaders and decision-makers to possess the awareness and skills to help manage the psychosocial consequences of mass violence, including approaches to Psychological Force Protection for on-scene responders. This half-day workshop will provide an overview of the unique psychosocial effects of mass violence and terrorism, as well as strategies to mitigate the psychological effects after disasters of human intention. Lessons Learned from the Pulse Nightclub incident in Orlando will be discussed from a health care perspective also. Participant Outcome: The participant will be able to discuss the psychosocial effects of mass violence on individuals, families, organizations, and communities and first responders and receivers, as well as strategies and techniques for managing the unique behavioral consequences of such events across the event timeline from the zero-hour through long-term recovery Target Audience: Emergency management planners, decision-makers, hospital and healthcare providers, first responders, first receivers, public health workers, behavioral health workers and all disciplines involved in the tactical response to disasters, terrorism and emergencies.

AWR 343 Hurricane Awareness / Noon - 5:00 / Pageant

This course provides emergency managers, first responders, and community members from all sectors with a basic understanding of the latest knowledge in hurricane science, forecasting, warning, and preparedness. This course enhances the ability of state/local decision-makers to identify and describe the hazards associated with hurricanes and to better prepare for and mitigate the impacts of high winds, heavy rain, and storm surge. Objectives Summarize the structure and characteristics of hurricanes and tropical cyclones and their attendant hazards, including high winds, heavy rain, and storm surge; Explain the forecast process and uncertainty associated with predicting hurricane track and intensity; Interpret official forecast and warning products

from the National Weather Service; and Use available decision support tools to prepare themselves, their families, and their organizations when hurricanes threaten.

Homeland Security Exercise & Evaluation / 8:00 - 5:00 / Bongo

About the course: HSEEP provides a set of guiding principles for exercise programs, as well as a common approach to exercise program management, design and development, conduct, evaluation, and improvement planning. HSEEP exercise and evaluation doctrine is flexible, adaptable, and is for use by stakeholders across the whole community and is applicable for exercises across all mission areas. In addition, U.S. Department of Health and Human Services (DHHS) grant guidance for the Public Health Emergency Preparedness (PHEP) program and the Healthcare Preparedness Program (HPP) require all grant recipients (including sub-grantees) to be trained in and use HSEEP. Training consists of a 2-day core curriculum, followed by a "hands-on" exercise on the third day. Students work through several modules and activities which describe and reinforce HSEEP exercise planning, design, conduct, and evaluation methodologies. Activities include developing exercise documentation, holding planning conferences, and honing exercise evaluation skills. A deliberate and detailed explanation of training and exercise management programs are a key component of this class. Course prerequisites: IS-120a: An Introduction to Exercises (mandatory and proof of completion required) IS-100: Incident Command System (desirable) IS-130: Exercise Evaluation and Improvement Planning (desirable) General exercise experience (desirable) Continuing Education: 19 contact hours/credits for NJ Public Health, EMT, Licensed Nursing Home Administrator (LNHA), and Certified Assisted Living Administrator (CALA); nursing CEs vary. You must be registered with NJLMN to receive all CEs except EMT. NOTE: You must attend all three days to get the HSEEP Certificate. Cost: Free to attend Target audience: Healthcare and public health sector emergency preparedness personnel; all emergency management and emergency responders also welcome. Class size limited to 40 students. Please e-mail your IS-120a certificate to Meena.Rathee@doh.nj.gov or fax it to 609-984-5647 with a cover page-Attention: Meena and let her know you will be attending the course at the conference.

Emergency Planning and Preparedness for School Events / 1:00 - 5:00 / Salon 3

Since 2014, the NJ Department of Education's Office of School Preparedness and Emergency Planning, in partnership with the NJ State Police and local first responders have visited over 650 schools to observe active shooter drills. In this session, the presenters will (1) share common findings from past visits, (2) ways to promote awareness regarding school threats, (3) lead a table top activity specific to responding to a school shooting incident and (4) elements to consider in structuring a student reunification plan.

ICS Forms and IAP Development / 8:00 - 5:00 / Salon 4

This program will focus on the use of the Incident Command System (ICS) Forms in accordance with the National Incident Management System (NIMS). This program will include a Fundamental review for Command, Command Staff, and General Staff Roles and Responsibilities. Through active participation those attending the course will work through the various and most commonly used forms in the Incident Command System. Those in attendance will develop through various activities and tabletop

activities Incident/Event Action Plans (IAP's) for operational periods. Participants will also work through the Planning Cycle and the Planning "P". Those in attendance will be given the opportunity to work in an All Hazards model between Police, Fire, EMS, Emergency Management, Public Health, and Hospital Staff. Target audience are those first responder's who based on roles and responsibilities during an incident may be responsible for creating ICS Forms as part of current incident documentation or the development of an Incident Action Plan.

Amateur Radio Technician License Course / 8:00 - 5:00 / Mariachi

LEVEL 1: Technician Class License Exam Requirement: 35-question Technician Written Exam (Element 2). Privileges: All VHF/UHF Amateur bands (frequencies above 30 MHz). Limited operations in certain HF bands. The FCC Technician License exam covers basic regulations, operating practices and electronics theory, with a focus on VHF and UHF applications. Morse code is not required for this license. With a Technician Class license, you will have all ham radio privileges above 30 MHz. These privileges include the very popular 2-meter band. Many Technician licensees enjoy using small (2 meter) hand-held radios to stay in touch with other hams in their area. Technicians may operate FM voice, digital packet (computers), television, single-sideband voice and several other interesting modes. You can even make international radio contacts via satellites, using relatively simple station equipment. Technician licensees now also have additional privileges on certain HF frequencies. Technicians may also operate on the 80, 40 and 15 meter bands using CW, and on the 10 meter band using CW, voice and digital modes. Changes to the Technician Class rules as a result of the recent FCC rule changes are provided in the Technician Class rule changes supplement. ** There is a separate \$60.00 fee for this course. This covers your book, mailing of the book to you so you can study prior to the class and the test fee. You are required to register for the conference and pay the course fee to attend this course!

First Responder Suicide Prevention / 8:00 - Noon / Tambora

This workshop will address the emotional toll first responders face responding to suicide calls and resources for suicide prevention and postvention that exist for responders. Attention will also be paid to the prevalence of substance use disorders and mental health issues that often culminate in a suicidal crisis both in responders and the general community.

Hurrevac Course / 1:00 - 5:00 / Tambora

This is a planning tool to aid in evacuation planning for hurricanes.

MAY 1 • TUESDAY • BREAKOUT SESSIONS

BREAKOUT SESSION 1 • 10:30 - 11:45

Bridging the Gap Created by Language Barriers / Bossa Nova

Verizon and Public Safety / Mambo 1/2

For many years Verizon has been a leader in providing services and solutions to the Public Safety Community. With technology moving forward faster than ever, you need options. By not accepting one solution that gives you most of what you are looking for and simply "getting by", Public Safety entities should look to developing mutually beneficial partnerships with trusted

carriers that can provide evolving solutions, delivering to Public Safety what they need now. Verizon is continuing to develop our network, our products and our services to support Public Safety. Join us for a discussion of what we are accomplishing for the Public Safety community today, and what we are looking to do in the future.

BREAKOUT SESSION 2 • 1:00 - 2:15

Overview of the La Nina Winter of 2017-2018 and National Weather Service (NWS) Hazard Simplification / Mambo 3/4
Winter weather can vary greatly during a La Nina Winter across the Tri-State region, from unseasonably mild to unseasonably cold, with seasonal snowfall ranging from well below to well above average. Typically, the weather we experience is not much driven by the large scale La Nina pattern but by shorter scale weather patterns over the northern Atlantic Ocean, Arctic, and even Pacific. This session will review the winter season that was, and touch on what the causative factors were. In addition, we will discuss the National Weather Service Hazard Simplification initiative that debuted this past winter. How were our efforts to simplify and clarify messaging? Was it easier for you to find and understand our products and services? Finally, what are the NWS hazard simplification plans for the future?

Striving for 25: Developing Resilience for your Career / Mambo 1/2

Being a resilient person allows us to adapt better to the stressors and the trauma that we encounter in our field. Using an interactive discussion format, the participants will learn a variety of coping mechanisms that are grounded in positive psychology to better deal with not only critical incidents but also the day to day stress of our job.

BREAKOUT SESSION 3 • 2:30 - 3:45

An Overview of Communications Technologies / Mambo 1/2

As we are forced to switch to newer digital trunked systems, we are faced with a new terms and acronyms such as "TDMA", "VOCODER", and "Trunking." This talk will help to break down the technology into understandable terms and will go through the pros and cons of such systems. In addition to the newer communications systems, this talk will present alternative modes of communications such as VHF simplex, VHF lowband and even HF single sideband. Also touched upon will be the benefits of including amateur radio in your emergency communications planning.

Building Relationships that Weather the Storms / Mambo 3/4

Whatever role you play, relationships are critical – especially when disaster strikes. This multi-agency panel will discuss the importance of building partnerships across sectors in a collaborative environment for planning, preparation, response, recovery and resiliency. Examples of successful collaborations will be reviewed as well as discussion around challenges when those relationships were not in place.

MAY 2 • WEDNESDAY • TRAINING SESSIONS

Tactical Emergency Casualty Care (NAEMT Curriculum) / 8:00 - 5:00 / Carousel

TECC is designed for civilian EMS practitioners and healthcare

providers who need tactical EMS training. Attendees learn the basic medical care interventions that will help save an injured victim's life (which may include responders) and techniques to safely evacuate the casualties from a tactical or otherwise hostile scene. TECC combines the principles of PHTLS and TCCC and meets the recommendations of the Hartford Consensus document and TECC guidelines.

The New Jersey EMS Task Force has been approved for grant funding from the New Jersey Department of Health for New Jersey non-UASI residents and the Urban Areas Security Initiative (UASI) Grant Program for New Jersey UASI residents to attend this course at no cost. Out of State conference attendees can pay the tuition cost of 150.00 to attend this course.

PER 335 Critical Decision Making for Complex Coordinated Attack / 8:00 - 5:00 / *Castanet 1*

This course addresses the vulnerability of any community to a public safety situation, such as an active shooter at a shopping mall; a train derailment with hazardous chemicals; a bombing incident at a commercial district; a plane crash; or chemical, biological, radiological, nuclear, or explosive attack. These attacks, known as complex coordinated attacks, involve multiple threats that often exceed conventional response tactics. These attacks require a joint response involving members from varying disciplines and jurisdictions. The course will enhance the response capabilities of participants by providing them with the knowledge and tools to enable effective response. This course is taught through a combination of classroom instruction and practical exercises. Among the topics covered during the classroom instruction are characteristics of a complex coordinated attack, public safety response considerations, command operations and strategies, and critical information about situational domain awareness. Several notable case studies are also presented to provide real-life examples of the characteristics of a complex coordinated attack. Featured practical exercises allow participants to interact with responders from other disciplines to effectively address a variety of complex coordinated attack scenarios. Participants will work together to identify critical considerations and command strategies. Further, these exercises encourage collaborative decision-making and rapid strategizing.

MGT 310 Jurisdictional Threat and Hazard Identification and Risk Assessment / 8:00 - 5:00 / *Castanet 2*

The Jurisdictional Threat Hazard Identification and Risk Assessment (THIRA) course prepares participants to conduct a jurisdictional THIRA. Participant activities focus on the jurisdictional process for determining the ability to respond to human-caused, natural, and technological disasters. Participants will identify threats and hazards of concern, give the threats and hazards context, examine the core capabilities, set capability targets, and apply the results. Objectives At the conclusion of the course, participants will be able to: - Identify the major components of the Threat and Hazard Identification and Risk Assessment (THIRA) process. - Conduct assessments to identify threats and hazards of concern. - Construct likely risk-based scenarios based on the results of a vulnerability assessment. - Estimate consequences for an assigned all-hazards scenario. - Conduct post-scenario surveys to identify jurisdictional required capabilities, compare those capabilities with current capabilities to determine "shortfalls and gaps" (Gap Analysis), and create a jurisdictional strategy to reduce these "shortfalls and gaps" by completing a needs assessment. Prerequisites Completion of the

online courses IS-700.a: National Incident Management System (NIMS), An Introduction and AWR-160-W: WMD/Terrorism Awareness for Emergency Responders is recommended, but not required. Target Audience Emergency Management, Emergency Medical Services, Fire Service, Healthcare, Hazardous Materials, Law Enforcement, Other, Public Health, Public Safety Communications, Public Works.

NJ Elmer Fire Service Deployment Act / 8:00 - 10:15 / *Castanet 3/4*

NJ Statewide Fire Resources / 8:00 - 10:15 / *Castanet 3/4*

This course will inform attendees of the various State and County level Fire emergency resources and programs available to them. The Fire Resource Deployment Act along with the Fire Coordination system will be explained and how to access the Fire Coordination system in their community. Fire Mutual Plans and agreements will be discussed.

We will provide information on specialized Firefighting equipment throughout the state and discuss recent large-scale deployments.

AWR 345 Unmanned Aircraft Systems in Disaster Management / 8:00 - 5:00 / *Mambo 1*

Unmanned Aircraft Systems (UAS) are an emerging technology that will likely revolutionize disaster management. This course is an introduction to UAS use in disaster management, from mitigation and preparedness to response and recovery. It is intended to help participants gain a basic understanding of UAS; learn the general concepts to help an agency build a successful UAS program; understand the FAA regulations of UAS; learn the importance of engaging the local community; understand the need to ensure that privacy issues, civil rights, and civil liberties are thoroughly addressed; identify when UAS would enhance a disaster mission; and understand the basics of UAS types and sensors. The overall course goal is to provide a basic overview of UAS so that agencies can learn the first steps in determining if UAS are right for their work. This course provides general guidance to help participants navigate the FAA regulations and application process required to integrate UAS legally and effectively. Participants learn what is covered under UAS regulations, who may operate UAS, what FAA authorization allows, and what the major issues are for UAS integration. The course materials familiarizes participants with the main types and capabilities of rotary and fixed-wing UAS, as well as the types of payloads and missions that generally are best for each with examples of how certain payloads have been or could be used in relevant situations to aid in disaster management. The course provides an overview of several important elements that require full consideration when creating and operating a UAS program, including involving the local community in all stages of UAS program development, and the critical need to protect privacy, civil rights, and civil liberties in a UAS program, including with data collection, retention, management, security, oversight, and accountability. Objectives Explain in basic terms what UAS are and their different types. Explain several ways that UAS can support disaster management. Understand the basic UAS regulations. Discuss several current challenges and issues with UAS. Understand the basic steps in applying for UAS authorization.

AWR 313 Homemade Explosives: Awareness, Recognition and Response / 8:00 - 5:00 / Mambo 2

This course is designed for all levels of first responders who may respond to or encounter a homemade explosives incident. Course Objectives Recognize and identify commercial precursors used in homemade explosives Recognize the physical characteristics of commonly found homemade explosives Recognize homemade explosive processing equipment, and Improvised explosive devices, or IEDs, and their components Apply legal principles to determine probable cause and identify appropriate use of force options in suicide bombing incidents Prerequisites United States citizenship Actively employed or volunteer member of a first responder or emergency management agency Assignment or identification for assignment to a position responsible for conducting WMD training; developing plans, policies, procedures and tactics to govern response; providing specialized response support during WMD incidents; or coordinating initial response to a WMD incident Sufficient tenure remaining in their current or future position to allow for the application of course material upon their return For personnel who desire trainer certification, completion of an instructor training program, and/or documented experience as a trainer Required prerequisites must be verified by the participant's department at the time of application Picture ID, preferably one issued by their department, must be presented to instructors prior to the start of instruction Disciplines Any first responder who may encounter HME components during their work

Large Scale Incident Response – Awareness TTT / 8:00

- 11:45 Tango NEW - EMS Response to the Large-Scale Incidents: LEVEL 1 Awareness Version 2017 (with Train the Trainer) NEW - EMS Response to the Large-Scale Incidents: LEVEL 1 Awareness Version 2017 Course Overview This course was originally developed by the UMDNJ Center for BioDefense in 2002. It is estimated that over fifty percent of EMS Providers participated in this program over a ten-year period. In cooperation with the NJ Department of Health and the NJ EMS Task Force, the University Hospital – Center for Emergency Preparedness and Response (UH-CEPR) has updated and reformatted the program in 2017 to better reflect lessons learned from recent events such as Ebola, transportation accidents, terror attacks, etc. and the impacts on New Jersey Pre-Hospital Response System. Course Objectives To help prepare EMS personnel to better respond to and operate at Large Scale Incidents. Topics This instructor led entry level program prepares the Emergency Medical Services provider for response to a "high profile" or large-scale incident. Topics to be included are:

- Recognition of a Large Scale Incident
- Incident Evaluation
- "ICS for EMS" Roles and Reporting Structure
- Triage – S.T.A.R.T. System – Introductions to new systems
- Proper use of the NJDOH Triage Tag with scenarios
- NJ EMS Task Force – Resources/Tool/Requests
- Roles of the Medical Coordination Centers (MCC)
- Role and Introduction of the County EMS Coordinators
- Wellness Audience All EMS first responders, new and experienced supervisors and officers. Staff assigned to an EMS specific Incident Management Team. Length of Course Approximately 4 Hours (Awareness Course) Approximately 1.5 hours (Train the Trainer Course) - Level 1 Awareness is the pre-requisite.

Substance Abuse Disorders in Disasters / 1:00 - 2:15 / Tango

Crisis Response to Las Vegas Shootings / 2:30 - 3:45 / Tango

The massive shooting at Highway 91 was a tragedy with ripple effects far beyond the immediate casualties. We discuss the experience and lessons learned of six teams of canines and handlers, who responded to this crisis offering support to first responders, families and hotel staff.

Homeland Security Exercise & Evaluation / 8:00 - 3:45 / Bongo

Amateur Radio Technician License Course / 8:00 - 3:45

/ Mariachi LEVEL 1: Technician Class License Exam Requirement: 35-question Technician Written Exam (Element 2). Privileges: All VHF/UHF Amateur bands (frequencies above 30 MHz). Limited operations in certain HF bands. The FCC Technician License exam covers basic regulations, operating practices and electronics theory, with a focus on VHF and UHF applications. Morse code is not required for this license. With a Technician Class license, you will have all ham radio privileges above 30 MHz. These privileges include the very popular 2-meter band. Many Technician licensees enjoy using small (2 meter) hand-held radios to stay in touch with other hams in their area. Technicians may operate FM voice, digital packet (computers), television, single-sideband voice and several other interesting modes. You can even make international radio contacts via satellites, using relatively simple station equipment. Technician licensees now also have additional privileges on certain HF frequencies. Technicians may also operate on the 80, 40 and 15 meter bands using CW, and on the 10 meter band using CW, voice and digital modes. Changes to the Technician Class rules as a result of the recent FCC rule changes are provided in the Technician Class rule changes supplement. ** There is a separate \$60.00 fee for this course. This covers your book, mailing of the book to you so you can study prior to the class and the test fee. You are required to registered for the conference and pay the course fee to attend this course!

Promoting Resilience for First Responders / 8:00 - 11:45

/ Tambora First Responders play an active role in their own resilience and survival. There are also some basic responder and family pre-deployment factors that may reduce the amount of residual stress. This four-hour workshop addresses the importance of preparing First Responder Communities to address traumatic stress and make identifying and responding to their own stress a standard operating procedure. Participants will leave with skills for pre-deployment activities to reduce stress as well as a vernacular for bringing the behavioral health conversation and reducing existing stigma. They will learn warning signs for suicide and substance abuse and will leave with tools from knowing appropriate referrals to the most helpful mobile apps to support the treatment of long term stress reactions. Course Objectives: Participants will examine the challenges of the relationship between the first responder and the behavioral health communities. Participants will understand the numerous additional stresses experienced by the first responders. Participants will be able to describe the link between and prevalence of substance abuse and suicide in the first responder community. Participants will be able to describe interventions and list resources for assisting first responders in addressing issues of trauma or chronic stress.

MAY 2 • WEDNESDAY • BREAKOUT SESSIONS

BREAKOUT SESSION 4 • 8:00 - 10:15

Texas Deployment / *Bossa Nova*

iSAT for Disaster Mental Health Responses / *Pageant*

In addition to providing early interventions, disaster mental health and other responders need to screen, assess and triage as they intervene. The iSAT triangle illustrates the interactive process of these vital tasks. This breakout covers the iSAT fundamentals. It poses questions about the nature of emergencies and a video shows an emergency surge. This sets the stage for what to expect about casualties. It presents 7 key aspects of assessment, 3 screening principles, important screening questions and a triage checklist. Participants will have an opportunity to interact in recognizing various acute medical syndromes based on a person's mental status and somatic signs. There is a focus on specific conditions such Traumatic Brain Injury (TBI), Carbon Monoxide poisoning, reactions to Biological, Nuclear, Incendiary, Chemical and Explosive (B-NICE) events, Acute Stress Disorder, Posttraumatic Stress Disorder and Grief. Educational Objectives: At the conclusion of the breakout, participants should be able to: 1. describe assessment, screening and triage, 2. enumerate 7 key assessment aspects, 3. recognize the mental status and somatic signs of acute syndromes, 4. list the effects of B-NICE events, 5. explain what screening methods might not and might predict PTSD, 6. ask screening questions, 7. use PsySTART™ Mental Health Triage System.

Parent and Student Reunification After a School Crisis; How Prepared is Your Town? / *Mambo 3/4*

School safety has become the most important work of our time. Emergency operations planning between school leaders, business administrators, emergency responders and school staff is a continuous process. Since September of 2014, and in accordance with the School Security Task Force recommendations, the New Jersey Department of Education's Office of School Preparedness and Emergency Planning has conducted over 700 drill observations throughout the State of New Jersey. During these visits, best practices are shared to improve safety and security protocols. In this session, Robert Sensi and Thomas Gambino from OSPEP will present common measures to develop a school-wide reunification plan. Elements to be discussed in this session will include; communication during the crisis, pre-determining the proper reunification location, transporting students to the reunification location, pre-planning of the reunification of the students and parents, established partnerships with first responders (fire, police, public works, transportation), releasing students to parents/guardians, and establishing a family support center.

BREAKOUT SESSION 5 • 10:30 - 11:45

Florida Deployment / *Bossa Nova*

Deadly Rip Currents: The Summer of 2017 / *Mambo 3/4*

At least half of the drownings along the New Jersey shore in 2017 were due to rip currents. Each morning during the summer, a forecaster from NWS-Mount Holly hosts a brief conference call with local beach patrols, so lifeguards can better plan for changing conditions. Lifeguards also share their observations,

which the forecaster uses to augment a risk-based forecast for rip currents. Currently, NWS-Mount Holly is attempting to boost participation in this conference call, which is beneficial to both parties. The end result is that local decision makers are armed with better information to allocate their beach patrol resources accordingly.

Safeguarding the Dementia Journey / *Pageant*

This presentation addresses the Alzheimer's epidemic, the scope and impact of the disease on individuals and society, with special consideration for the safety issues that abound in home care as well as institutional settings. The content is aimed at interventions and safeguarding for various hazards in home and care settings, readiness recommendations for disaster preparedness, ways to address challenging issues such as wandering, gun and driving hazards, and abuse/neglect, suicidal/homicidal situations and triage responses to helpline calls.

BREAKOUT SESSION 6 • 1:00 - 2:15

Puerto Rico Deployment / *Bossa Nova*

Assessment of Winter Storm Impacts Using Real-Time Road Temperature Data / *Mambo 3/4*

Hazardous highway travel is one of the most serious impacts resulting from winter storms in New Jersey. Research has shown that, nationwide, several hundred people die each year in winter-storm related vehicle accidents. Road surface temperature, which is generally not the same as air temperature, is a critical factor in determining whether snow or sleet will melt on contact, and whether or not rain will freeze on contact. Under certain conditions, even a very light rain or snow can very quickly cause roadways to become extremely treacherous. During the winters of 2016-17 and 2017-18 the National Weather Service Forecast Office in Mount Holly has been receiving road temperature reports from about two dozen sites around New Jersey. These reports come from the New Jersey DOT Road and Weather Information System's network of sensors and are updated every two hours during winter weather events. NWS Mount Holly has been using this temperature data in real time to help assess the impact of impending winter storms as well as storms in progress. Also, research is on-going to better understand the relationship between road temperature and other weather variables. More background information and examples of how road temperatures are used will be presented at the conference.

Emergency Communications and Sustainability / *Pageant*

Emergency preparedness & resiliency are key to the sustainability of any community. This session will focus on what local public safety & communications officials can do to help their towns gain points within Sustainable Jersey's certification program. We will discuss creating an easy-to-use communication strategy within your EOP that is readily available & tested by the appropriate staff; diversifying the types of communication channels used in order to expand your message's reach; putting in place a process to identify vulnerable residents & maintain key contacts to facilities servicing such populations; and an overview of Register Ready.

Engaging the Faith-Based Community in Disaster Response and Recovery Efforts / *Castanet 3/4*

As Emergency Managers we are always seeking additional

resources to support our response and recovery operations. Building partnerships is a key way to ensure that our emergency management plans are functional when disaster strikes. The Faith-Based community can serve as a vital supporting partner in any emergency management plan. From mass care operations to mucking out homes, from feeding operations to volunteer support, the Faith-Based community can make a difference. Learn about the NJ Interfaith Council and how congregations across the state are partnering with emergency managers to offer support and vital resources during disasters.

BREAKOUT SESSION 7 • 2:30 - 3:45

U.S. Virgin Islands Deployment / *Bossa Nova*

Lessons Learned from the NJEMSTF Response to the US Virgin Islands / *Mambo 3/4*

Crisis Response to Las Vegas Shootings / *Tango*

The massive shooting at Highway 91 was a tragedy with ripple effects far beyond the immediate casualties. We discuss the experience and lessons learned of six teams of canines and handlers, who responded to this crisis offering support to first responders, families and hotel staff.

EMS Response to the Opioid Epidemic / *Pageant*

Opioid abuse has become our modern-day epidemic, involving illicit drug combinations abused by patients, and providing a clinical treatment challenge for EMS. Each unique combination affects how the patient will present and what combination of medications and skills the EMS will need use. During this lecture, we will discuss some of these opioid concoctions, identify some warning signs to maximize the clinical care you give while keeping yourself safe. This lecture will also talk about current drug monitoring initiatives that NJ EMS has adopted as best practices that you may be able to adopt and improve upon in your jurisdiction.

Making Your Education Work For You / *Castanet 3/4*

Undergraduate and graduate students entering the profession of emergency management may find themselves feeling as if classroom experiences are unrelated to professional practice. This dilemma is compounded by the reality that emergency management is interdisciplinary, and is taught through a number of academic lenses, including (but not limited to) criminal justice, health sciences, public administration, homeland security, civil engineering, and fire science. As a result, students often overlook the experience they've acquired that demonstrate competency sets best suited for a career in emergency management. This session will review emergency management competencies developed under the auspices of the Federal Emergency Management Agency's Emergency Management Institute, and address how these can be reflected on resumes and other professional documents through work completed in undergraduate- and graduate-level coursework in a variety of fields. Attention will also be paid to presenting opportunities for professional development and networking that students should be taking advantage of as they set their sights on a career in emergency management. The session is geared toward undergraduate and graduate students but is also relevant for professionals returning to university settings for additional training or to meet education requirements for advanced job

placement. The session may also be beneficial to professionals currently teaching or looking to teach at the university level and wish to gain a fresh perspective on the relationship between the classroom environment and emergency management practice.

Tidal Total Water Level Forecasts, the Next Step / *Mambo 3/4*

The increasing number of tidal flooding events in New Jersey can range from nuisance to life-threatening. This breakout session will cover the multi-year evolution of NWS Mt. Holly's tidal flooding program and discuss an important new set of products called Total Water Level (TWL) forecasts. Beginning October 2017, NWS Mt. Holly began producing TWL forecasts for fifteen tidal locations throughout coastal New Jersey and Delaware, the Delaware Bay, the Maryland Eastern Shore, and along the tidal portions of the Delaware River. During this breakout session, a simplified TWL methodology will be presented as well as a live demonstration utilizing the Advanced Hydrologic Prediction Service (AHPS) website.

MAY 3 • THURSDAY • TRAINING SESSIONS

Tactical Emergency Casualty Care (NAEMT Curriculum) / 9:30 - 4:15 / *Carousel*

TECC is designed for civilian EMS practitioners and healthcare providers who need tactical EMS training. Attendees learn the basic medical care interventions that will help save an injured victim's life (which may include responders) and techniques to safely evacuate the casualties from a tactical or otherwise hostile scene. TECC combines the principles of PHTLS and TCCC and meets the recommendations of the Hartford Consensus document and TECC guidelines. The New Jersey EMS Task Force has been approved for grant funding from the New Jersey Department of Health for New Jersey non-UASI residents and the Urban Areas Security Initiative (UASI) Grant Program for New Jersey UASI residents to attend this course at no cost. Out of State conference attendees can pay the tuition cost of 150.00 to attend this course.

AWR 213 Critical Infrastructure Security and Resilience Awareness / 9:30 - 4:15 / *Castanet 2*

This course will introduce participants to the key terms, policy, guidance, and preparedness efforts required to safeguard the Nation's critical infrastructure. Participants will review applicable policy and guidance, discuss the risk management framework, describe Federal critical infrastructure security and resilience and information sharing programs, and relate critical infrastructure programs to individual actions. Primary focus will be placed on local preparedness efforts as they relate to the national approach to critical infrastructure security and resilience. An understanding of the national approach to critical infrastructure enables critical infrastructure stakeholders to address local planning within a common framework. Informed planning is consistent with and expands on nationally accepted emergency management standards as the basis for planning across the mission areas of prevention, protection, mitigation, response, and recovery. This course meets Texas Commission on Law Enforcement (TCOLE) requirements for AWR213 Critical Infrastructure Security and Resilience Awareness course #78408.

Emergency Management Basics Course / 9:30 - 12:15 / *Mambo 3/4* A four-hour introductory course for personnel who are new to the field of emergency management. Subject material will include New Jersey Emergency Management

Laws and Directives, the Integrated Emergency Management System, the Role of the Emergency Management Coordinator, Training, Exercising Programs and Disaster Recovery. This course may be attended by all New Jersey personnel in the emergency management field. ** You are only required to attend 1 (one) 4-hour session!!

AWR 118 Biological Incidents Awareness / 9:30 - 4:15 / Bongo

This course provides a brief overview of biological incidents that have occurred; biological agents that are naturally occurring, could be accidentally released, or could be used deliberately; the typical course of disease and how that may vary in a deliberate incident; an overview of biological agents as terrorist weapons; and methods of protection from biological agents (with an emphasis on protection using methods and equipment readily available to emergency responders and the general public). This course can be considered an introductory course to Emergency Response to Domestic Biological Incidents (PER-220).

IAEM Prep Course / 1:30 - 4:15 / Tango

MAY 3 • THURSDAY • BREAKOUT SESSIONS

BREAKOUT SESSION 8 • 9:30 - 10:45

CERT and Damage Assessment / Castanet 1

Proper, timely and accurate damage assessment after a major event is essential to recovery. The Community Emergency Response Team can be a valuable asset to conducting an area or jurisdiction-wide assessment. The use of Tools such as the ORION program make a potentially effective tool. When combined with an effective training program and efficacious exercises the Team becomes a valuable asset to Emergency Management. This session will discuss all aspects of CERT damage assessment preparedness.

Communications Interoperability in New Jersey / Bossa Nova

This program will discuss the Governance, Standard Operating Procedures, Technology, Training and Exercises, and Usage of communications interoperability programs and assets throughout the state. We will also discuss our regional planning efforts with our surrounding states and federal partners.

OHSP Toolbox: Programs and Resources to Strengthen State Preparedness / Mambo 1/2

The New Jersey Office of Homeland Security and Preparedness (NJOHSP) strengthens the security and resiliency of New Jersey by managing risks through collaborative and integrated efforts of the whole community. The office conducts ongoing outreach to local communities, offers security assessments to identify vulnerabilities, and provides critical risk analysis to share actionable information and training to both the public and private sector and New Jersey residents. This session will feature a multi-disciplined group of NJOHSP representatives, that will discuss a variety of tools and opportunities to assist stakeholders with preparing their communities and organizations for both man-made and natural events. During this breakout session, representatives will deliver brief presentations on the Hometown Security Initiative, the Regional Intelligence Academy and other training offerings, vulnerabilities assessments and implementing protective measures, funding opportunities, and cybersecurity.

NWS Hurricane Update for 2018 / Castanet 3/4

BREAKOUT SESSION 9 • 11:00 - 12:15

An Emergency in a Healthcare Facility is NOT the Time to Exchange Business Cards / Mambo 1/2

Healthcare Facilities, Emergency Management, and Emergency Service Agencies need to know one another and be comfortable with each other before emergencies arise. So too is it critical that the healthcare facilities in proximity know one another and develop a level of trust between them for when emergencies occur. Just as politics must stop at the water's edge, in times of emergencies, cooperation must replace competition between healthcare facilities. This breakout session will provide best practices for forming an effective healthcare facilities emergency preparedness committee to foster strong relationships among and between facilities and emergency management.

Earn Money Sleeping: Sleep Loss & Fatigue in First Responders / Castanet 3/4

Fatigue and poor sleep hygiene are so commonplace in first responders that we accept it as the norm. Increased public awareness of fatigue related accidents, medical errors, and first responder mental health, challenges providers and leaders to examine the priority of sleep in their lives and agencies. Amy will discuss the importance of quality and quantity of sleep, related physical and mental comorbidities of poor sleep hygiene, and tools for responders to improve their sleep methods and environment.

GPS and GIS: What Are They and Where Are We Going?

Castanet 1 If you were ever interested in learning the background of what GPS and GIS can do and where they came from, now is the time. We will provide you the basics of the Global Positioning System (GPS), why was it created in the first place, its relative accuracy, and the limits of where you can and can't rely on it to tell you where you are. Next you will receive a brief overview of Geographic Information Systems (GIS) when did mapping start to help see the picture and how it can quickly pull data together in a helpful map of the area. Finally, we will show you how GPS and GIS can work together to help first responders see the whole picture.

Terminal the Sequel - Re-Constitution of San Juan Intl Airport and the Port of San Juan Post Maria / Bossa Nova

This presentation will cover deployment activities pertaining to an EMAC request from the Commonwealth of Puerto Rico to the Port Authority of New York & New Jersey post Hurricane Maria. Unlike typical EMAC requests that support search & rescue or other public safety aspects this request was specific to restoring the infrastructure of the Port of San Juan and the airports in Puerto Rico. The presentation will focus on pre-deployment and deployment considerations, medical support, security, logistics supply chain and activities at San Juan International Airport and the Port of San Juan.

BREAKOUT SESSION 10 • 1:30 - 2:45

Active Shooter Training Without Robbing The Bank / Bossa Nova

Valley Health System consists of an inpatient hospital, multiple outpatient locations, as well as a home care agency and a medical group with over 73 practices located throughout Northern New Jersey. Valley was looking for a cost-effective way to roll out

their active shooter protocol as well as provide drills at as many locations as possible. Valley provided ALICE training to all employees and then did 30-minute pop up drills in departments within in the hospital and off-site locations. This breakout session will review the selection of ALICE protocol, evaluation of high risk areas, mandatory annual ALICE training and the drills, drills at outpatient areas, all provided in a cost-effective manner. There will be a lessons learned segment which we will cover the mandatory steps in conducting a full-scale exercise, including the planning and safety aspects in an active area, and in getting community buy in from your stakeholders. In addition, it will cover workplace violence and programs and training put in place along with positive results. Session will be a combination of lecture, videos of previous drills and a question and answer session.

Collaborative Response Graphics (CRGs) - Using Visual Planning for Public Safety Emergency Responses / Mambo 3

The July 22, 2004 Final Report of the National Commission on Terrorist Attacks Upon the United States (Commonly referred to as the "911 Commission Report") listed recommendations that public safety had to consider to better safeguard our homeland and domestic security needs. Among the critique of the public safety response was the lack of communications interoperability between the diverse entities that responded to the tragic events of September 11, 2001. However, in a quest to ensure that public safety and private security professionals could connect communication systems we ran past an essential and critical, yet basic, component to our communication needs. Question: Once our systems are connected, what language will we speak? When SEAL Team 6 was tasked with killing or capturing Usama Bin Laden during Operation Neptune Spear, they had every conceivable resource of the United States government at their disposal. They could have any tool they desired to plan that operation, and with nearly limitless resources and options, they chose a singular piece of paper — a visual plan. That plan, known in the military as a Gridded Reference Graphic (GRG), can be seen sitting unassuming in front of Secretary Clinton in the famous White House Situation Room photo captured during the operation. The power of that photo is just now being realized. Back in May of 2011, while US public safety professionals still plodded along with text-based plans, everyone connected with Neptune Spear—from the President of the United States to a SEAL operator in Abbottabad, Pakistan half a world away — was looking at the same piece of paper: a GRG of the plan. They literally were "on the same page". The Gridded Reference Graphic has now come home and is available as its domestic equivalent — the Collaborative Response Graphic (CRG®). The Critical Response Group is made up of former members of our military's Joint Special Operations Command and former police executives. The Critical Response Group creates CRGs by combining a gridding system, aerial imagery, floor plans, critical features, and key plan components into a simple to decipher geospatially accurate graphic. When viewed on a GPS-enabled smart device, the user is plotted on top of the plan in real time. At its core a CRG allows for a simple and common language, and instant visualization of key emergency plan components. A contact team trying to communicate the location of a shooter in the band room doesn't need to know anything.

Domestic Operations and the National Guard / Castanet 3/4

We will discuss the role of the National Guard during Emergency

Operations and clarify some misconceptions and answer unknown questions about the National Guard. The process for requesting assets and/or capabilities via e-Teams e.g., Soldiers, equipment, vehicles, aviation, etc. The Intelligence behind operations and the processing, analysis, and dissemination of products to interagency partners for damage assessments of critical areas, infrastructure, etc. Sharing Situational Awareness tools for damage assessments utilizing Full Motion Video and still images answering Prioritized Intelligence Requirements by decision makers. The role of the Civil Support Team in conjunction with chemical and biological threats and the response that follows. The Homeland Response Force responsibilities during civil disturbance/unrest. Finally, a briefing on the partnership between the ROIC and the Joint Operations Center.

FEMA's Preliminary Damage Assessment and Individual Assistance Programs / Mambo 1/2

After a disaster it is important to capture the extent of damage that occurred. Conducting Preliminary Damage Assessments (PDAs) is an important part of obtaining a Presidential Declaration in the aftermath of a disaster. This session is designed to provide emergency managers with insight on how to conduct PDA's. Once the Presidential Declaration is received it can be for FEMA's Public Assistance or Individual Assistance programs. This session will focus on the Individual Assistance program and explain the type of disaster assistance services available to survivors who register with FEMA.

The Coordinated Response to a Lost/Missing Person Incident

Castanet 1 Unfortunately, there currently exists no common concept of operations, standard of care, or certification at any level of government for lost and missing persons search and rescue response within the State of New Jersey. Inconsistent coordination and response to these events, jeopardizes the safety of the subject, prolongs family grief, and puts responders at increasing levels of risk and legal liability. This planning initiative will address these issues by creating a coordinated response to the lost or missing person incident.

BREAKOUT SESSION 11 • 3:00 - 4:15

Is the Decision to Evacuate Far More Stressful Than the Evacuation Itself? / Castanet 3/4

Over two successive years, mandatory evacuations have been ordered for the New Jersey coastline — the first Hurricane Irene in August 2011, and Hurricane Sandy October 2012. There has only been one other time when an evacuation initiated, and that was a "voluntary" evacuation for Hurricane Gloria September 1985. Prior to the hurricanes mentioned above, one of the main concerns, voiced by many in the Emergency Management Community has been, "how are we going to successfully evacuate since it has never been attempted before?" Other parts of the United States' vulnerable coastlines have successfully evacuated several times, but there have been cases where things went terribly wrong. What can we expect in the most densely populated state in the country? A standing joke among many emergency managers has been, "why, we evacuate every Sunday! If that is the case, then why hesitate when a threat is looming in the Atlantic Ocean? This presentation will examine how the evacuations for Hurricanes Irene and Sandy differed from what we experience on our roadways every Sunday during the summer season. You just might be surprised! Marty Pagliughi, Emergency

Management Coordinator for one of the most difficult counties to evacuate, Cape May – Vincent Jones, Emergency Management Coordinator for Atlantic County – and Jim Eberwine, retired Hurricane Program Manager from the National Weather Service will explain different parts of the evacuation scenario.

Amateur Radio for Emergency Managers / *Castanet 1*

Amateur or "HAM" radio has proven to be indispensable in the aftermath of Hurricanes Ivan and Maria. Historically, Amateur radio has been a valuable resource in the Response and Recovery phases of many disasters, providing expedient communications when standard public safety and commercial telecommunications infrastructure has been severely impacted or completely overwhelmed. This workshop will provide guidance to Emergency Managers on establishing a viable, NIMS compliant, AUXCOMM (Auxiliary Communications) program as part of your EOP within ESF-2. TOPICS: • Recruiting, retaining and motivating volunteer "hams". • Where does Auxiliary Communications sit in the NIMS ICS COMU • What are ARES, RACES, AUXCOMM, SKYWARN, - Differences? Overlap? Coordination / Integration into your program • What resources / support are available from State and Federal agencies • What equipment is required / how much will it cost? • Amateur Radio – What's New? (This is not your grandad's ham radio) – utilization of newer IT based technologies to supplement voice i.e. Digital ICS Form transmission, utilizing digital modes in a HIPPA Compliant environment, Wireless Broadband "MESH" Networking for transmission of on scene video etc. • Recent and relevant examples of successful Amateur Radio program deployments and integration into jurisdictions will be included in the workshop as well as some limited equipment " Show and Tell".

Crisis Communications / *Bossa Nova*

The ability of emergency management to communicate their strategies and inform the public adequately during time of crisis is essential. This workshop will introduce the notion of using the media as a strategic partner, defining the publics to be served and role of emergency managers in communicating with the community to manage crisis. We will also discuss building the perception of emergency management programs before a disaster and working to promote the Whole Community approach to preparedness.

Dam Safety in New Jersey: Preparing for and Responding to Dam Emergencies / *Mambo 3*

It wasn't long ago that New Jersey faced tremendous rainfall events such as Tropical Storm Irene in 2011 and the Burlington County Flood in 2004, which wreaked havoc on dams in the State. With all dams, there comes the potential for emergency situations to develop. The New Jersey Department of Environmental Protection's Bureau of Dam Safety works to ensure the safety and integrity of dams in New Jersey, thereby protecting people and property from the consequences of dam failures. The Dam Safety Program is responsible for the oversight of approximately 1,700 dams in the State and it is critical that dam owners and emergency management officials are prepared to respond to dam emergencies. The goal of this presentation is to provide an overview of how dams fail, emergency action planning, recognition and response to dam emergencies, security concerns, and recent case studies.

Public / Private Sector Partnerships - Electric Utility Partnerships / *Mambo 3/4*

Your electric utility has established a mutually beneficial relationship with the public sector. What your local electric utility is doing to partner with your local and state government agencies, and why it makes sense for both parties.

MAY 4 • FRIDAY • TRAINING SESSIONS

Incident Response to Terrorist Bombings / 8:00 - Noon /

Carousel The four-hour performance level IRTB course provides basic information on explosive and incendiary devices that could be used as terrorist weapons. Classroom topics include: Understanding the terrorist threat Improvised explosive devices (IEDs) Safety issues Departmental or agency policies to ensure compliance with local requirements This course will directly precede the live bomb demo at Bader Field.

IAEM CEM EXAM

MAY 4 • FRIDAY • BREAKOUT SESSIONS

BREAKOUT SESSION 12 • 9:00 - 10:15

Crisis Counseling: Working with Faith-based Leaders in Patterson, NJ and St. Thomas USVI / *Castanet 1/2*

NJ DOH Division of Mental Health and Addiction Services Disaster and Terrorism Branch continues to work with faith-based leaders and their communities in addressing psychosocial needs in the aftermath of community traumatic events and disasters. Providing Psychological First Aid and disaster mental health psycho-education training to community religious professionals will be discussed.

Damage Prediction Models, Drones and Mutual Assistance - Your Utility is Preparing / *Castanet 3/4*

The ability of emergency management to communicate their strategies and inform the public adequately during time of crisis is essential. This workshop will introduce the notion of using the media as a strategic partner, defining the publics to be served and role of emergency managers in communicating with the community to manage crisis. We will also discuss building the perception of emergency management programs before a disaster and working to promote the Whole Community approach to preparedness.

Hazardous Waste Operations & Emergency Response / *Mambo 3/4*

The main topic for this breakout session is the Public Employee Occupational Safety & Health, Hazardous Waste Operations & Emergency Response Standard (29 CFR1910.120), including requirements for establishing Emergency Response Plans (ERP) covering anticipated emergencies and training. ERPs must also be negotiated and recognized by and coordinated with all parties involved in potential responses at every organizational level. Every party to the ERP must be cognizant of their specific responsibilities and appropriately trained and competent to perform them. Other related sections of 1910.120 and other related PEOSH standards will be reviewed. In addition, presenters will demonstrate access to Right to Know (RTK) Survey Data from the NJDOH and NJDEP systems and how using them can provide invaluable information before, during and after a response. RTK databases provide information

essential to identify and assess potential chemical hazards in your jurisdictions, establish a comprehensive ERP, and exercise your plan. During a response, reviewing the information on the NJDOH Hazardous Substance Fact Sheet (especially the "Quick Reference" section) along with the Manufacturer's Safety Data Sheet is imperative to assessing the chemical hazards and severity of risk to responders and the public.

Managing Substation Fires / Mambo 1/2

This course will cover the hazards and response tactics associated with high voltage transformer firefighting in a substation environment. These are low frequency high hazards incidents that do not occur often enough for members to sharpen their respective skill set in this field. As such, training remains paramount in firefighter safety while operating at these incidents. Course participants will learn about electrical safety, chemical hazards, appliances and suppression agents along with the safe standoff distances required to stage an attack. The course will also cover key lesson learned which must be applied while operating at these facilities.

BREAKOUT SESSION 13 • 10:30 - 11:45

Modernizing New Jersey's Triage System / Castanet 1/2

The last major revision to New Jersey's prehospital mass casualty incident (MCI) triage policy occurred in 2003. This update identified the New Jersey specific triage tag and the S.T.A.R.T triage system as the best available at the time. Several area agencies including the Fire Department of New York have recently made significant updates to their Emergency Medical Services mass casualty incident triage practices. The UH CEPR has conducted a review of START, SALT and other triage methods. This presentation covers the Centers proposed changes to New Jersey's Emergency Medical Services MCI policy.

NJ Statewide Utility Safety Team / Castanet 3/4

The New Jersey Statewide Utility Safety Team is focused on enhancing coordination between and among emergency responders and response groups to: Better Understand Response Needs Coordinate Best Practice Responses Share Information to Response Organizations This Team comprises all NJ Gas Utilities and Emergency First Responders from throughout the State. The Team came together after realizing there were no standard practices for responding to a gas leak. Statewide guidelines, processes and procedures were developed and shared with all potentially responding Emergency and Non-Emergency First Responders. Only the State of Georgia has organized such a concerted effort among Emergency and Non-Emergency First Responders. The work of the Team is training, exercises and distribution of timely, important information in the form of Statewide Safety Alerts.

Overview of Flammability Products via Rail and Pipeline

Mambo 1/2 The target audience is all levels of emergency responders. Historically, when no one is sure how to handle a situation they call the fire department and expect action leading to a positive outcome. The fire department has become the catch all agency and therefore must take the time and effort to attain skills and knowledge related to potential emergencies. It is imperative that the line suppression personnel, the command staff and the administrative staff all understand the same 'who, what, when, where, how and why' of unique operations involving

railroads and/or pipelines. This helps ensure a safer, smoother and better coordinated mitigation effort. The transportation of flammability products via rail and pipeline is rapidly increasing. Rail lines are running on many routes that pre-date the Civil War and around which towns and cities have grown. Pipelines often follow railroad rights-of-way. Large scale spills and fires involving flammable products were predominately a fixed facility event with immediately available site personnel, fire brigade and specialized equipment and extinguishing agents. Rail and pipelines transverse areas remote from the fixed facilities, and thus this type of incident is a unique challenge to the local fire department. This workshop will afford participants with the background fundamentals to prepare for and develop pre-incident plans for these type incidents and how to engage the community. These incidents are long term, large scale operations that require extensive mutual aid and all parties must work together under a single pre-determined, coordinated plan. The pre-incident plan must cover all four command functions and include all potentially involved agencies, local, county, state, federal and private sector, especially the railroad and/or pipeline company. Any agency with a freight rail line or pipe line in their general area has the potential to be operating at a large-scale incident. Preparation is a must for a successful, coordinated operation.

TRAINING SCHEDULE

A variety of training opportunities are available to emergency responders, both public and private, to enhance response capabilities. These classes cover a wide range of topics and we attempt to present offerings in multiple disciplines. All classes receive certification and CEUs may be available. These programs are offered as part of the conference registration fee but class sizes are limited and only available on a first come first serve basis. Registration confirmation is required to attend.

| Monday, April 30 8:00 - 12:00 | | Monday, April 30 1:00 - 5:00 | | Tuesday, May 1 8:00 - 12:00 | | Tuesday, May 1 1:00 - 5:00 | |
|---|--|--|--|---|--|---|--|
| PTEP (Pageant) | | | | All Hazards Disaster Response Course (NAEMT curriculum) (Carousel) | | | |
| Law Enforcement and First Responder Tactical Casualty Care (Carousel) | | | | PER-335 Critical Decision Making for Complex Coordinated Attack (Castanet 1) | | | |
| ERHMS Framework Training (Salon 1/2) | | | | ERHMS Framework Training (Salon 1/2) | | | |
| WR 347- Climate Adaption Planning for Emergency Mgmt. (Castanet 1) | | | | MGT. 310-Jurisdictional Threat and Hazard ID and Risk Assessment (Castanet 2) | | | |
| MGT-452 Physical and Cyber Security for Critical Infrastructure (Castanet 2) | | | | Homeland Security Exercise & Evaluation (Bongo) | | | |
| Mental Health First Aid (Castanet 3/4) | | | | ICS Forms and IAP Development (Salon 4) | | | |
| PER-230 (Bongo) | | | | Amateur Radio Technician License Course (Mariachi) | | | |
| Shelter Field Guide (Mambo 4) | | | | NJEMSTF Response to USVI (Castanet 3/4) | | NJ Traffic Incident Mgt. Safety Guidelin (Castanet 3/4) | |
| Homeland Security Exercise & Evaluation (Bongo) | | | | Violence and Mass Casualty Response (Pageant) | | AWR-343 Hurricane Awareness (Pageant) | |
| Amateur Radio Technician License Course (Mariachi) | | | | First Responder Suicide Prevention (Tambora) | | Hurrevac Course (Tambora) | |
| sUAS Essentials for Emer. Mgt. (Bossa Nova) | | Earthquake Tabletop Exercise (Tambora) | | Young Professionals Event (Bossa Nova) | | | |
| SERC/OPRA - 10:00 - Noon (Mambo 1/2) | | Public Assistance Updates (Mambo 1/2) | | Emergency Planning for School Events (Salon 3) | | | |
| Emer. Mgt. Basic Course (Mambo 3) | | Emer. Mgt. Basic Course (Mambo 3) | | | | | |
| Wednesday, May 2 8:00 - 10:15 | | Wednesday, May 2 10:30 - 11:45 | | Wednesday, May 2 1:00 - 2:15 | | Wednesday, May 2 2:15 - 3:45 | |
| Tactical Emergency Casualty Care (NAEMT Curriculum) (Carousel) | | | | | | | |
| PER-335 Critical Decision Making for Complex Coordinated Attack (Castanet 1) | | | | | | | |
| MGT. 310-Jurisdictional Threat and Hazard Identification and Risk Assessment (Castanet 2) | | | | | | | |
| AWR 345- Unmanned Aircraft Systems in Disaster Mgt. (Mambo 1) | | | | | | | |
| AWR 313-Homemade Explosives: Awareness, Recognition and Response (Mambo 2) | | | | | | | |
| Homeland Security Exercise & Evaluation (Bongo) | | | | | | | |
| Amateur Radio Technician License Course (Mariachi) | | | | | | | |
| Large Scale Incident Response- Awareness TTT (Tango) | | | | I-402 (Tambora) | | | |
| Promoting Resilience for First Responders (Tambora) | | | | Substance Abuse Disorders in Disasters (Tango) | | Crisis Response to Las Vegas Shootings (Tango) | |
| NJ Emergency Fire Service Deployment Act (Castanet 3/4) | | NJ Statewide Fire Resources (Castanet 3/4) | | | | | |
| Thursday, May 3 9:30 - 10:45 | | Thursday, May 3 11:00 - 12:15 | | Thursday, May 3 1:30 - 2:45 | | Thursday, May 3 3:00 - 4:15 | |
| Tactical Emergency Casualty Care (NAEMT Curriculum) (Carousel) | | | | | | | |
| AWR 213 Critical Infrastructure Security and Resilience Awareness (Castanet 2) | | | | | | | |
| AWR 118 Biological Incidents Awareness (Bongo) | | | | | | | |
| Emergency Mgt. Basics Course (Mambo 3/4) | | | | IAEM Prep Course (Tango) | | | |
| Friday, May 4 9:30 - 10:45 | | Friday, May 4 11:00 - 12:15 | | For questions about the schedule or courses, please contact the following: | | | |
| Incident Response to Terrorist Bombings (Carousel) | | | | Training Committee Chair: John Hamilton / john.hamilton@njepa.org | | | |
| IAEM CEM Exam (No A/V) (Tango) | | | | Breakout Committee Chair: Pat Goelz / pmgoelz@verizon.net | | | |

4TH FLOOR - SOUTH TOWER

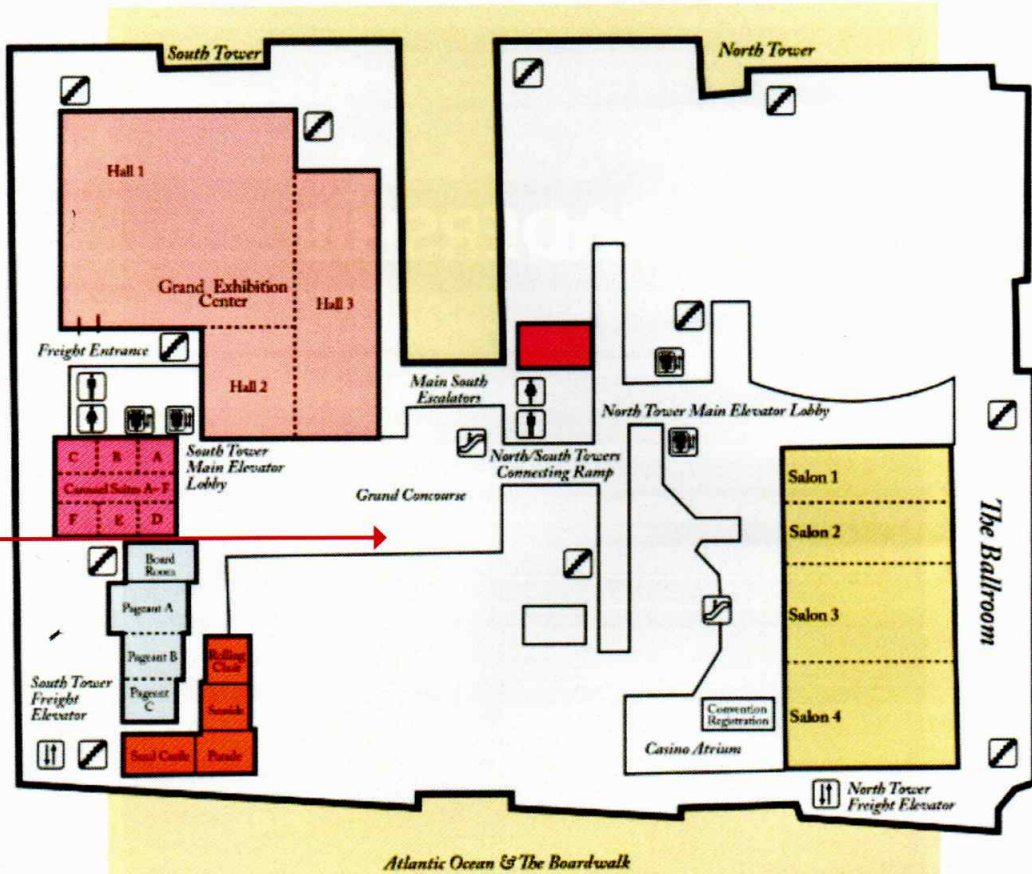

REGISTRATION

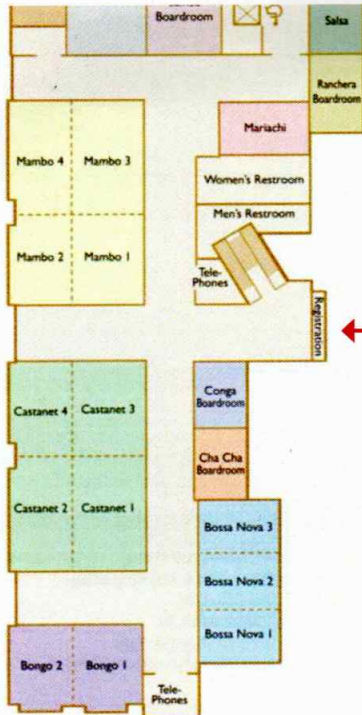

**HAVANA TOWER
LEVEL 4
MEETING ROOMS**

EXPRESS REGISTRATION

EMERGENCY MANAGEMENT & LEADERSHIP

UNDERGRADUATE AND GRADUATE CERTIFICATES

Developed in partnership with key professional training organizations,
American Military University offers public safety leaders:

- Support through scholarship programs
- Cohort class registration options
- Financial incentives available for select partnerships

TAKE THE NEXT STEP TOWARD YOUR LEADERSHIP GOALS. LEARN MORE TODAY AT
PUBLICSAFETYATAMU.COM/NJEP2015



HFS



Hytrans Fire System

mobile water supply

**30 years experience
in mobile water supply!**

FDIC
INTERNATIONAL
BOOTH 9236



**FULL AUTOMATIC
HOSE RECOVERY
SYSTEM**



Hytrans enables fast and reliable mobile water
transport over long distance

Deployed in minutes with a minimum of manpower

Hydraulically driven pumps can go up to 2,000 GPM @ 115psi



Contact: Haines Fire & Risk Consulting
609-388-4467
Southampton, NJ
Sales@hainestire.com
www.hainesfire-risk.com/hytrans



EXHIBITORS



A&M Industrial is a full line industrial supplier supporting customers with 24/7 emergency teams who are ready to respond to any operational emergency. The company offers a diverse line of MRO products in Cutting Tools and Abrasives, Safety Products, Material Handling & Storage Equipment and Process Equipment.



Service. Leadership. Relevance. These values guide **American Military University**. Our students are part of a global community of distance learners. Open to all and focused on those who serve. AMU offers response professionals academic programs combining theory with real-world experience. We want you to make an informed decision about the university that's right for you. For more about our graduation rates, the median debt of students who completed the program, and other important information, visit www.apus.edu/disclosure.



American Signal Corporation (ASC) is a leading designer and manufacturer of mass notification solutions for a wide variety of applications worldwide.



AramSCO is the leading provider for environmental safety, emergency preparedness, and surface preparation markets. We offer quality products, an experienced sales staff, and reliable delivery.



Energy for a changing world.™

Atlantic City Electric, subsidiary of Exelon Corporation the nation's leading competitive energy provider, provides electric delivery services to more than 547,000 customers in southern New Jersey including Atlantic, Cape May, Cumberland, Gloucester, Salem and portions of Camden, Burlington and Ocean counties. We focus on providing safe, reliable and affordable electricity to our customers. Atlantic City Electric is proud to be at the forefront of supporting our community and those who protect it by promoting safety and emergency preparedness through our Emergency Services Partnership Program.



Brenner is a family, woman owned small business, serving our War Fighters for over 60 years. With headquarters located in Wallington, NJ, Brenner Metal Products manufacturers field hospital equipment & emergency management products for the U.S. Department of Defense & State & Local Agencies. All Brenner Metal Products are proudly made in the U.S.A.



Dataminr for Public Sector alerts first responders to breaking events, enabling the fastest real-time response. www.dataminr.com/public-sector.



Everbridge, Inc. (NASDAQ: EVBG) provides a Critical Event Management platform to automate and accelerate operational response in order to keep people safe and businesses running faster.



Since 1996, **FDR Hitches** has been selling and servicing the truck equipment industry. We offer only the highest quality products. Some of our brands are United and Carmate Enclosed Trailers, Fisher and Western Plows and Spreaders, Warn Winches, TruckCraft Dump Inserts and Truck bodies. Call us for a quote today.



FEMA

The **Federal Emergency Management Agency (FEMA)** is responsible for leading America's efforts to prepare for, respond to, recover from and mitigate against disasters.

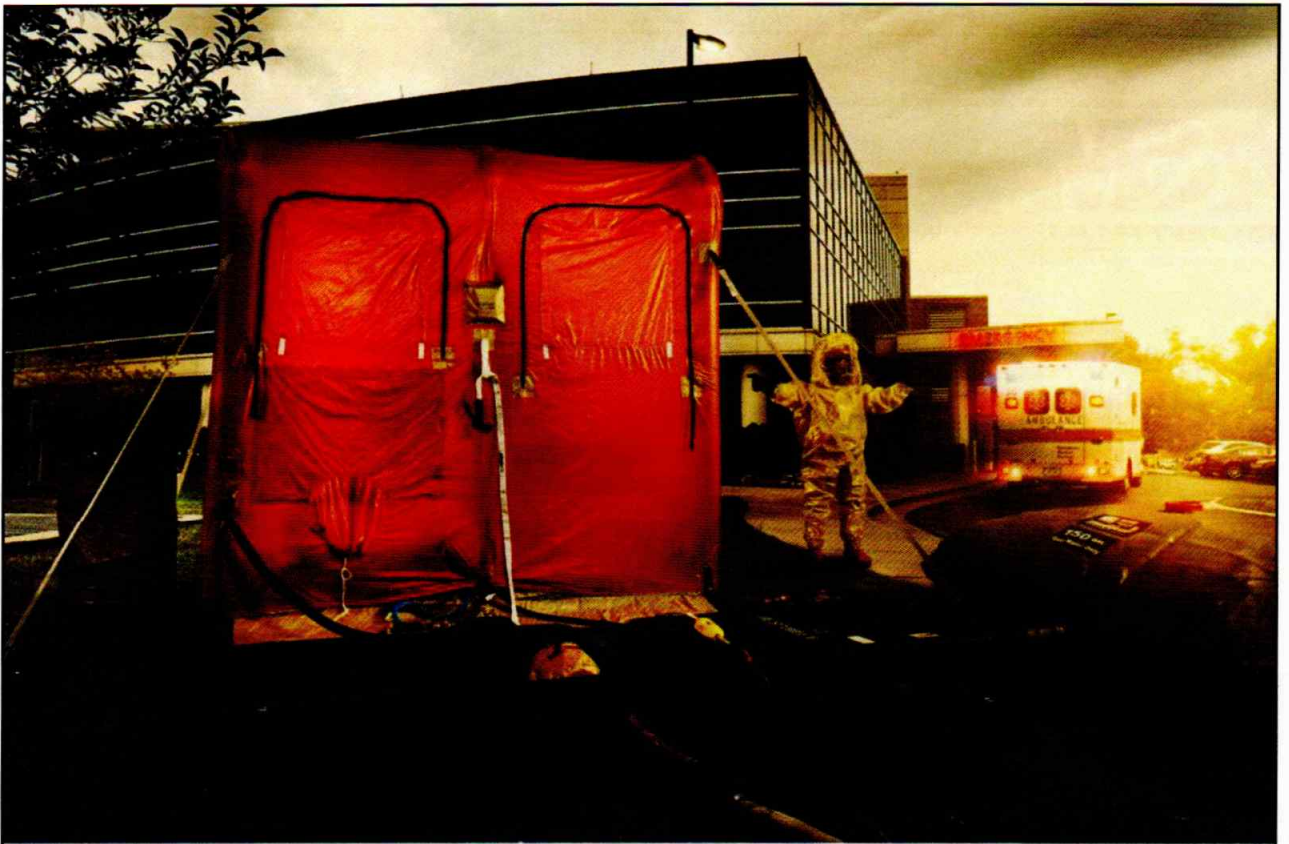

ZODIAC
AEROSPACE



**FIRST RESPONDER
DECONTAMINATION SYSTEM**

The All-In-One Decontamination Solution

Zodiac Aero Evacuation Systems

1747 State Route 34

Wall Township, New Jersey 07727-3935 - USA Tel: 732/681.3527 Fax:

732/280.7492 shelters@zodiacaerospace.com



First Call Environmental provides 24 hour emergency response to environmental incidents from seventeen locations throughout the Eastern United States. Experience the First Call difference 800-646-1290.



FirstNet - The network, devices, applications, and technologies — is a dedicated communications tool created for and by public safety. Together with first responders, we are committed to advancing public safety, making their communications easier, faster and more direct. So, first responders can focus on what's important: working together to save lives.



Gen-el Safety & Industrial Products, LLC is a full line Safety Distributor. For over 20 years we have supplied our customers with quality products at competitive prices. Our complete product knowledge of Hazmat Equipment, Gas Detection Instrumentation, Air Sampling Equipment, Respiratory Protection, and Protective Clothing has made Gen-el one of the premier safety distributors in the New Jersey area. We supply products for Safety & Health, Industrial Hygiene, Environmental, Hazmat, First Response, Weapons of Mass Destruction and Firefighters Protection.



Grainger, Inc., with 2013 sales of \$9.4 billion, is North America's leading broad line supplier of maintenance, repair and operating products, with operations in Asia, Europe and Latin America.



IamResponding is the industry leader for Web and App based dispatch notifications, knowing who is responding and where, mapping, and so much more.



ImageTrend's software solutions help emergency professionals collect and analyze key data, and connects data for fully integrated patient care. ImageTrend is the solution trusted nationwide.



Intermedix delivers technology-enabled preparedness solutions to healthcare providers, government agencies, educational institutions and corporations. As an innovator in the field, the company has supported over 500,000 emergency response incidents worldwide and enables clients to better manage day-to-day disruptions, planned events and unexpected emergencies.



IP Access International is a provider of IP-Based Satellite Services to First Responder Agencies in all 50 states. Our system operates across two Ku Band satellites on each coast with teleport facilities in Maryland and California connected to our 24/7 Network Operations Center in Northern California. We have over 500 U.S. agencies operating over 1,100 satellite systems for Fire, Police, DoD and other First Responder agencies protecting lives and property in each jurisdiction. We operate a specialized VOIP system exclusive to First Responder called the Red Phone system, that is no charge to any First Responder and operates "off the grid" to provide emergency voice communications between all agencies on the network. For nearly 20 years we have operated satellite hub systems in North America and around the world to provide first-class voice, video and data communications to vital services in the pursuit of lifesaving services. Our Select network of IP-Satellite services was operated extensively during the Nor-Easters that struck the Mid-Atlantic to New England states in 2018 with all systems operating over both satellites to provide First Responders with services when all power and networks other than satellite services were down or seriously impaired.



Jersey Central Power & Light - With regional headquarters in Morristown and Holmdel, Jersey Central Power & Light (JCP&L), provides electric service to approximately 1.1 million customers in 13 counties within a nearly 3,200-square-mile area of northern and central New Jersey. JCP&L is a subsidiary of FirstEnergy, a forward-thinking electric utility powered by a diverse team of employees committed to making customers' lives brighter, the environment better and our communities stronger. Follow JCP&L on Twitter, on Facebook or online at www.jcp-l.com.



The NJEMA understands how important your credibility is to your employers, peers and the public you serve. Being a proud member of the NJEMA signifies that you have the experience, education, knowledge and professionalism it takes to handle the responsibilities of your job.

Being a New Jersey Certified Emergency Manager (NJCEM) provides evidence of your education, experience and dedication to your profession and the public you serve.

Become part of the largest emergency management association in New Jersey.

Join the NJEMA and become an NJCEM today.

NEW JERSEY EMERGENCY MANAGEMENT ASSOCIATION

PO BOX 77329

WEST TRENTON, NJ 08628

609-583-0537

www.NJEMA.org

Experience, Education, Knowledge, Professionalism



ON THE LINE FOR YOU.

Whether during an emergency or just a normal day, we're here when you need us. Over the years, it's been our privilege to deliver the energy that has helped make New Jersey a great place for business ... and for living, too. We're proud to serve you and look forward to keeping the future bright with safe, reliable power.



www.jcp-l.com

Jersey Central[®]
Power & Light

A FirstEnergy Company

Joshua Marcus Group



PROMOTIONS

Joshua Marcus Group - Leader in public education safety promotional items, coloring books, awards, drink ware, challenge coins, and much more "we specialize in rush orders" serving our community for over 35 years.



LAURUS Systems Inc., Sales, service, calibration of instruments for radiation detection! New this year, The "Mini rad-V", vehicle mounted radiation detector and the "INSTADOSE" Digital Dosimetry System.



For 18 years **LifeSavers** has supplied first aid and safety products to OEM, Fire, EMS, and Police Departments. Our commitment to you, prompt quality service at competitive pricing.



Mutualink, Inc. provides secure interoperable communications and information sharing solutions for emergency management, first responders, and enterprise, as well as federal agencies. Our IP-based interoperable communications platform enables community-wide multimedia sharing of radio, voice, text, video, data files, and telephone communications in a secure environment. Any media, any device, any network, anytime.



NC4 revolutionizes how organizations collect, manage, share and disseminate intelligence to mitigate risks, manage incidents, and securely communicate and collaborate with one another.



New Jersey Department of Environmental Protection – Bureau of Dam Safety - The Bureau of Dam Safety works to ensure the safety and integrity of dams in New Jersey, thereby protecting people and property from the consequences of dam failure.



New Jersey Division of Fire Safety The mission of the New Jersey Division of Fire Safety shall be to serve as the central focus for the State's fire service community and the general public in all matters relating to fire safety through the development and enforcement of the State Uniform Fire Code, public education programs and firefighter training programs.

The New Jersey Emergency Management Association is led by current emergency management professionals representing many local communities throughout NJ. Our dedicated professionals understand today's challenges and work tirelessly to advance the profession through multi-jurisdictional collaboration, innovative trainings and strategic partnerships with the private sector and non-governmental organizations.



New Jersey Emergency Vehicles - NJEV sells PL Custom Ambulance, Rescue 1, Rosenbauer Fire Apparatus and Malley Ambulance products throughout NJ and services any make of emergency vehicle and fire apparatus.

The New Jersey Office of Emergency Medical Services (OEMS) certifies more than 29,000 Emergency Medical Technician (EMTs) and 1,700 Mobile Intensive Care Paramedics (MICP's) as well as licensing EMS units totaling more than 4,500 vehicles.



Public Service Enterprise Group (PSEG) (NYSE:PEG) is a publicly traded diversified energy company with annual revenues of more than \$11 billion, and three principal subsidiaries: PSEG Power, PSEG Energy Holdings, and Public Service Electric and Gas Company (PSE&G). PSEG Power is a major unregulated independent power producer in the U.S. with three main subsidiaries: PSEG Fossil, PSEG Nuclear, and PSEG Energy Resources and Trade. PSEG Power operates one of the most balanced portfolios in the country, both in terms of fuel mix and market segment. PSE&G is the largest subsidiary of PSEG and one of the largest combined electric and gas companies in the United States, as well as New Jersey's oldest and largest publicly owned utility. PSE&G currently serves nearly three quarters of New Jersey's population in a service area consisting of a 2,600-square-mile diagonal corridor across the state from Bergen to Gloucester Counties.

GSA CONTRACT NOW INCLUDES GENERATORS SIZES
FROM PORTABLE TO TWO MEG!



STATE OF NJ CONTRACT HOLDER

T-NUMBER: T2732 STATE VENDOR NUMBER: 221821514

GSA CONTRACT HOLDER

CONTRACT NUMBER: GS-07F-179CA DUNS NUMBER: 011691573

QUALIFIED SMALL BUSINESS

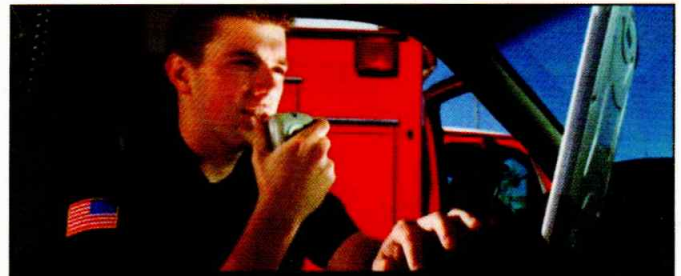

First to respond. First to get through.

With First Priority™, first responders get priority and preemption, for a reliable, highly secure connection. Because no call is more important than the one that saves a life.

Get the facts at FirstNet.com



©2018 AT&T Intellectual Property. All rights reserved. FirstNet and the FirstNet logo are registered trademarks of the First Responder Network Authority.

ADVANCED TECHNOLOGY FOR A SAFER WORLD

RAPID RESPONSE Fentanyl (FYL) Forensic Test Kit



The Rapid Response™ Fentanyl (FYL) Forensic Test Kit is able to detect Fentanyl and many other Fentanyl analogues such as Carfentanil, Acetyl Fentanyl, Butyryl Fentanyl, Remifentanyl, Ocfentanil, Sufentanil, p-Fluoro Fentanyl, Furanyl Fentanyl, Valeryl Fentanyl, and 3-Methyl Fentanyl.



Protecting People, Places and Property

3460 Ellicott Center Drive, Suite 101 | Ellicott City, MD 21043
Ph: 410.465.5558 | Email: Sales@LaurusSystems.com
www.LaurusSystems.com



EMERGENCY READY

A&M Industrial is a full line industrial supplier supporting customers with 24/7 emergency teams who are ready to respond to any operational emergency. The company offers a diverse line of MRO products in Cutting Tools and Abrasives, Safety Products, Material Handling & Storage Equipment and Process Equipment.



(800) 864-2660

www.am-ind.com



The Salvation Army - The Salvation Army's mission is to provide Emergency Disaster Services throughout all of the New Jersey Division utilizing local volunteers, staff, officers and local resources to both survivors and first responders in a timely manner. We will work with other response agencies to help provide physical, emotional and spiritual care at the time of need for as long as the need exists.



Signs and Safety Devices - We have gained the insight to what drives every successful subcontracting and vendor based business. With that being said, we provide 1 stop shopping for all your traffic related products, safety equipment.



VCI Emergency Vehicle Specialists is a one-stop shop for new or used ambulances, ambulance remounts, maintenance, graphics, emergency vehicle parts and full service auto body shop.



V.E. Ralph offers a complete line of emergency medical, mass casualty, and incident command equipment. For over 60 years, we have served public safety providers and emergency management teams in both the public and private sectors. We can source, specify, and deliver a wide range of products for your needs.



The Response Group (TRG) is the industry leader in Crisis Management and Emergency Response with a depth of combined experience in the oil and gas, chemical, and emergency response industries. TRG provides quality products and services with a suite of emergency response software and services from plans to actual response support.



The Verizon Wireless Business Continuity/Disaster Recovery (BC/DR) program focuses on identifying potential risks, implementing preventative measures, and by developing and testing BC/DR plans to reduce the impact of a disruption. Verizon Wireless works to keep our wireless network the Nation's most reliable, so we're ready for any disaster that may affect our customers and communities, and know these ongoing preparations matter. The Verizon Wireless network has been tested time and again when disaster strikes – be it hurricanes, wildfires, tornados or other disaster affecting our communities. We understand the importance of wireless communication in disasters and prepare year-round, so customer can rely on our network to keep them, their families, friends and employees connected – even when the unexpected strikes. By building solid Public / Private partnerships with the Emergency Response community, Verizon Wireless becomes an integral part of planning, response and recovery efforts. The importance of these partnerships can never be overstated and we will continue our efforts, so that our partners know firsthand they can rely on us to keep them connected, as they respond to those who are affected by disaster".



Warshauer Electric Supply, American owned and operated since 1954, has over 60 years of experience as an electrical wholesaler and is currently one of the largest independently owned electrical distributors in the country. We are a full service supply house offering expertise in lighting design, solar energy systems, home automation and security, shading solutions, generator sales/rentals & service, commercial lighting, switchgear and lighting energy audits.



Wireless has earned Motorola Elite Partner status, and consistently delivers innovative solutions to connect Government Agencies with mission critical information in the moments that matter.



The right technology to respond faster

Verizon helps provide innovative advanced communication solutions that facilitate interoperability, so your department can exchange critical information with other public safety agencies and organizations and access the data they need, when they need it.

Event Details

Visit Verizon at Booth #325 & #327

Register for our informative breakout session, "**Verizon Wireless: Emergency Response Capability & Preparedness**"

- Wednesday, May 3rd
- 1:00-2:15pm

Verizon Solutions for Public Safety

- Interoperability
- Disaster Recovery
- Telematics
- Monitoring & Control
- Mobile Public Safety

Start making a difference for your department.
Visit: http://aboutus.verizonwireless.com/Business_Continuity/Overview.html

With a suite of public safety solutions and the security and reliability of America's largest 4G LTE network, Verizon helps your department serve and protect more effectively than ever before.

verizon[✓]