

18th Annual
New Jersey
Emergency Preparedness Conference
2 0 1 6

May 2 - 6, 2016
Tropicana Casino Resort • Atlantic City, NJ

CHARTER SPONSORS

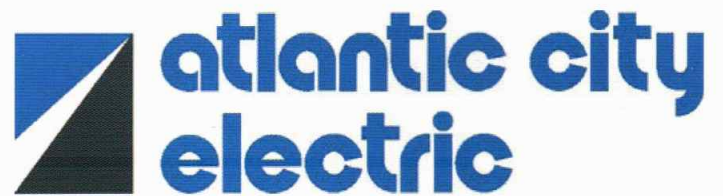

A PHI Company



PSE&G



MAJOR SPONSORS

Jersey Central
Power & Light

A FirstEnergy Company



WITT | O'BRIEN'S

SPONSORS



THE NEW JERSEY EMERGENCY PREPAREDNESS ASSOCIATION

BOARD OF DIRECTORS & TRUSTEES:

Mike Bailey
President
County of Cape May OEM

Pat Goelz
Secretary

Matthew Steintal
Trustee
Galloway Twsp. Ambulance Squad

Todd Beibel
Trustee
Verizon

John Hamilton
Trustee
Mount Laurel EMS

Bill Stevenson
Vice President
WF Stevenson Consulting LLC

David S. Burgin
Trustee
PSE&G Nuclear

Anthony Hurley
Trustee
JCP&L

Carlos Torres
Trustee
Con Edison

Ed Conover
Vice President
Atlantic County Emergency Management

Barry Kraus
Treasurer

Michael J. Ward
Trustee
South Hackensack OEM

Lauren Di Giovanni
Executive Director
AtlantiCare

Paul Malool
Trustee
US Department of Veterans Affairs

Michael Weber
Trustee
PSE&G

Ed Forte
Trustee
PSE&G

Anthony Mangeri
Trustee
American Military University

Phyllis Worrell
Trustee
Virtua

Nicholas Scalise
Trustee
AtlantiCare

PRIMARY CONFERENCE COMMITTEE (in addition to the Board of Directors & Trustees):

Wayne DeBiasio
Springfield Public Schools

Sgt. Vince Jackson
NJSP

Gary Szatkowski
National Weather Service

CONFERENCE SUB-COMMITTEE MEMBERS:

COMMITTEE: MANAGEMENT

Chair: Ed Conover • Atlantic County Emergency Management
Comm. members: Mike Bailey • County of Cape May OEM
Pat Goelz
John Hamilton • Mount Laurel EMS
Paul Malool • US Department of Veterans Affairs
Bill Stevenson • WF Stevenson Consulting LLC

COMMITTEE: REGISTRATION

Chair: Lauren Di Giovanni • AtlantiCare
Co-chairs: Megan Petitt-Kraus
Karen Richardson
Shelbie Fahy

COMMITTEE: SCHOLARSHIP

Chair: Ed Forte • PSE&G
Comm. members: Dave Burgin • PSE&G Nuclear
Matt Steintal • Galloway Twsp. Ambulance Squad

COMMITTEE: SPONSORS / EXHIBITORS

Chair: Lauren Di Giovanni • AtlantiCare
Co-chairs: Ed Conover • Atlantic County Emergency Management
Comm. members: Dave Burgin • PSE&G Nuclear

Thanks to NOAA and FEMA for the use of their online photo library.

CONFERENCE SUB-COMMITTEE MEMBERS (continued):

COMMITTEE: KEYNOTE & SPECIAL EVENTS

Chair: Ed Forte • PSE&G

COMMITTEE: VOLUNTEERS

Chair: Michael Ward • South Hackensack OEM
Comm. members: Robert Haffner
Richard Sadowski

COMMITTEE: LOGISTICS

Chairs: Jim Petitt
Comm. members: Abby Kraus
Jamie Van Pelt
Andrew Talyor

COMMITTEE: MARKETING / PUBLIC RELATIONS

Chair: Anthony Mangeri • American Military University
Comm. members: Denise Spell • Currant

COMMITTEE: IT & COMMUNICATIONS

Chair: Ed Velez
Co-chair: Wayne DeBiasio • Springfield Public Schools
Comm. members: Beth Cristillo
Bill Szemcsak • Cape May FD
Mark Tonkery • NJSP

COMMITTEE: WAYS & MEANS

Dave Burgin
Ed Forte
Anthony Mangeri
Mike Weber

COMMITTEE: TRAINING

Chair: John Hamilton • Mount Laurel EMS
Co-chair: Mike Augustyniak • NJSP OEM
Comm. members: Karen Fox Pawlak
Steve Pawlak
Anthony Mangeri
William Kelleher
Debra Bell
Larry Rosenberg
Vince Jackson
James McFadden
Michael Urbanski
Mike Weber

COMMITTEE: BREAKOUT SESSIONS

Chair: Pat Goelz
Co-chair: Karen Fox Pawlak
Comm. members: Kim Bell
Ed Conover
Holly Cucuzzella
Vince Jackson
Jim Manski
Nicholas Scalise
Gary Szatkowski
Phyllis Worrell

COMMITTEE: FRIDAY EQUIPMENT DEMO

Mike Bailey
Scott Grilli
Scott Ramage

MANY THANKS

to the dedicated volunteers that make the New Jersey Emergency Preparedness Conference possible.

VOLUNTEERS (at the time of printing):

Kate Adams • Atlantic County Division of Public Health
George Arnot • Sussex County Sheriff's Office OEM
Jordon Bisconti • Mt. Ephraim OEM
Amit Blumfield • American Red Cross
Bob Cassiello • Lodi OEM
Tabitha Champeau • American Red Cross
Shelly Ditmar • Monroe Township OEM
Helene Dougan • Middlesex County OEM
Barbara Forsberg • Manchester CERT
Debra Garbrecht • Mt. Ephraim OEM
Brett Geiger
Thomas Gorman • Camden County RACES
Frances Gorman • State of Maryland
Robert Haffner • Hopatcong Police Dept. OEM
Ryan Hammell • Mt. Olive Twp. OEM
Dr. Jeffrey Issler • Montclair State College
Walter Kain • Aberdeen Matawan CERT

Joel Kerwin • Readington Township OEM
Frank McLaughlin • Monroe Township OEM
Nicole Marks • American Red Cross
Criag Martin • Mutualink
Medical Reserve Corp • Volunteers
Robert Myers • Middle Twp. CERT
Maria O'Reilly • Paramus Ambulance Corp
Alfred Piombino • Certified Emergency Manager
Richard Sadowski • Hopatcong Police Dept.
Don Scala • Berkley Township Underwater Search/Rescue
Steve Sharp
Cathy Unrichin • New Jersey Emergency Management Association
Robert VanFossen • DEP
Mark Vogel • Sussex County Sheriff
Charles Warrington • Clementon OEM
Fred Weikel • Monroe Township OEM
Phil Wilk • Mine Hill OEM

**Our appologies if we have left any names off the volunteer list. Many thanks for your hard work and dedication.*

BREAKOUT SESSION SCHEDULE

Wednesday, May 4

7:00 - 9:00 Continental Breakfast

7:00 - 7:00 Registration

10:30 - 11:45 Breakout Session 1

1. Drug Recognition for the First Responder **AH Castanet 2**
2. Defense Support to Civil Authorities **DP Mambo 2**
3. Preparing Your Supply Chain for the Unthinkable **P Castanet 4**
4. Family Reunification Center **R&R Bongo 1**
5. Verizon Wireless **SP Bongo 1**
6. The Latest on Hazardous Weather Communications **W Bossa Nova 2/3**

12:00 - 1:00 Lunch on your own

1:00 - 2:15 Breakout Session 2

1. Overnight Shelter Exercise, "Everyone's" Included **AH Bongo**
2. EMA and Law Enforcement Guide to Missing Person Search Incidents **DP Castanet 2**
3. Three Ways to Reinvent Your Continuity of Operations Program Utilizing Technology **H Mambo 2**
4. Crew Resource Management for Emergency Management **P Mambo 3/4**
5. Partnership, is the Statewide 24/7 Help and Referrel Call Center **R&R Castanet 4**
6. Developing a Coastal Storm Severity Index **W Bossa Nova 2/3**

3:00 - 4:30 Keynote Session: Derrick J.V. Sawyer, Fire Commissioner Philadelphia Fire Department / Showroom

Thursday, May 5

7:00 - 9:30 Dedicated Exhibit Hall Time

7:00 - 9:00 Continental Breakfast

9:30 - 10:45 Breakout Session 3

1. GIS - Mapping the All-around Tool **AH Bongo**
2. Papal Visit-State Viewpoint **DP Castanet 1/2**
3. Autism 911-Facts and Tips for Working with Someone on the Spectrum **H Mambo 1/2**
4. Geospatial Intelligence and Its Uses in Government and Private Sector Emergency Management **P Bossa Nova**
5. Safety for You, Safety for Others **R&R Castanet 3/4**
6. Overview of Record Breaking Rain and Floods in South Carolina-October 2015 **W Mambo 3/4**

11:00 - 12:15 Breakout Session 4

1. Social Media: It's Not Just for Kids **AH Mambo 1/2**
2. Care, Feeding and Training of a CERT **DP Bongo**
3. The Pope is Coming, The Pope is Coming! **H Mambo 3/4**
4. Policy Development-Why Do We Need to Do That? **P Castanet 3/4**
5. Addressing Addiction Issues in Community Crisis **R&R Bossa Nova**
6. The Impact of the June 23rd, 2015 Bow Echo Storm on Utility Infrastructure **W Castanet 1/2**

11:45 - 1:15 Lunch / Salon

1:30 - 2:45 Breakout Session 5

1. The AAR, What Happens if We Tell the Truth? **AH Mambo 1/2**
2. Uncovering a Black Market WMD Network **DP Bongo**
3. First Responder Suicide **H Bossa Nova**
4. Providing Effective Fire & Emergency Services to Diverse Populations: A Holistic Collaborative Approach **P Castanet 3/4**
5. Emergency Management and the 2015 Baltimore Protests **R&R Castanet 1/2**
6. Beach Weather Forecasts, Research and Preparednes **W Mambo 3/4**

| | |
|----------------|-----------------------|
| AH | All Hazards |
| DP | Domestic Preparedness |
| H | Health |
| P | Policy and Planning |
| R&R | Response and Recovery |
| SP | Sponsor Presentation |
| W | Weather |

BREAKOUT SESSION SCHEDULE

3:00 - 4:15

Breakout Session 6

1. Navigating the Labyrinth of Hoarding **AH Mambo 3/4**
2. The Papal Visit-The County Viewpoint **DP Castanet 1/2**
3. What's Your Electric Company Doing All Year? **H Bongo**
4. America in Protest: Emergency Planning & Legal Implications in a Revolting Society **P Bossa Nova**
5. 2014 Ice Storm Response & Recovery **R&R Mambo 1/2**
6. A Review of the late January 2016 Blizzard and Record Coastal Flooding Event **W Castanet 3/4**

Friday, May 6

9:00 -10:15

Breakout Session 7

1. Utilizing the Medical Reserve Corps to Support National Special Security Events: a Multi-jurisdictional Deployment in Response to the Papal Visit **DP Bossa Nova**
2. Not Your Father's M*A*S*H*-Establishing Alternative Medical Treatment Sites **H Mambo 3/4**
3. Building Your Team – Effective Local Hazard Mitigation Planning **P Mambo 1/2**
4. Marshalling Non-Profits & Community Resources in Response & Recovery **R&R Castanet 3/4**
5. Port Authority Regional Flood Alert System: A Resource for the Emergency Manager **W Castanet 1/2**

10:30 -11:45

Breakout Session 8

1. What to Expect at a Natural Gas Incident and NJ One Call (811) **AH Castanet 3/4**
2. Planning and Preparing your County Shelter **DP Tambora**
3. Burlington County CERT/MRC Deployment-Papal Visit **P Castanet 1/2**
4. Using Storm Outage Modeling to Inform Emergency Preparedness at Electric Distribution Networks **R&R Bossa Nova**

SCHEDULE AT A GLANCE

Monday, May 2

- 7:00 - 9:00 Continental Breakfast in Ballroom Foyer, Pageant Foyer, and Mambo Foyer
- 7:00 - 2:00 Registration desk is open
- 8:00 - 5:00 Training sessions
- 12:00 - 1:00 Lunch on your own

Tuesday, May 3

- 7:00 - 9:00 Continental Breakfast in Ballroom Foyer, Pageant Foyer, and Mambo Foyer
- 7:00 - 2:00 Registration desk is open
- 8:00 - 5:00 Training sessions
- 12:00 - 1:00 Lunch on your own

Wednesday, May 4

- 7:00 - 9:00 Continental Breakfast Pageant Foyer and Mambo Foyer
- 7:00 - 7:00 Registration desk is open
- 8:00 - 5:00 Training Sessions
- 8:00 - 4:30 Exhibitor Set-Up
- 10:30 - 11:45 Breakout session #1
- 12:00 - 1:00 Lunch on your own
- 1:00 - 2:15 Breakout session #2
- 3:00 - 4:30 Keynote session in the Showroom
- 4:30 - 7:30 Exhibit hall opening and reception

Thursday, May 5

- 7:00 - 9:30 Dedicated exhibit time
Continental Breakfast in the GEC, 4th Floor, South Tower
- 9:30 - 3:00 Exhibit hall open during breakouts and lunch
- 9:30 - 10:45 Breakout session #3
- 11:00 - 12:15 Breakout session #4
- 11:45 - 1:15 Lunch provided - Salon Ballroom, North Tower
- 1:30 - 2:45 Breakout session #5
- 3:00 - 4:15 Breakout session #6
- 6:00 - 8:00 Reception (Salon 2/3)

Friday, May 6

- 7:00 - 9:00 Continental Breakfast in the GEC
- 9:00 - 10:15 Breakout session #7
- 10:30-11:45 Breakout session #8

HISTORY OF THE NJEPA

The New Jersey Emergency Preparedness Conference had its humble beginnings as a "grass roots". It started as a conversation at Atlantic County OEM looking for a way to provide higher level training and experiences to local emergency managers. County and State personnel had the opportunity, back then, to attend state, regional and national conferences and the Atlantic County and South Region OEM teams were brainstorming ways to bring this kind of information to local EMCs and their teams at no cost. With the tremendous support of the Tropicana Casino Resort and Verizon the Atlantic County Hurricane Seminar was born.

This first effort presented eight speakers on various topics related to coastal preparedness issues for hurricanes. The one-day seminar was well received by the approximately 200 people in attendance and they requested expanding the program for the following year.

In 2000 we expanded to a 2 day seminar adding a larger program of speakers which required us to recruit more sponsors to fund the popular program which was presented at no charge to attendees.

Expanding the conference would present a number of challenges including increased participation by our host the Tropicana Hotel Casino and the Atlantic County OEM, NJ State Police OEM, sponsors Verizon, State Farm and those behind the scenes people that made the simple seminar a huge success. Several of the local, county, and state emergency management officials had

attended the very popular National Hurricane Conference for many years. A small group of them wanted to try and create a conference similar but unlike our friends at the NHC.

The 2001 NJ Hurricane Preparedness Conference would be different. It would feature 18 one hour breakout sessions, 2 continental breakfast, 2 sponsored lunches, and an exhibit area for 2 days with 32 exhibitors. This was a logistical and financial nightmare tackled by a handful of very dedicated emergency preparedness professionals. Due to unwavering dedication of a select group of people using creative and out of the box solutions the nearly \$60,000 conference came off very successfully with over 600 attendees.

At the after conference meeting the small group decided that we needed to invest the time and effort to continue our successes by forming the New Jersey Emergency Preparedness Association. This required a strong commitment and backing of our sponsors and partners who were behind us all the way and one current event in world history would be the rocket fuel to the creation of the New Jersey Emergency Preparedness Association and the New Jersey Emergency Preparedness Conference.

That date September 11, 2001.

Edward Conover, Founding President
William Melfi, Founding Vice President



WELCOME LETTER

Dear 2016 NJEPA Conference Attendee,

The NJEPA welcomes you to the 18th annual New Jersey Emergency Preparedness Conference. For those new to the conference, we are honored to have you aboard, and hope you take full advantage of the great training and breakout sessions we have put together for you this year.

This year we are honored to have Fire Commissioner Derrick J. V. Sawyer of the Philadelphia Fire Department with us as our keynote speaker. Commissioner Sawyer's years of experience responding to large scale emergencies and disasters as well as his vast emergency planning experience will make for a very exciting presentation during the Opening Ceremony on Wednesday afternoon.

Once again, we have numerous displays and vendors in our exhibit hall. Be sure to visit the exhibit hall Wednesday, after the opening ceremony for some refreshments and the chance to meet with our sponsors, and vendors. Please take the opportunity to meet with these individuals and organizations. Their services and equipment will add greatly to your emergency preparedness program. Again this year, we will have an outdoor display and live demonstrations on Friday afternoon at Bader Field. There will be several large vehicles on display along with specialty vehicles from the State Police and the New Jersey EMS Task Force. Lunch will be provided by the Salvation Army and the New Jersey Emergency Preparedness Association. Please stop by on your way home and walk around the exhibits and enjoy a light lunch.

We trust you will enjoy this year's conference. If at any time you have questions or comments, we welcome your input. Look for us, we are on the conference floor and available at all times to assist you. Finally, no conference would be successful without the input and support from our emergency management community. Thank you and enjoy YOUR 2016 New Jersey Emergency Preparedness Conference.

The New Jersey Emergency Preparedness Association would also like to thank a few people who have helped get the organization where it is today:

Mike Augustynick
Mike Bailey
Mike Bradeis
Michael Caffrey*

Ed Conover*
James Eberwine
Pat Goelz
James Manski

George Martin
Nick Mazza
Bill Melfi*
Glenn Nickerson

Gary Szatkowski
Eileen Unger
Jon Young*

*Denotes past President



IN MEMORIAM

In Honor of Kevin H. Tuno

Kevin H. Tuno, 56, of Burlington City, New Jersey, died Tuesday, Sept. 15, 2015, at his residence in Burlington City surrounded by his loving family. Born in Philadelphia, Kevin was a lifelong Burlington resident. He was the Burlington County Emergency Management Coordinator for the past 17 years, culminating a career with Burlington County that began as an emergency services dispatcher in 1982.

Kevin was also a former chief of the Burlington City Fire Department, a life member of the Young America Fire Co., and Endeavor Emergency Squad, and a member of the Independent Fire Company, all in Burlington. He was also a member of the NJ Preparedness Association.

Burlington County Freeholder Director Mary Ann O'Brien shared the news of Kevin's passing on the Burlington County Government Facebook page with a note about his legacy. "The entire Burlington County community is deeply saddened by the passing of our longtime emergency management coordinator Kevin Tuno. Kevin led the county's response during trying times, including through the Sept. 11 terrorist attacks, the devastating July 2004 flood, and Superstorm Sandy. He will be truly missed," she said.

Kevin had over 30 years of experience in emergency management and disaster response. As the emergency management coordinator, Kevin was instrumental in the formation of the Burlington County Community Emergency Response Teams (CERT). Kevin received a master's degree in administrative science, the Certified Public Manager designation from the state of New Jersey, he was a master exercise practitioner and an adjunct professor at Burlington County College. In his spare time, Kevin enjoyed playing the drums, was an avid music lover and enjoyed photography, and was a favorite uncle to all his nieces and nephews.

Barry E. Eck, president of the New Jersey Emergency Management Association, said in a statement: "Kevin was a talented and dedicated emergency management coordinator who loved his work. His experience and wisdom provided foresight with balance to the otherwise chaotic world of emergency management."

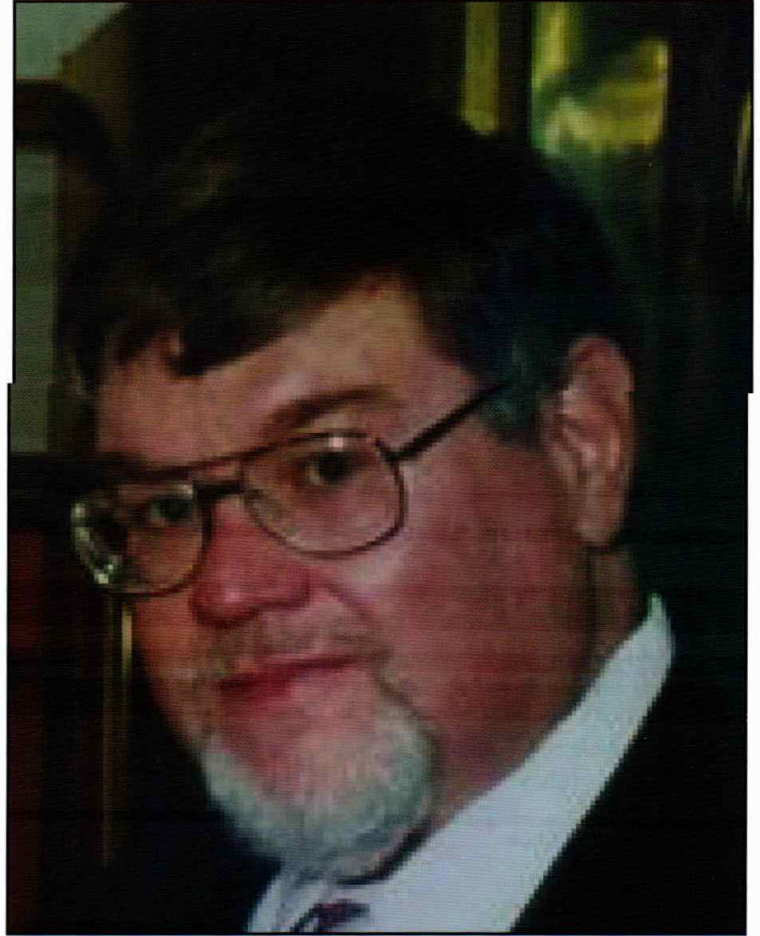

Derrick J.V. Sawyer **Fire Commissioner** **Philadelphia Fire Department**



Serving as Fire Commissioner of the Philadelphia Fire Department (PFD), Derrick Sawyer is a 30 year veteran who heads the 5th largest fire and emergency services department in the country. Since entering the PFD in 1985, Fire Commissioner Sawyer has developed in-depth experience as a first-responder amidst an urban landscape that demands diversity in skill, critical training, and keen analytical decision making. Over 2100 members are under his command.

With a passion for educating the community on the merits of safety preparedness, he has become a sought after public speaker and revels in the challenge at hand. Over the past decade Fire Commissioner Sawyer has traveled the globe to educate diverse communities on the effectiveness of Community Risk Reduction, prevention and fire & life safety measures. Among his most impactful presentations were the 2011 International Safety Seminar in Seoul Korea and the National Fire Protection Association's Annual Conference. He led the award winning Prevention division in both the Deputy and Battalion Chief capacity and as a result of his hands on leadership style, assisted the Department in reducing the number of fire fatalities in the City of Philadelphia to its lowest rate in recorded history. Fire Commissioner Sawyer was the 2011 recipient of the T. Seddon Duke Award for Fire Prevention.

In addition to serving in some of the busiest companies in the city, Fire Commissioner Sawyer has served in every rank of civil service as well as held the positions of Deputy Commissioner for both Technical Services and Operations. He's served in staff positions in the Technical Support Unit, headed the Department's Homeland Security Division and has presented at the 9th Annual Montgomery County Chief Officers Seminar on the importance of information sharing as it relates to preparing for and preventing terrorist attacks.



He also represents the Philadelphia Fire Department on the National Fire Protection Association's (NFPA) Urban Fire Safety Taskforce and serves on the NFPA technical committee 1730, Deployment and Staffing for Fire Prevention Activities, 1300 Standard for Community Risk Reduction (CRR) Plans, and 1452 Guide for Training Fire Service Personnel to Conduct Community Risk Reduction.

Fire Commissioner Sawyer has augmented his academic accomplishments by graduating from the National Fire Academy's Executive Fire Officer Program, the Carl Holmes Executive Development Institute and obtaining certifications as Fire Officer IV, Fire Instructor II, Fire Inspector, Hazardous Material Technician, and Firefighter II. He holds an Associate Degree in Fire Science from Community College of Philadelphia, a Bachelor of Arts Degree in Public Safety Administration from Holy Family University and a Masters Degree in Homeland Security from Saint Joseph's University.

BREAKOUT SESSIONS

May 4 WEDNESDAY • 10:30 - 11:45 • Breakout Session 1

Drug Recognition for the First Responder - Nick Costagliola and Mitch Remig / AH *Castanet 2* This presentation is designed for EMS and other first responders responsible for assessment and transport of patients presenting signs of possible substance abuse. The audience will learn the major drug categories which are commonly abused. Along with being able to recognize what the drugs and paraphernalia look like; participants will learn the signs and symptoms associated with the specific drug categories. Topics including law enforcement and public administration of Narcan, Excited Delirium and a legal review of restraining combative patients are also covered.

Defense Support to Civil Authorities - Scott Heintzelman, US Army / DP *Mambo 2* Presentation will cover the Department of Defenses (DoD) role in supporting natural and man-made disasters in Region II. The presentation will also focus on DoDs Chemical Biological Radiological and Nuclear Enterprise Response Force or DCRF.

Preparing Your Supply Chain for the Unthinkable Patrick Hurley, S6RG / P *Castanet 4* Presentation will cover: Identify and classify critical dependencies and risks in local, regional, national and global supply chains utilizing "All Hazards" risk assessment; Establish effective crisis management policies, procedures and controls to identify and manage supply chain risks; How to work with local first responders throughout the supply and integrate them into planning.

Family Reunification Center- Christina DePaolantonio, Chester County Dept. of Emergency Services, PA / R&R *Bongo 1* Do you know your involvement? As a consequence of emergencies and disasters, family reunification becomes one of the most challenging events to plan for, implement, and accomplish. Family reunification is a process to reunite children with their parents/guardians after an emergency or crisis has occurred. The Chester County Department of Emergency Services collaborated with several response agencies within the County to develop a guidance document. This document outlines the process and procedures to identify county-wide reunification sites, floor plans within those reunification sites, instructions on deployment of the Reunification Team, and resources needed to set-up a reunification site.

Verizon Wireless - Todd Biebel, Verizon Wireless / SP *Bongo 1* The Verizon Wireless Business Continuity/Disaster Recovery (BC/DR) program focuses on identifying potential risks, implementing preventative measures, and by developing and testing BC/DR plans to reduce the impact of a disruption. Verizon Wireless works to keep our wireless network the Nation's most reliable, so we're ready for any disaster that may affect our customers and communities, and know these ongoing preparations matter. The Verizon Wireless network has been tested time and again when disaster strikes – be it hurricanes, wildfires, tornados or other disaster affecting our communities. We understand the importance of wireless communication in disasters and prepare year-round, so customer can rely on our network to keep them, their families, friends and employees connected – even when the unexpected strikes. By

building solid Public / Private partnerships with the Emergency Response community, Verizon Wireless becomes an integral part of planning, response and recovery efforts. The importance of these partnerships can never be overstated and we will continue our efforts, so that our partners know firsthand they can rely on us to keep them connected, as they respond to those who are affected by disaster.

The Latest on Hazardous Weather Communications - Gary Conte and Nancy Furbush, National Weather Service / W *Bossa Nova 2/3* Most outlooks, all watches, warnings, and advisories for hazardous weather issued by your local NWS Weather Forecast Offices (WFO) are text based. As you know, most communication is visual – it is what you "see." Text is still needed to supplement graphics for more accurate interpretation. Our goal is to change the outcome of people's actions to save more lives. Session will discuss plans to improve communicating hazards and their impacts with the enhanced graphical Hazardous Weather Outlook by scanning potential impacts from specific hazards using color coded risk levels.

May 4 WEDNESDAY • 1:00 - 2:15 • Breakout Session 2

Overnight Shelter Exercise, "Everyone's" Included - Madeleine Goldfarb- Noah's Ark Institute, Carole Tonks / AH *Bongo 1/2* Alliance Center for Independence and John Ferguson-Middlesex County OEM The overnight shelter exercise "everyone's" included presentation will give the participants the tools to work within their own communities so they will be able to execute their own shelter exercise. The exercise brings together all community stakeholders to participate in a full scale overnight experience. It is essential to bring together first responders and the disability community as equal partners. By doing so, barriers are removed and each community can learn from the other. Preparing first responders and people with disabilities for the next disaster together will save lives.

EMA and Law Enforcement Guide to Missing Person Search Incidents - John Boburchuk, Bedford County (PA) Wilderness Search Team / DP *Castanet 2* Dealing with Missing Person Incidents can be one of the most confusing emergencies that EMA personnel and Law Enforcement agents have to deal with. This presentation will look at missing person incidents from a management perspective and address what EMA and Law Enforcement need to be concerned about. Topic that will be discussed are Missing Person Search Overview, Determining Search Emergency, Gathering pertinent Search information, Lost Person Behavior, Urban Missing Person Search concerns and SAR Resource overview.

Three Ways to Reinvent Your Continuity of Operations Program Utilizing Technology - Joseph Martino, North Shore-Long Island Jewish Health Systems / H *Mambo 2* There is a gap in employee resilience programs that incorporate bidirectional communications technology. Studies now show that employees are looking for information more than ever regarding disasters secondary to the influx of mobile technology; continuity of operations programs geared towards resiliency need to incorporate creativity, technology, and situational awareness and then inform employees accordingly. A

re-evaluation of the under-utilization of technology is long overdue; programs need to engage the technology savvy workforce.

Crew Resource Management for Emergency Management

- **Peter Dworsky, MONOC / P** *Mambo 3/4* Crew Resource Management is a leadership tool that is used to improve team performance and reduce the effects of human error. This presentation will focus on the skills and techniques used to enable Emergency Managers to utilize all available resources to promote an optimal outcome.

Partnership, is the Statewide 24/7 Help and Referral Call Center

- **Joe Geleta, NJ211 / R&R** *Castanet 4* By simply calling 2-1-1 individuals and families can be connected to those critical health or human service resources to aid them in their time of need. NJ211 works closely with NJOEM during disaster response and serves as a valuable public messaging and resource organization.

Developing a Coastal Storm Severity Index - David Robinson, Rutgers / W

Bossa Nova 2/3 Given the multiple ways in which storms have pummeled the region in recent years, there is the need for a coastal storm severity index that will best define the hazards associated with tropical systems and nor'easters that threaten the coast and adjacent inland regions. Such a tool can be used to convey the threat level for individual components that comprise these storms (e.g. surge, precipitation, wind), and thus the potential overall impact of these severe events. This session will introduce attendees to the development stage of the index and seek feedback on its characteristics and distribution from local, county, and state emergency management entities.

May 5 THURSDAY • 9:30 - 10:45 • Breakout Session 3

GIS - Mapping the All-around Tool - Dave Rickerct, Burlington County / AH

Bongo The breakout will touch on the four steps of emergency management - Preparedness, Response, Recovery and Mitigation, showing how GIS maps can be used efficiently in each stage to help you see the whole picture. The presentation focus will touch on how Burlington County OEM uses GIS on the ESRI platform as an all-around tool to aid in the decision making process at all four stages. It will also show how the uses of maps are very helpful in the progression of an incident.

Papal Visit-State Viewpoint - Marc Pellegrino - NJSP / DP

Castanet 1/2 The World Meeting of Families was a family oriented event that is held every three years in chosen cities around the world and was sponsored by the Vatican's Pontifical Council for the Family; the World Meeting of Families is the world's largest Catholic gathering of families. This event was scheduled to occur on September 25-27, 2015 in Philadelphia, PA with an expected attendance of up to 2-million participants (three times as many as the last Papal visit), 10,000 delegates, 7,000 credentialed media, 100 dignitaries and Pope Francis himself. The State of New Jersey planned and prepared for the event as it faced the primary challenges of supporting an influx of 1-2 million people, as well as the associated mass care requirements, traffic flow issues, and traffic congestion. The New Jersey State Police was designated as the lead State representative to integrate and coordinate State efforts with Federal and local key jurisdictions and stakeholders. This breakout session will be a presentation regarding the State's planning and preparation efforts. The speakers will include the Incident Commanders, Section Chiefs, and key stakeholder representatives.

Autism 911-Facts and Tips for Working with Someone on the Spectrum - Michelle DeMarsh / H

Mambo 1/2 PA Autism Action Center Autism 911 introduces the basics of autism, reactions that someone on the spectrum might give in an emergency, and suggestions of various strategies to use at these times. Michelle also allows time for questions and encourages participants to ask about experiences they already encountered.

Geospatial Intelligence and Its Uses in Government and Private Sector Emergency Management - Keith J. Masback, CEO United States Geospatial Intelligence Foundation / P

Bossa Nova This session will educate the audience on the background and current uses of geospatial technology and how such current technology may assist government and private sector emergency managers in their planning and response activities.

Safety for You, Safety for Others - Joseph Napoli, Resiliency

R&R Castanet 3/4 When disasters strike, people become distressed and frightened. Some resist rescue workers' efforts to evacuate them. Shelter living can be frustrating and involve interpersonal conflicts. Frustration can provoke anger. Fear and anger can lead to agitation, and even violence. Emergency personnel need to know how to behave to protect themselves and others while intervening to calm an agitated person and deescalate rather than inflame a potentially violent situation? Participants will engage in an active collaboration experiential learning exercise using a movie and group breakouts to learn the do's and don'ts of safely interacting with an agitated person.

Overview of Record Breaking Rain and Floods in South Carolina-October 2015 - Joe Miketta, National Weather Service

W Mambo 3/4 One to two feet of rain over parts of North and South Carolina in October 2015 produced record flooding on many streams and rivers in the southeast. Dam breaks and tidal issues exacerbated the flooding problems and added to public confusion. This presentation will discuss the meteorology and hydrology behind this event, and the public response to accurate forecasts from the NWS.

May 5 THURSDAY • 11:00 - 12:15 • Breakout Session 4

Social Media: It's Not Just for Kids - Laura Connelly- NJOEM, Nicole Mulvaney - NJDOH and Thomas Slater-NJDOH / AH

Mambo 1/2 Social Media is a key component in preparedness, it has become a popular medium with younger adults but more important, it has become a way to communicate and create public awareness for emergency situations. NJ Department of Health staff will describe how they have used various social media platforms to prepare for and respond to emergencies and events.

Care, Feeding and Training of a CERT - William Lowe, Township of Tabernacle, NJ and John Lyons, CERT / DP

Bongo Director Community Emergency Response Teams are groups of citizen volunteer trained to assist first responders in an emergency situation. This presentation will discuss the recruiting and training of a CERT as well as the use and continued motivation and retention of members. Discussion will include the role of ICS, non-emergent use of the team and team leadership and innovation.

The Pope is Coming, The Pope is Coming! - Len Clark-Tenet

Health / H Mambo 3/4 At the end of September, 2015, Pope Francis visited Philadelphia as part of the World Meeting of

Families. With anticipated crowd of up to 5 million visitors, this was touted as the largest event ever in the US. Without a clear understanding of the demands for hosting this many people, the healthcare assets recognized the potential for a crisis. Planning efforts lasted over 6 months and required almost all of the staff departments. This presentation examines the role of healthcare during this event.

Policy Development-Why Do We Need to Do That? - Derrick Jacobus, Monroe Township PD, NJ / P *Castanet 3/4* The activity of developing policy generally involves research, analysis, consultation and synthesis of information to produce recommendations. It should also involve an evaluation of options against a set of criteria used to assess each option. The model presented in this program can be used in any concentration, public or private. Provided to numerous audiences in EMS and Law Enforcement, Emergency Management professionals can benefit equally from solid, legally sound policies.

Addressing Addiction Issues in Community Crisis - Megan Sullivan, DHSNJ / R&R *Bossa Nova* This workshop will educate participants on the prevalence of substance use disorders in New Jersey and the issues that arise for this population following a disaster. Special attention will be paid to the opioid epidemic current in New Jersey. Participants will learn signs and symptoms of drug withdrawal and when medical assistance is indicated. Time will be spent orientating participants to the Guest Emergency Dosing System and the Mobile Medication Distribution Units available in New Jersey that will help First Responders address the needs of this population in communities in crisis to mitigate further need for medical intervention.

The Impact of the June 23rd, 2015 Bow Echo Storm on Utility Infrastructure - Jim Bruncati & Brian Beam, NJ Board of Public Utilities and Andrew Sykes, Atlantic City Electric / W *Castanet 1/2* The Bureau of Emergency Management and Security is responsible for working with the lifeline utility sectors to maintain services to the State of New Jersey. Bureau members are on call 24/7 and respond to utility outages and emergencies by working with utility emergency management personnel to restore critical services. Bureau members also work with the utilities to develop appropriate physical and cyber security best practices for critical infrastructure protection.

May 5 THURSDAY • 1:30 - 2:45 • Breakout Session 5

The AAR, What Happens if We Tell the Truth? - Thomas Calimano, Hackensack UMC / AH *Mambo 1/2* This presentation will discuss the following: – the importance of the after action report – some historical lessons learned that changed the course of history – Gaps identified that were not put into AARs and the same issues arose in the future.

Uncovering a Black Market WMD Network - Scott Nawrocki, FBI / DP *Bongo* In 2013, the FBI Joint Terrorism Task Force, United States Attorney's Office and DEA disrupted a lone New Jersey subject who acquired precursors to manufacture lethal biological toxins, ricin and abrin, as well as other explosive precursor chemicals. This presentation will discuss the aforementioned case study, as well several related international and domestic case studies. The objectives of this presentation will include: 1) Increase first responder awareness of biological toxin

production and dissemination, 2) Improve recognition of biological toxin precursors and 3) Familiarize first responders with the FBI WMD Threat Credibility Evaluation process.

First Responder Suicide / H *Bossa Nova*

Providing Effective Fire and Emergency Services to Diverse Populations: A Holistic Collaborative Approach - Michael Allora, Clifton FD, NJ / P *Castanet 3/4* The population of the U.S. and N.J. is becoming increasingly diverse. Our multicultural communities have multiple needs and challenges. Fire and Emergency services deliver all-hazard services for incidents including fires, medical emergencies, and natural and man-made disasters. The challenges associated with emergency incidents can be compounded by a lack of awareness of and preparedness for the specific challenges associated with the needs of diverse populations. Effective community risk reduction programs should take into account the specific and individual needs of diverse communities, including social, cultural, religious, and behavioral needs.

Emergency Management and the 2015 Baltimore Protests - Brendan McCluskey, NJDOH / R&R *Castanet 1/2* This presentation will discuss the emergency management aspects of the 2015 Baltimore Protests, including preparedness and capability-building, response and recovery missions, State EOC operations, and Emergency Management Assistance Compact (EMAC) request.

Beach Weather Forecasts, Research and Preparedness - Walter Drag, National Weather Service and Dr. Paul Cowan / W *Mambo 3/4* Discussion will focus on impacts of the newly implemented (2016) Nearshore Wave Prediction System (NWPS), and the 1015 AM National Weather Service-Beach Patrol conference call (2015) upon the daily rip current forecasts. Dr. Paul Cowan will present an update on Delaware's Surf Zone Injury research project. Finally, these topics will be supported by an update on beach safety preparedness activities.

May 5 THURSDAY • 3:00 - 4:15 • Breakout Session 6

Navigating the Labyrinth of Hoarding - Amy Eisenhauer / AH *Mambo 3/4* The EMS Siren Reality television has popularized hoarding disorder, but what happens before the "Got Junk" people show up? This session will discuss the hoarding disorder, its associated features, and possible co-morbid diseases. Situational awareness and provider safety is of particular concern during these responses: planning and interaction with other agencies will be addressed as well.

The Papal Visit-The County Viewpoint / DP *Castanet 1/2* Representatives from Burlington and Camden Counties, New Jersey We will be discussing the procedures, resources, and steps utilized in preparation of the Papal Visit in September 2015. The topics that will be discussed will provide an in-depth overview of the pre-deployment, deployment, and post-deployment measures taken to support regional response efforts during this visit. Highlights will include pre-deployment training's, multi-jurisdictional planning efforts, resource and equipment utilization, as well as EOC activation staffing and support logistics.

What's Your Electric Company Doing All Year? - Michael Weber, PSEG New Jersey's Electric Distribution Companies / H Bongo (EDCs) are conducting many forms of planning, exercises and training annually. Some required by the NJ BPU but most as part of best practices and continuous improvement on the part of the EDCs. This Breakout will present the many facets of Emergency Preparedness being undertaken including: exercises, training, mutual aid, vegetation management, interaction with state and local governments and process improvement.

America in Protest: Emergency Planning & Legal Implications in a Revolting Society - William McDonald and Michele Grant, Empire State College / P Bossa Nova From the nationwide protests and riots that were sparked by the police involved shooting of Michael Brown in Ferguson to the protests in NY & around the country after the death of Eric Garner, America is seeing more and more violence. Emergency managers must use past events like these to plan for inevitable future situations.. This presentation will discuss events noted above, emergency planning aspects, legal implications, and other methods that were learned after these events took place in order to ensure that public safety is upheld while maintaining the rights afforded by the United States Constitution.

2014 Ice Storm Response & Recovery - William Turner, Emergency Planning Chester County, PA / R&R Mambo 1/2 On February 3, 2014 Chester County, PA was hit with a substantial snow storm which coated the Southeast PA region with 18" of snow. On the morning of February 5th the county woke to a light drizzle of freezing rain which was coating the snow covered roads, trees and everything else. By mid-day Chester County was in the middle of its worst winter storm disaster with much of the county without power and many roads closed due to fallen trees and power lines. This presentation will discuss some of the lessons learned that took place over the next couple weeks recovering from the storm and the many partnerships that became a reality.

A Review of the late January 2016 Blizzard and Record Coastal Flooding Event - Gary Szatkowski, National Weather Service / W Castanet 3/4 The January 22nd/23rd Blizzard and record coastal flooding event was a very high impact weather event for the region. Like every very high impact event, it posed challenges in terms of communication, societal impacts, and emergency management response. This presentation will provide a quick review of the weather event, some of the forecast challenges, with a focus on coastal flooding issues. We will also cover upcoming changes to how coastal flood warning information will be conveyed.

May 6 FRIDAY • 9:00 - 10:15 • Breakout Session 7

Utilizing the Medical Reserve Corps to Support National Special Security Events: a Multi-jurisdictional Deployment in Response to the Papal Visit - Daniela Fumo, Camden County DHHS, NJ / DP Bossa Nova During the Papal Visit to Philadelphia in September 2015, Medical Reserve Corps(MRC) units in New York and New Jersey were activated to enhance medical and non-medical activities during public events tied to the papal visit. These activations were the first MRC activations in HHS Region II linked to a National Special Security Event (NSSE). The nature of these events provided a unique opportunity for MRC units to blend into a robust planning and response framework, enhance jurisdictional preparedness as well as to augment the availability of medical services, exercise critical skills, and hone deployment protocols within and across MRC units.

Not Your Father's M*A*S*H*-Establishing Alternative Medical Treatment Sites - K.C. Rondello, Adelphi / H Mambo 3/4

In many crises, the local healthcare infrastructure becomes quickly overwhelmed. Emergency Managers must collaborate with hospitals and public health officials in establishing Alternate Medical Treatment Sites (AMTS) to accommodate the increased patient load. While the Emergency Manager need not know clinical medicine, s/he must be aware of the formidable challenges associated with coordinating, establishing and operating these essential facilities. Participants will understand the fundamentals required to launch an AMTS, learn various means to ensure an AMTS' smooth functioning and identify potential pitfalls that could disrupt an AMTS' effectiveness.

Building Your Team – Effective Local Hazard Mitigation Planning - Christopher Testa, NJSP / P Mambo 1/2 The presentation will cover basics of hazard mitigation planning and give suggestions for developing an effective local hazard mitigation planning team, as well as insights on developing the experiences of the emergency manager into effective mitigation actions.

Marshalling Non-Profits & Community Resources in Response & Recovery - Kelly Higgs, NJVOAD / R&R Castanet 3/4 The VOAD movement in NJ was transformed after Hurricane Sandy, and has resulted in new resources and stronger relationships and partnerships at the state, county and local levels. One example of the modern VOAD movement is HELPNJNOW.ORG, a web-based tool built in partnership with NJ government agencies, which provides a single point of reference for multiple disaster preparedness resources as well as a post-disaster portal for managing disaster donations and volunteers. Learn how you can connect with this and so much more to strengthen your community's ability to respond to whatever storms lie ahead.

Port Authority Regional Flood Alert System: A Resource for the Emergency Manager - Michael Ricker and John Giancaspro, PANYNJ Port Authority and Alan Blumberg, Stevens Institute W Castanet 1/2 A Resource for the Emergency Manager– The region suffered a tremendous amount of damage during Superstorm Sandy as a direct result of storm surge. This presentation will provide an overview of the storm surge monitoring, forecasting, and alert system that the Port Authority of NY & NJ Office of Emergency Management is developing along with Stevens Institute of Technology. This system incorporates high-resolution mapping, water level sensors, and a hyperscale computer system for meteorological modeling that is designed to identify when storm surge will occur and provide the Port Authority with the opportunity to take mitigation measures ahead of time, enhancing overall preparedness.

May 6 FRIDAY • 10:30 - 11:45 • Breakout Session 8

What to Expect at a Natural Gas Incident and NJ One Call (811) - Michael Hogan and Michael Weber, PSEG / AH Castanet 3/4 With the increasing awareness and reality of natural gas incidents, the presenters will discuss they typical response Emergency First Responders can expect from New Jersey's Gas Utilities. Topics covered will include: leaks, damage, 811, 911, contractor safety and timeframes and actions of utility first responders.

Planning and Preparing your County Shelter - NJEOM, NJDHS, American Red Cross, NJDOH, NJDA, OHSP / DP Mambo 1/2

This session will focus on discussing how jurisdictions can prepare for and build on local and county sheltering efforts. Presenters will represent a cross-section of the State Shelter Task Force Members / Agencies and will discuss completion of the 21 county shelter assessments, current planning efforts, prescribed requests, best practices and public messaging. Task Force members will field questions from participants and discuss lessons learned from some of the recent disasters.

Burlington County CERT/MRC Deployment-Papal Visit - Wayne Comego, Burlington County OEM and Phyllis Worrell, Virtua Health System / P Castanet 1/2

Camden County requested assistance from Burlington County CERT/MRC members for the Papal visit on Sept 26th and 27th. During this event the Camden waterfront area was impacted by those walking over to Philly. This mission was very labor intense and required a tremendous amount of planning. During the event members maintained a Staging/ Check-In Area in Burlington County, provided logistical support at the County EOC, assisted the Camden County MRC and served as Good Will Ambassadors. We will discuss the planning & training process, the benefits of Mission Ready Packaging and the details of the actual deployment.

Using Storm Outage Modeling to Inform Emergency Preparedness at Electric Distribution Networks - David Wanik, University of Connecticut / W Bossa Nova

After the major storms of 2011 and 2012, the State of Connecticut recommended that electric distribution utilities work with academic institutions to create solutions to major problems faced by emergency preparedness functions. In this talk, we will present updates from

the partnership between Eversource Energy and the University of Connecticut. We will present updates from various research projects that are underway, including pre-storm outage prediction models, storm restoration duration prediction models, and impact analyses of future climate hurricane damages to the electric grid.

**MARK YOUR CALENDARS
for the 2017**

New Jersey Emergency Preparedness Conference!

Monday May 1 – Friday May 5, 2017

N J E P A

New Jersey Emergency Preparedness Association

TRAINING / MAY 2 - MAY 6

A variety of training opportunities are available to emergency responders, both public and private, to enhance response capabilities. These classes cover a wide range of topics and we attempt to present offerings in multiple disciplines. All classes receive certification and CEUs may be available. These programs are offered as part of the conference registration fee but class sizes are limited and only available on a first come first serve basis. Registration confirmation is required to attend.

| Monday, May 2 8:00 - 12:00 | Monday, May 2 1:00 - 5:00 | Tuesday, May 3 8:00 - 12:00 | Tuesday, May 3 1:00 - 5:00 |
|-------------------------------|------------------------------|--------------------------------|-------------------------------|
|-------------------------------|------------------------------|--------------------------------|-------------------------------|

ICS-300 (Carousel A/B/C)

Exercise Design Class (Carousel D/E/F)

| | | | |
|--|--|--|---|
| Emergency Management Basic Workshop (Salon 3) | | ICS Forms & Incident Action Plan Development (Salon 2) | |
| Critical Infrastructure (Mambo 2) | | Advanced Critical Infrastructure Protection (TEEX) (Mambo 2) | |
| Re-Engineering of FEMA'S Public Assistance Program (Class 1) (Bongo 1) | Re-Engineering of FEMA'S Public Assistance Program (Class 2) (Bongo 1) | HURREVAC - Basic Training (Bossa Nova 1/2) | Clandestine Labs Awareness (Bossa Nova 1/2) |
| Hazmat Awareness Train the Trainer (Bongo 2) | CBRNE Awareness Train the Trainer (Bongo 2) | Elevator Rescue (Bongo 2) | NJ Traffic Incident Mgmt. Safety Guidelines (Salon 1) |
| Medical Ambulance Bus Awareness (Tango) | Donning & Doffing (Tango) | Mental Health First Aid for Public Safety Workers (Bossa Nova 3) | |

Hazardous Weather and Flood Preparedness (Tambora)

| | | | |
|--|--|---|--|
| EMnet (Castanet 3) | | Leveraging Tools for Conducting Damage Assessments (AWR-319) (Castanet 2) | |
| Intro to Safety & Incident Response | | Keeping Children Safe (Mambo 3) | |
| Amateur Radio Technician License Course (Mariachi) | | | |

Traffic Incident Management Train the Trainer (Castanet 1)

| | | | |
|--|-------------------------------------|-----------------------------------|--|
| Understanding & Treating Police Use of Force (Mambo 3) | Shelter Fundamentals (Bossa Nova 1) | Shelter Management (Castanet 3/4) | |
| Camp Task HazMat Operations (Offsite at Bader Field) | | | |

| Wednesday, May 4 8:00 - 10:00 | Wednesday, May 4 10:00 - 12:00 | Wednesday, May 4 1:00 - 2:15 | Wednesday, May 4 3:00 - 5:00 |
|----------------------------------|-----------------------------------|---------------------------------|---------------------------------|
|----------------------------------|-----------------------------------|---------------------------------|---------------------------------|

ICS-300 (continued) (Carousel A/B/C)

Exercise Design Class (continued) (Carousel D/E/F)

| | | | |
|--|--|--|--|
| PEAC-WMD Software - Planning and Response (Bongo 2) | | | |
| Promoting Resilience for First Responders (Bossa Nova 1) | | | |
| NJ Emergency Fire Safety Deployment Act (Castanet 1) | | NJ Fire Service Statewide Resources (Castanet 1) | |
| Rapid Assessment G-557 (Class 1) (Mambo 3) | | | |
| Rapid Assessment G-557 (Class 2) (Mambo 4) | | | |

Social Media for National Disaster Response and Recovery (PER-304) (Mambo 1)

NJ Transits Emergency Response Guidelines (Bossa Nova 1)

Amateur Radio Technician License Course (continued) (Mariachi)

ICS-402 (Castanet 3)

PRD Personal Radiation Detention (Offsite at Bader Field)

Thursday, May 5

9:30 - 4:15 / Breakout sessions

Friday, May 6

| | | |
|-------------------------------------|-----------------------------------|--|
| Papal Visit Planning Review (Bongo) | Helibase Awareness Course (Bongo) | |
|-------------------------------------|-----------------------------------|--|

For questions about the schedule or courses, please contact the following:

Training Committee Chair: John Hamilton / john.hamilton@njepa.org
 Breakout Committee Chair: Pat Goelz / pmgoelz@verizon.net

Re-Engineering of FEMA's Public Assistance Program (Class 1) / May 2 - 8:00 - 12:00 / Bongo 1 FEMA will deliver an overview to State and local Stakeholders on the roll out of the Re-Engineering of the Public Assistance Program. The blocks will focus on the new position titles and roles and responsibilities. It will showcase the templates designed to transition into the "new" methodology. Public Assistance is critical to the recovery efforts of both State and Local stakeholders in New Jersey, and having an overview and some direction as we move forward with the Re-Engineered program will only enhance Recovery efforts in future events. FEMA Region 2 is the most risk prone region, and Public Assistance encompasses the bulk of Recovery dollars distributed in Recovery to our State Partners and their applicant base.

Re-Engineering of FEMA's Public Assistance Program (Class 2) / May 2 - 1:00 - 5:00 / Bongo 1 FEMA will deliver an overview to State and local Stakeholders on the roll out of the Re-Engineering of the Public Assistance Program. The blocks will focus on the new position titles and roles and responsibilities. It will showcase the templates designed to transition into the "new" methodology. Public Assistance is critical to the recovery efforts of both State and Local stakeholders in New Jersey, and having an overview and some direction as we move forward with the Re-Engineered program will only enhance Recovery efforts in future events. FEMA Region 2 is the most risk prone region, and Public Assistance encompasses the bulk of Recovery dollars distributed in Recovery to our State Partners and their applicant base.

Critical Infrastructure Security and Resilience Awareness AWR-213 / May 2 - 8:00 - 5:00 / Mambo 2 This course will introduce participants to the key terms, policy, guidance, and preparedness efforts required to safeguard the Nation's critical infrastructure. Participants will review applicable policy and guidance, discuss the risk management framework, describe Federal critical infrastructure security and resilience and information sharing programs, and relate critical infrastructure programs to individual actions. Primary focus will be placed on local preparedness efforts as they relate to the national approach to critical infrastructure security and resilience. An understanding of the national approach to critical infrastructure enables critical infrastructure stakeholders to address local planning within a common framework. Informed planning is consistent with and expands on nationally accepted emergency management standards as the basis for planning across the mission areas of prevention, protection, mitigation, response, and recovery.

Advanced Critical Infrastructure Protection / May 3 - 8:00 - 5:00 Mambo 2 In this course participants will enhance their skills to formulate considerations for the resiliency of jurisdictional assets leveraging cross-sector partnerships. These considerations will enhance the whole community's ability to manage the risk associated with critical infrastructure protection efforts. The course will implement the National Preparedness Goal by facilitating the development of Resiliency Action Plans, involving all jurisdictional critical infrastructure partners. Upon completion of this course, participants will be able to increase infrastructure owner/operator participation in jurisdictional planning, organizing, equipping, training, and exercising critical infrastructure protection efforts.

Understanding (and Treating!) Police Use of Force / May 2 - 8:00 - 12:00 / Mambo 3 You are dispatched to the 800 block of N. 32nd Street in a part of the city that has been plagued with violence over the past few months. As you respond, you and your partner are advised that police are on scene with an unconscious 23 year-old male after being struck with a conducted energy device and bleeding. As you arrive you immediately hear the commotion of the scene and see an abundant amount of law enforcement vehicles, officers as well as a very large crowd of bystanders, many with cellular telephone cameras facing in their direction. You exchange glances with your partner and exit the rig and wonder, "what happened?" **Approved for 4 CEU's from NJOEMS.**

Medical Ambulance Bus Operational Awareness / May 2 - 8:00 - 12:00 / Tango The purpose of this course is to provide EMS personnel, and guests, with an introduction to the potential missions of the medical ambulance bus, capabilities, and inventory. The course will refer to the State of New Jersey Statewide Incident Rehabilitation Guidelines for EMS, Rehab Log, Rehab Tag, and operational items related to the medical ambulance bus.

HazMat: Awareness Course Train-the-Trainer / May 2 - 8:00 - 12:00 / Bongo 2 The course purpose is to give the students the knowledge and skills to respond safely and efficiently to Hazmat incidents at their level of responsibility and training, continue with Hazmat on the job training at their level and develop and participate in Hazmat response exercises at their level of training. The participants will have the competencies specified for the Awareness trained First Responder by OSHA, PEOSHA, and NFPA 472-02. 1. The goal is for those persons who, in the course of their duties, may witness or come upon a scene of a hazardous materials incident. (E.g., Police, Firefighters, EMS personnel, public works field inspector's and OEM person not familiar with HazMat. Response etc.) Course covers basic recognition, proper defensive actions that need to be taken and use of the DOT Emergency Response Guidebook (ERG). Covers the basic laws and regulations in New Jersey as well how, when to call for assistance. This course provides compliance in the OSHA regulations and the NJ PEOSH requirements. OSHA Level 1 training -Hazardous Materials Awareness (FRA) 06007 (4 hrs.) None. This course is the prerequisite for all the other courses in the program. Introduction, definitions laws and regulations overview Health & Safety Issues affecting a response Detecting the Presence of Hazardous Materials. US DOT Emergency Response Guidebook (ERG) Scene Management Roles & Notification responsibilities of Municipal, County and State organizations Putting it all together 4.0 hours.

0.25 CEU's towards the Fire Instructor certification

ICS-300 / May 2 - 4 - 8:00 - 5:00 / Carousel A/B/C ICS-300 provides training and resources for personnel who require advanced application of the ICS. The course expands upon information covered in the ICS-100 and ICS-200 courses. This course is intended for individuals who may assume a supervisory role in expanding incidents or Type 3 incidents. **Prerequisites: ICS-100 and ICS-200, IS-/ICS-700, IS-/ICS-800.**

EMnet (Emergency Management Network) / May 2 - 8:00 - 5:00 / Castanet 3 New Jersey's Emergency Alert System. We have this system located in every county, many cable providers, radio stations and utilities companies. With this system we provide emergency alerts for the state, as well as Amber alerts, Weather and emergency messaging.

Emergency Management Basic Workshop / May 2 - 8:00 - 5:00 Salon 3 An eight hour introductory course for personnel who are new to the field of emergency management. Subject material will include New Jersey Emergency Management Laws and Directives, the Integrated Emergency Management System, the Role of the Emergency Management Coordinator, Training, Exercising Programs and Disaster Recovery. This course may be attended by all New Jersey personnel in the emergency management field.

0.5 CEU's towards the Fire Instructor certification

Traffic Incident Management Train-the-Trainer / May 2-3 - 8:00 - 5:00 / Castanet 1 The National Traffic Incident Management (TIM) Responder Train-the-Trainer (TtT) program is intended to provide course participants (i.e., trainers) the knowledge and materials necessary for them to conduct TIM training for TIM responders in their area or state. The TtT is a 2-day course that covers 16 hours of material as follows:

- Classroom Training = 8.5 hours
- Hands-on and Outdoor Activities = 2.5 hours
- Training Implementation Plan Discussion
- FHWA SharePoint Site Overview

- Plus NJ Specific Program and Strategic Plan = 4 hours
- Training Wrap-up = 1 hour

Once trainers have completed the TtT course, they will have the flexibility to train others as appropriate by using either:

- The 10-hour National version in its entirety (Classroom training plus the hands-on and outdoor activities)
- Single lessons/activities, one at a time
- The 4-hour version, which covers the same lesson objectives as covered in the 8.5-hour classroom portion of the TtT course.
- The 4-hour version, which covers the same lesson objectives as covered in the 8.5-hour classroom portion of the TtT and is specific to NJ.

Prerequisites: TIM and Instructor Experience. Please bring a laptop for classroom participation. NJDOH and NJDFS CEU's available for Fire and EMS for 10.5hrs of training.

1.0 CEU's towards the Fire Instructor certification

Exercise Design Class from FEMA / May 2 - 4 - 8:00 - 5:00 / Carousel

D/E/F Emergency managers, emergency services personnel, and other individuals who are part of the emergency preparedness and response or continuity of operations need to be able to use the fundamentals of exercise simulation and design as an integrated system of resources and capabilities. Skills learned during this program will enable jurisdictions to conduct NIMS required exercises. The course will develop emergency response and continuity exercise skills in the following areas: • Exercise program management • Exercise planning process • Exercise design steps • Tabletop, functional and full scale exercises • Exercise evaluation • Exercise enhancements • Designing a functional exercise The course will conclude with students conducting and evaluating actual tabletop and functional exercises in a group/team environment.

Hazardous Weather and Flood Preparedness / May 2 - 3 - 8:00 - 5:00

Tambora This 2-day course will discuss basic principles of meteorology and hydrology, and provide participants with policies, definitions, and products used by the National Weather Service (NWS) to forecast and warn for hazardous weather events. This training will provide public safety officials with the necessary knowledge to anticipate hazardous weather events and to coordinate an effective response in order to minimize loss of life and property in their community.

HazMat Tank Car Response / May 2-3 - 8:00 - 5:00 / Offsite at Bader

Field Tank Truck Emergency Response Workshop: This 16-hour course dedicated to cargo tank emergency response was designed with the general needs of the fire service in mind! After all this isn't rocket science and STTS is not in the business of training astronauts! STTS takes a complicated subject and puts it into a memorable presentation to which the street smart emergency responder can both relate to and understand. In summary, STTS doesn't come to town with the intention of teaching everything they know. Instead, STTS focuses on the critical information responders need to understand prior to taking defensive or offensive actions. On completion of this work-shop attendees will understand: How to determine the correct specification of a cargo tank and why it matters. Construction features associated with cargo tanks and their relationship to damage assessment, uprighting, leaks and spills. The purpose and functions of safety relief devices and other emergency devices. Norma/loading and unloading procedures and the golden rules applicable to all product transfers. Basic principals and techniques associated with emergency loading and unloading Containment techniques suitable for cargo tanks. Emergency procedures to following the event of leaks or the activation of pressure relief devices.

***This course will be held off-site. Students will be required to report directly to the off-site location. More information and directions will be posted soon.**

1.0 CEU's towards the Fire Instructor certification

Donning and Doffing PPE and ISOPD, Infected Patient Transport Chamber Training / May 2 - 1:00 - 5:00 / Tango Proper donning and doffing techniques. A review of the ISOPD modules. And a review of transportation of infected patients in the Transport Chamber. EMS Task Force.

CBRNE Awareness Train the Trainer / May 2 - 1:00 - 5:00 / Bongo 2

The purpose of this training course is to provide responders who during the course of their duties, may come upon or respond to a CBRNE incident, recognize the hazards, its potential, and to make the appropriate notifications. 1. The goal of the CBRNE Awareness course is as an extension of the HAZMAT AWARENESS training class and is designed and intended to impart general broad based definitions, terms, information to first response personnel who may in the course of their duties respond to such incidents. Attendees will explore the federal laws and rules as established through FBI, OSHA, NJ PEOSH, EPA, and the State rules/laws that apply to such a response. a. To review some recent history and point out that these CBRNE weapons have been used, including in the Tokyo Subway attack in March of 1995. b. To recognize the signs and symptoms of CBRNE poisoning because these frequently will be the first indication you'll have of an attack c. To understand and recognize the potential types of dissemination devices that might be used, so you are better equipped to recognize a potential threat situation. d. To describe the proper initial response actions for emergency responders at either a suspected or actual CBRNE incident site. **OSHA Level 1 training –CBRNE Awareness 06085 (4 hrs.)**

0.25 CEU's towards the Fire Instructor certification

Introduction to Safety and Incident Response in a Freight Railroad

Environment / May 2 - 1:00 - 5:00 This class will discuss the railroad culture, the safety "do's and don'ts" in the railroad industry environment, and, the vast resources available from the railroad industry and the assistance emergency responders can provide to conduct and mitigate an incident safely and effectively. This course is meant to both enhance the skills needed to safely perform your role as emergency responders, and serve as a guideline that can be incorporated into your jurisdiction's Standard Operating Procedures. This program was developed in cooperation with the major freight railroads operating within the state of New Jersey; Conrail, CSX Transportation and Norfolk Southern. Our goal is to educate first responders so that they are better equipped to act in the unlikely event of a rail emergency. Topics to include: On-Scene Safety/ Support Role for first Responders, Initial Response Procedures, Hazardous Materials, Tank Cars Railroad Equipment/Locomotives, Railroad Operations and Procedures, Train Documentation, Preplanning, Contacting the Railroads, Railroad Personnel.

0.25 CEU's towards the Fire Instructor certification

Shelter Fundamentals / May 2 - 1:00 - 5:00 / Bossa Nova 1

Shelter Fundamentals is a basic level course that introduces the guidelines and procedures for setting up, running and closing a shelter during a disaster. Referencing shelter checklists, participants will work on a case study that takes them through four of the six phases of the Sheltering Cycle: Opening, Organizing, Operating and Closing. Shelter Fundamentals is available in two delivery formats, instructor-led and online. Both formats cover the same content. • Classroom participants must attend the entire course and complete the classroom activities to earn a course certificate.

Basic Hurrevac Course / May 3 - 8:00 - 12:00 / Bossa Nova 1/2

HURREVAC is a storm tracking and decision support tool for government emergency managers. The software is a product of the National Hurricane Program (NHP), a multi agency Federal partnership that provides products, training, and operational support to assist hurricane planning, preparedness, response, and decision making at all levels of government. The software uses data from Hurricane Evacuation Studies (HES) along with real-time hurricane forecast data from the National Hurricane Center. This combination allows users to view hurricane

forecast data both graphically and through detailed reports, and allows the software to calculate specific local evacuation decision times as hurricanes approach. The HURREVAC training course provides students with an overview of what the program is, how it works, and how to operate the program. By the end of the course, students will be familiar with the functions and tools within HURREVAC and how to access them.

Keeping Children Safe; One School at a Time / May 3 - 8:00 - 12:00

Mambo 3/4 Between 2000 and 2013, there have been 160 active shooter incidents in the United States which took place in a public location; 39 of these incidents occurred in educational institutions. The New Jersey Department of Education's Office of School Preparedness and Emergency Planning has visited nearly 300 schools during the 2014-2015 school year throughout the State of New Jersey and conducted unannounced school drill observations in accordance with NJ Statute 18A:41-1; School Drill Law. During this session, the presenters will share overarching findings from the visits, common themes and elements which should be addressed in all schools; many which are at no cost.

Elevator Rescue and Emergencies / May 3 - 8:00 - 12:00 / Bongo 2

Emergency personnel with inadequate training in responding to stalled elevators are exposed to an increased risk of injury and death to both the victims and themselves. Learn how to safely and effectively remove passengers from stalled elevators as well as basic elevator procedures. Topics include nomenclature, safety, how an elevator functions, construction, elevator safety devices, possible equipment needed for rescues, initial response steps, lock-out/tag-out procedures, elevator doors, use of hoistway door keys, poling, firemen service (phase I/phase II) and manually lowering a hydraulic elevator. **This is a 4 hour course. 0.25 CEU's towards the Fire Instructor certification**

ICS Forms and Incident Action Plan Development /

May 3 - 8:00 - 5:00 / Salon 2 This program will focus on the use of the Incident Command System (ICS) Forms in accordance with the National Incident Management System (NIMS). This program will include a Fundamental review for Command, Command Staff, and General Staff Roles and Responsibilities. Through active participation those attending the course will work through the various and most commonly used forms in the Incident Command System. Those in attendance will develop through various activities and tabletop activities Incident/Event Action Plans (IAP's) for operational periods. Participants will also work through the Planning Cycle and the Planning "P". Those in attendance will be given the opportunity to work in an All Hazards model between Police, Fire, EMS, Emergency Management, Public Health, and Hospital Staff. Target audience are those first responder's who based on roles and responsibilities during an incident may be responsible for creating ICS Forms as part of current incident documentation or the development of an Incident Action Plan. ***This is an 8 hour course.**

0.5 CEU's towards the Fire Instructor certification

Leveraging Tools for Conducting Damage Assessments (AWR-319) /

May 3 - 8:00 - 5:00 / Castanet 2 The scope of this course is to provide a review of damage assessment, the importance of providing quick and accurate assessments, and an opportunity to review and practice with tools to assist in conducting damage assessments. The course will also review various disaster damage assessment processes, collaborating agencies, and resources. Participants will discuss and develop a damage assessment action plan in order to ensure that resources are in place for an adequate response, followed by a hands-on exercise using various tools and software to collect damage assessments. Course Modules include: Concepts of Damage Assessment Damage Assessment Action Plan Damage Assessment Tools. ****Note: The NJEPA will share your registration information with NDPTC for this course.**

NJ Highway Incident Traffic Safety Guidelines and Risk Management for Emergency Responders on Limited Access Highways / May 3 -

1:00 - 5:00 / Salon 1 This course will cover the uniform operational guidelines to ensure safe operations and limit the liability risks by emergency responders dispatched to incidents on limited access highways in the State of New Jersey. These guidelines were formulated based on nationally recognized practices and procedures and input from representatives of those agencies listed under the State of New Jersey Highway Incident Traffic Safety Guidelines for Emergency Responders Committee and endorsed by the New Jersey Office of the Attorney General.

0.25 CEU's towards the Fire Instructor certification

Clandestine Labs Awareness / May 3 - 1:00 - 5:00 / Bossa Nova 1/2

The course purpose is to give the students the knowledge and skills to:
o Review the different types of clan labs that may be encountered in NJ.
o Provide awareness of the hazards associated with encountering a clan lab
o respond safely and efficiently to such incidents at their level of responsibility and training
Goal: The participants will have the competencies specified for the Awareness trained First Responder by OSHA, PEOSHA, and NFPA 472-02.1. The goal is for those persons who, in the course of their duties, may witness or come upon a scene of a hazardous materials incident. (E.g., Police, Firefighters, EMS personnel, public works field inspector's and OEM person not familiar with HazMat. Response etc.) Course covers basic recognition, proper defensive actions that need to be taken and use of the DOT Emergency Response Guidebook (ERG). Covers the basic laws and regulations in New Jersey as well how, when to call for assistance. This course provides compliance in the OSHA regulations and the NJ PEOSH requirements. OSHA Level 1 training -Hazardous Materials Awareness (FRA) 06007 (4 hrs.) Pre-requisites None. This course is the prerequisite for all the other courses in the program. Topics - Introduction, definitions laws and regulations overview • Health & Safety Issues affecting a response • Detecting the Presence of Hazardous Materials • US DOT Emergency Response Guidebook (ERG) • Scene Management • Roles & Notification responsibilities of Municipal, County and State organizations • Putting it all together.

0.25 CEU's towards the Fire Instructor certification

Amateur Radio Technician License Course and Test / May 3 - 4 -

8:00 - 5:00 / Mariachi \$55.00 LEVEL 1: Technician Class License Exam Requirement: 35-question Technician Written Exam (Element 2). Privileges: All VHF/UHF Amateur bands (frequencies above 30 MHz). Limited operations in certain HF bands. The FCC Technician License exam covers basic regulations, operating practices and electronics theory, with a focus on VHF and UHF applications. Morse code is not required for this license. With a Technician Class license, you will have all ham radio privileges above 30 MHz. These privileges include the very popular 2-meter band. Many Technician licensees enjoy using small (2 meter) hand-held radios to stay in touch with other hams in their area. Technicians may operate FM voice, digital packet (computers), television, single-sideband voice and several other interesting modes. You can even make international radio contacts via satellites, using relatively simple station equipment. Technician licensees now also have additional privileges on certain HF frequencies. Technicians may also operate on the 80, 40 and 15 meter bands using CW, and on the 10 meter band using CW, voice and digital modes. Changes to the Technician Class rules as a result of the recent FCC rule changes are provided in the Technician Class rule changes supplement. ****There is a separate \$55.00 fee for this course. This covers your book, mailing of the book to you so you can study prior to the class and the test fee. You are required to registered for the conference and pay the course fee to attend this course!**

I-402 Incident Command for Executives / May 4 - 8:00 - 12:00 / Castanet 3 This program is an orientation for executives, administrators and policy makers. It provides a basic understanding of ICS for individuals who establish or implement policy but who are normally not part of the on-scene ICS organization. It also provides an introduction to the National Incident Management System, A nationwide template that enables all government, private sector, and non-governmental organizations to work together during emergency incidents. This program will be completed in approximately one 2-hour session.

Rapid Needs Assessment Workshop – G557 (Class 1)
May 4 - 8:00 - 12:00 / Mambo 3 This course teaches the need and development of plans/procedures for rapidly and efficiently collecting disaster intelligence immediately following a disaster.

Rapid Needs Assessment Workshop – G557 (Class 2)
May 4 - 8:00 - 12:00 / Mambo 4 This course teaches the need and development of plans/procedures for rapidly and efficiently collecting disaster intelligence immediately following a disaster.

Promoting Resilience for First Responder / May 4 - 8:00 - 12:00
Tango This four hour workshop addresses the importance of preparing First Responder Communities to address traumatic stress and make identifying and responding to their own stress a standard operating procedure. Participants will leave with skills for pre-deployment activities to reduce stress as well as a vernacular for bringing the behavioral health conversation and reducing existing stigma. They will learn warning signs for suicide and substance abuse and will leave with tools from knowing appropriate referrals to the most helpful mobile apps to support the treatment of long term stress reactions.

0.25 CEU's towards the Fire Instructor certification

N.J. Emergency Fire Service Deployment Act / May 4 - 8:00 - 12:00
Castanet 1 This course will inform attendees of the various State and County level fire emergency resources and programs available to them. The Fire Resource Deployment Act along with the Fire Coordinator system will be explained and how to access the Fire Coordination system in their community. Fire mutual aid plans and agreements will be discussed. We will provide information on specialized firefighting equipment throughout the state and discuss recent large scale deployments.

0.25 CEU's towards the Fire Instructor certification

Incident Management System for Executives and Elected Officials – I-401 (Half Day Class) / May 4 - 8:00 - 12:00 This program is an orientation for executives, administrators and policy makers. It provides a basic understanding of ICS for individuals who establish or implement policy but who are normally not part of the on-scene ICS organization. It also provides an introduction to the National Incident Management System, A nationwide template that enables all government, private sector, and non-governmental organizations to work together during emergency incidents. This program will be completed in approximately one 2-hour session.

0.25 CEU's towards the Fire Instructor certification

NJ Fire Service Statewide Resources (Half Day Class) / May 4 - 1:00 - 5:00 *Castanet 1* This course will inform attendees of the various State and County level Fire emergency resources and programs available to them. The Fire Resource Deployment Act along with the Fire Coordination system will be explained and how to access the Fire Coordination system in their community. Fire Mutual Plans and agreements will be discussed. We will provide information on specialized firefighting equipment throughout the state and discuss recent large scale deployments.

0.25 CEU's towards the Fire Instructor certification

New Jersey Transit's Rail & Bus Safety for First Responders / May 4 - 8:00 - 5:00 / Bossa Nova 1 The objective of this training is to provide to all first responders a basic overview of New Jersey Transit's Rail & Bus Emergency Response Procedures. The training starts with a Real World video of an actual passenger train emergency and a full response by Emergency Services, and will proceed into the Emergency Response Guidelines presentation. The following Subjects will be covered; brief history, railroad direction and system map, NJT Police and Emergency Services, connecting services, response agencies, ICS/NIMS, general railroad safety awareness, Train Crews and Supervisors responsibilities, determining location, protecting your personnel, stopping trains safely with hand signals, and many more safety related tips for operating on or near NJ TRANSIT property and creating a SOG for your agency.

***The afternoon portion of this class is off-site of the Hotel. Transportation will be provided. Students need to dress appropriately for weather. **This is an 8 hour course.**

Social Media for Natural Disaster Response and Recovery (PER-304) / May 4 - 8:00 - 5:00 / Mambo 1 This course focuses on the use of social media in disaster preparedness, response, and recovery. Social media has shown to help people communicate and collaborate about events as the events unfold. Social media can provide rapid and immediate real-time information about events that helps provide greater situational awareness leading to better decision making. Participants are provided with the knowledge and skills to integrate social media into their current communication plans. The course defines social media and its uses and identifies the tools, methods, and models to properly make use of social media in the context of disaster management and provides the information and hands-on experience necessary to help the participants' create social media disaster plans. Course Modules include: Introduction to Social Media Understanding the Use of Social Media and Disaster Management Implementing Different Social Media Platforms for Disaster Management Facebook Hands-On Twitter Hands-On Crowdsourcing & Data Mining. ***Note: The NJEPA will share your registration information with NDPTC for this course.**

0.5 CEU's towards the Fire Instructor certification

PRD Personal Radiation Detection (Offsite) / May 4 - 8:00 - 5:00
Offsite at Bader Field This instructor-led, exercise-based course is designed to train the Preventive Radiological/Nuclear Detection (PRND) mission using a personal radiation detector (PRD) to perform a preliminary radiological assessment. Responders operate PRDs to detect radiation, verify the radiation alarm, localize the source of radiation, measure the radiation level, and assess the threat status of the situation. Participants employ PRDs to help adjudicate potential threats regarding situations with people, vehicles, packages, and facilities. Additional information regarding PRND operations in maritime environments is available and included as needed. Sealed radioactive sources are used during drills and practical exercises. These sources are intended to simulate types of radioactive material that may be encountered in the public domain. Course content includes a primary screener's role in the Global Nuclear Detection Architecture and the National Preparedness Core Capabilities.

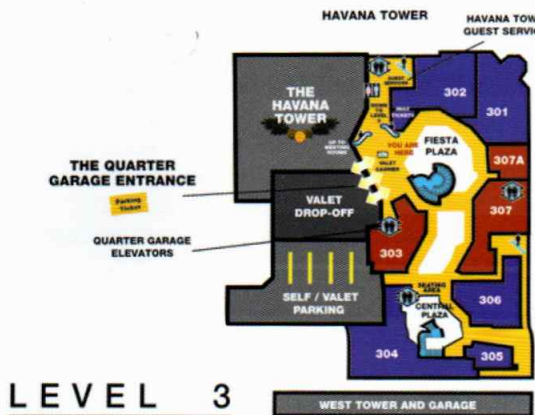

ARRIVAL-QUARTER GARAGE

- ENTERTAINMENT**
- Cuba Libre 301/228
 - Restaurant & Rum Bar 306
 - The Comedy Stop Cafe & Cabaret 302
 - IMAX Theatre 305
 - Planet Rose Karaoke Bar 307
 - The Sound of Philadelphia (TSOP) 304
 - 32' Luxe Lounge 307 A
 - Ri-Ri Irish Pub & Restaurant 303
- RESTAURANTS**
- Adam Good 307
 - Crab Shack & Sports Bar 307 A
 - Bride-The Dessert Experience 307 A
 - Ri-Ri Irish Pub & Restaurant 303
 - The Sound of Philadelphia (TSOP) 304

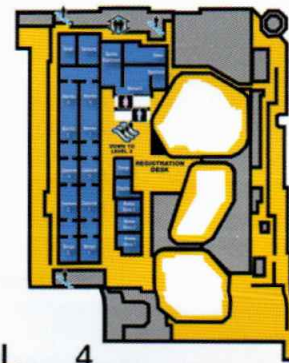

HAVANA TOWER MEETING ROOMS

- | | |
|-------------------|----------------|
| Bongo 1 Room | Mambo 1 Room |
| Bongo 2 Room | Mambo 2 Room |
| Bossa Nova 1 Room | Mambo 3 Room |
| Bossa Nova 2 Room | Mambo 4 Room |
| Bossa Nova 3 Room | Mariachi Room |
| Castanet 1 Room | Rancheros Room |
| Castanet 2 Room | Salta Room |
| Castanet 3 Room | Samba Room |
| Castanet 4 Room | Tambora Room |
| Cha Cha Room | Tango Room |
| Conga Room | |

LEVEL 4 MEETING ROOMS

- NORTH TOWER**
- Royal Swan Ballroom (Salons 1-6)
 - Cape Room
- SOUTH TOWER**
- GEC (Grand Exhibition Room)
 - Board Room
 - Carousel Room
 - Pageant Room
 - Parade Room
 - Rolling Chair Room
 - Sandcastle Room
 - Seaside Room

LEVEL 3

LEVEL 4

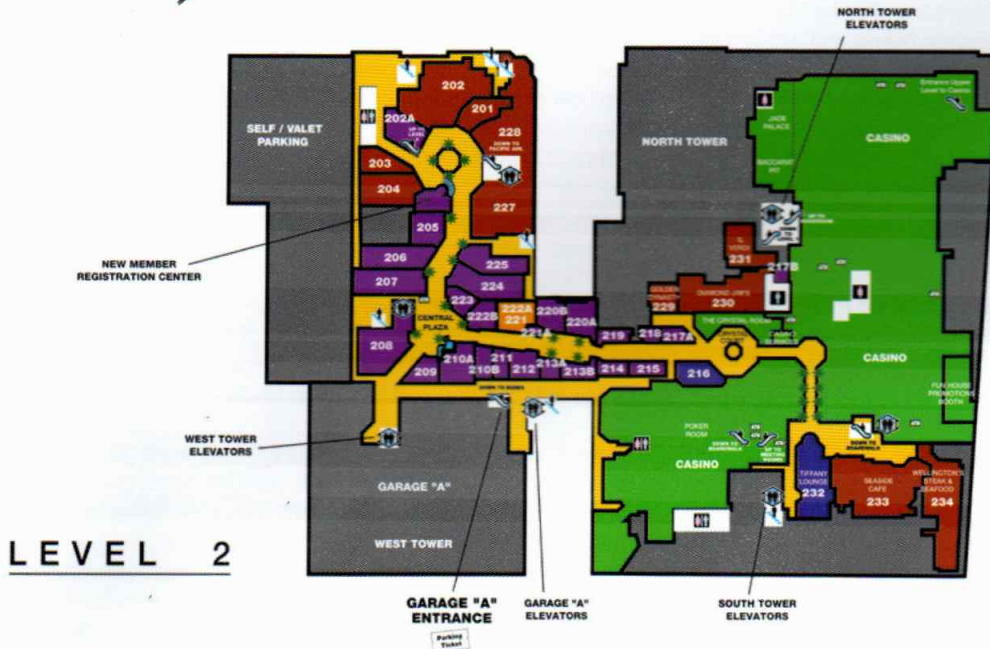

CASINO LEVEL

- ENTERTAINMENT**
- Tango's Casino Lounge 218
 - Tiffany Lounge 232
- RETAIL**
- Barron Gentleman 212
 - Brandeis Jewellers 220 A
 - Brandeis Perfect Accessories & Leather 220 B
 - Brooks Brothers 207
 - Caché 225
 - Chez Lingerie 211
 - Chico's 224
 - Erwin Pearl 217 A
 - Hat Emporium 213 A
 - Havana Sundries 221 A
 - Houdini's Magic Shop 209
 - Jak's Dog House 213 B
 - MONDI 223
 - Old Farmers Almanac 208
 - Ritts House Gift & Home 219
 - Salva Shoes 222 B
 - The Collection by Tahari 206
 - The Spy Store 210 B
 - Tinder Box/ Vino 100 202 A
 - Tropicana Casino Market 217 B
 - Swarovski 214
 - White House/Black Market 210 A
 - Zephyr Gallery 215
 - Zionan Furs 205
- RESTAURANT**
- Carmine's 227/103
 - Cuba Libre Restaurant & Rum Bar 228/301
 - Diamond Jim's 230
 - Golden Dynasty 229
 - Il Venti 231
 - Panaderia del Mundo 203
 - P.F. Chang's China Bistro 201/101
 - Red Square 202
 - Seaside Cafe 233
 - Wolfgang's Steak and Seafood 234
 - Zeytina New York's Gourmet Choice 204
- SPA**
- blissmercury apothecary & spa 231/222 A

LEVEL 2



STREET LEVEL

- ENTERTAINMENT**
- Firewaters 112
- RETAIL**
- Boardwalk Corner Store 108
 - James Salt Water Taffy 115
 - Starbucks® Coffee 109
 - Tropicana Lobby Market 118
- RESTAURANT**
- Adam Good Deli 114
 - Beachfront Buffet 117
 - Boardwalk Favorites 110
 - Carmine's 103
 - Corky's ribs & BBQ 103
 - Create A Cone 111
 - Hooters 116
 - Coffee/Snack Shop 118
 - P.F. Chang's China Bistro 101
 - The Palm 102
- SPA**
- blissmercury apothecary & spa 104
 - Salon at Tropicana 106

- ESCALATORS
- ELEVATORS
- STAIRS
- RESTROOMS
- WOMEN'S RESTROOMS
- MEN'S RESTROOMS
- ATM
- ENTERTAINMENT
- RETAIL
- RESTAURANT
- CASINO
- SPA
- WALKWAY

4TH FLOOR - SOUTH TOWER

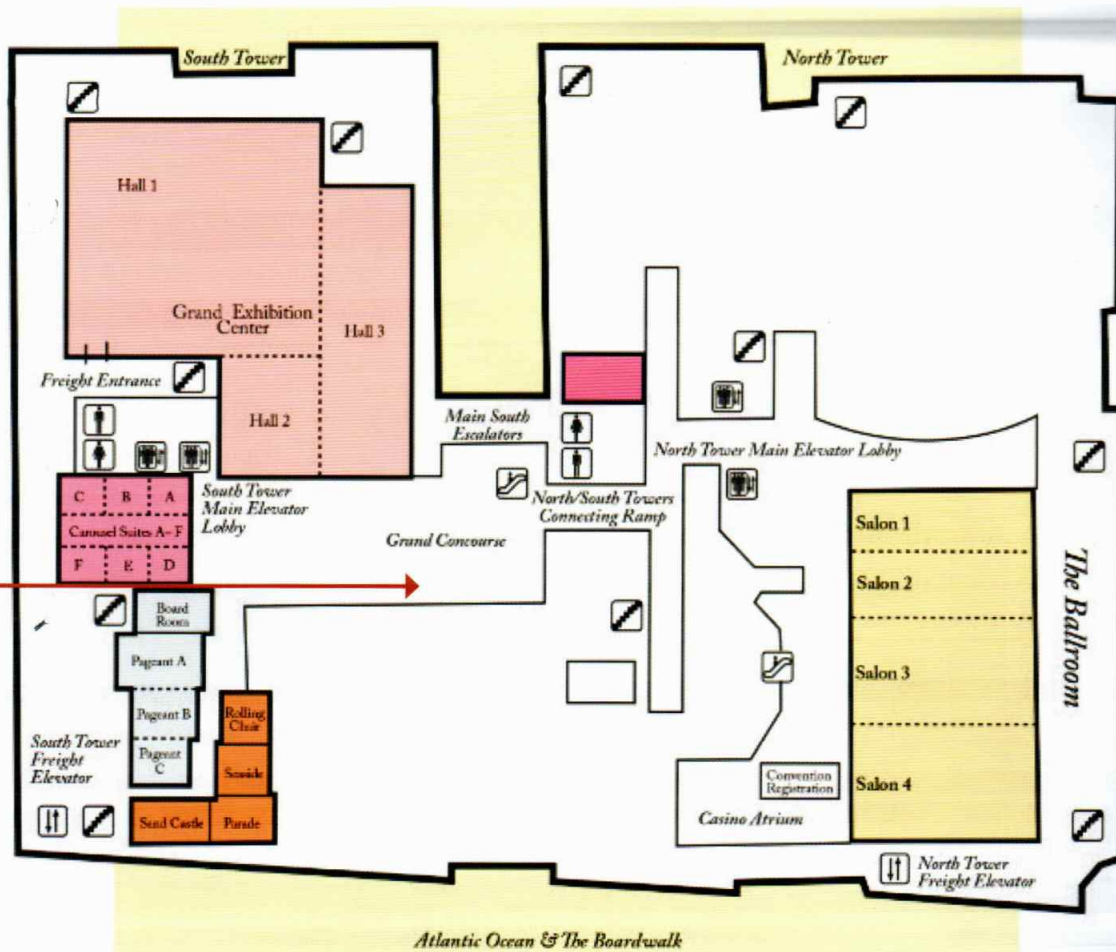

REGISTRATION



HAVANA TOWER LEVEL 4 MEETING ROOMS

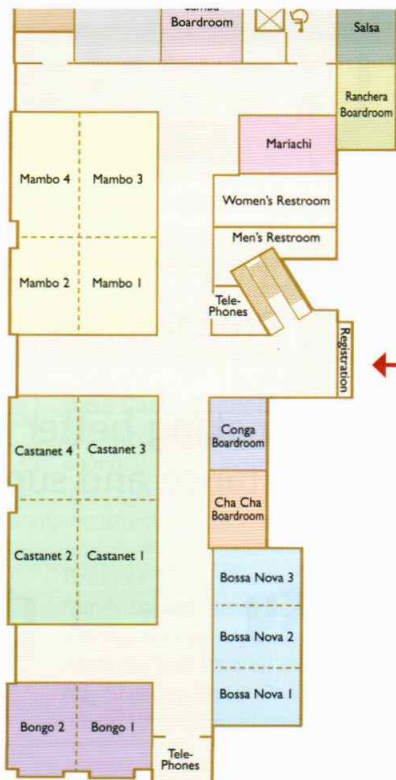

EXPRESS REGISTRATION



ENERGIZED TO MAKE A DIFFERENCE.

We're proud to partner with our community's First Responders and to support the New Jersey Emergency Preparedness Conference.

Thank you for your valuable contribution in making better communities for us all through your response, assistance and support.



Energy for a changing world.™

EXHIBITORS

908devices **908 Devices** • M908 is a handheld mass spec device used by leading global CBRNE organizations for rapid identification of priority chemical threats, including CWAs, TICs, and precursors.



AJ Abrams • With 46 years' experience, we are your leading source for the best and latest

technology in safety monitoring instrumentation and Personal Protective Equipment for workplace safety.



Access Credential Systems (ACS) East is a systems integrator specializing in Identity, Credentialing and Incident Management. We represent ENTRUST/DATACARD, SALAMANDER, ZEBRA and others providing enhanced identity of people and equipment.



Service. Leadership. Relevance. These values guide **American Military University**. Our students are part of a global community of distance

learners. Open to all and focused on those who serve. AMU offers response professionals academic programs combining theory with real-world experience. We want you to make an informed decision about the university that's right for you. For more about our graduation rates, the median debt of students who completed the program, and other important information, visit www.apus.edu/disclosure.



AramSCO is the leading provider for environmental safety, emergency preparedness, and surface preparation markets. We offer quality products, an experienced sales staff, and reliable delivery.



A PHI Company

Atlantic City Electric, subsidiary of Exelon Corporation the nation's leading competitive energy provider, provides electric delivery services to more than 547,000 customers in southern New Jersey including

Atlantic, Cape May, Cumberland, Gloucester, Salem and portions of Camden, Burlington and Ocean counties. We focus on providing safe, reliable and affordable electricity to our customers. Atlantic City Electric is proud to be at the forefront of supporting our community and those who protect it by promoting safety and emergency preparedness through our Emergency Services Partnership Program.



Base Camp Connect is the only transportable, user-deployable communication system making true interoperability possible between

existing voice, data and radio equipment/technology in a 5 minute setup.



Brenner Metal Products is a family owned business, serving our Warfighters for over 60 years. With headquarters located in Wallington, NJ, Brenner Metal Products manufacturers field hospital

equipment & emergency management products for the Department of Defense & State & Local Agencies. All Brenner Metal Products are proudly made in the U.S.A. www.brennermetal.com.

Crisis Track™ integrates mobile data collection for FEMA subgrants within local government work flows (road closures, permitting, parks) for faster, more efficient, and collaborative recovery management.



With real-time situational awareness, better communication, and drone capabilities, **CurrantGRID™** is the affordable incident management system that's changing the way we respond to disaster.



Emergency Communications Network LLC

• CodeRED® enables public safety officials to send time-sensitive critical and mass communications via personalized voice, email, and text messages to thousands of citizens within minutes.



Everbridge provides a unified critical communication suite that helps clients be better prepared, make better

decisions, and respond quickly and confidently during disruptive events.



FDR Hitches • Since 1996, FDR Hitches has been serving the community with its sales and service of cargo & utility trailers, snow plows, salt spreaders, automotive parts and accessories.

Our commitment to high quality products and service is our top priority.



The Jersey Shore Chapter and the Southern Shore Chapter of the **American Red Cross**, led by volunteers, is recognized as the leader in providing relief to victims of disasters and

services to military personnel, while educating our communities in the prevention, preparedness and response to emergencies in a caring and professional manner.



Since 1973, **Fire News** has been dedicated to serving fire, rescue, and EMS heroes.

Our six editions, social media pages with over 115,000 users, and website FireNews.com feature great action photos, report on current issues, and is a valuable resource for the latest products and services. Fire News is proud to once again be the official paper for the New Jersey State Firemen's Convention.



Firefighter One is a premier supplier of quality products and services specifically targeted to Emergency Personnel.

Firefighter One's mission is to provide the First Responder community with unprecedented levels of experience and efficiency in order to make their jobs as safe, easy and comfortable as possible.



FloodSmart is a comprehensive marketing campaign established by FEMA's National Flood Insurance Program to educate communities, partners, stakeholders, property owners

and renters nationwide about the risk of flooding and importance of flood insurance protection.

“Energy reliability is not an abstract. It’s a reality to me, my family and friends. We live here.”

Energizing New Jersey

Meet Henry. He’s a Reliability Engineer in Flemington and has been serving customers with JCP&L since 2007.

Henry is dedicated to providing reliable service to JCP&L customers throughout the community. Maybe you’ve seen Henry - also a dedicated father - taking his son to swimming lessons at the local YMCA or driving his daughter to her ballet lessons. Or, you may recognize this former 80-meter champion sprinter and Olympic contender as the guy still pushing his limits on an early morning run near his home.

Henry is proud to be part of your hometown energy team.



www.jcp-l.com

Jersey Central
Power & Light
A FirstEnergy Company

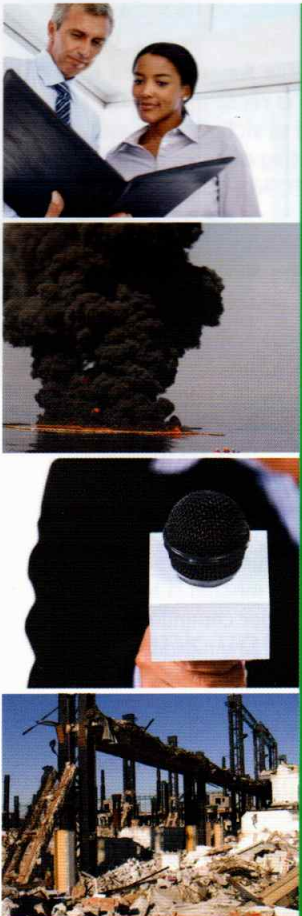

Witt O’Brien’s helps stakeholders organize and plan for recovery. Our team of experts understands what can be expected from and leverage resources from government sources (federal, state, and local), NGOs, and the private sector to achieve results and maximize opportunities. Through our experience and expertise, we ensure you are better able to oversee work effort and documentation to maximize reimbursements, support project claims processing, facilitate project reporting, and effectively support appeals and audits.

Witt O’Brien’s is a global leader in crisis and emergency management with the depth of experience and capability to provide services across the crisis disaster life cycle. Witt O’Brien’s brings a new approach to the crisis and disaster industry by combining extensive real-world experience with innovative preparedness, response, recovery, and technology solutions focused on controlling the outcome.

WITT | O’BRIEN’S

CONTROL THE OUTCOME*

www.wittobriens.com

PREPARE | RESPOND | COMMUNICATE | RECOVER



Frederick Community College is the only college in the country contracted with FEMA's Emergency Management Institute to provide college credit for the Independent Study Program.



Gen-el Safety & Industrial Products, LLC is a full line Safety Distributor. For over 20 years we have supplied our customers with quality products at competitive prices. Our complete product knowledge of Hazmat

Equipment, Gas Detection Instrumentation, Air Sampling Equipment, Respiratory Protection, and Protective Clothing has made Gen-el one of the premier safety distributors in the New Jersey area. We supply products for Safety & Health, Industrial Hygiene, Environmental, Hazmat, First Response, Weapons of Mass Destruction and Firefighters Protection.



IAEM-USA, the nation's largest emergency management professional association, represents more than 5,500 emergency managers from all sectors and government levels involved in preparing for, responding to, and recovering from all types of disasters including acts of terrorism. The 2013 Annual Conference & Exhibit will take place Oct 25 - 30th in Reno, NV. Visit www.iaem.com and www.emex.org for more information.



Know immediately who is responding, when and where! **IaR** reduces response times, and helps you get out with more complete, safer crews faster. **ALSO INCLUDES:** dispatches to your mobile devices; Google mapping to your incident location, hydrants and 30+ other map points; NFIRS, AVL, mass-messaging; scheduling; and so much more! Try a **FREE 2-MONTH TRIAL**.



ImageTrend's software solutions help emergency professionals collect and analyze key data, and connects data for fully integrated patient care. ImageTrend is the solution trusted nationwide.



Intermedix delivers technology-enabled services and SaaS solutions to health care providers, government agencies and corporations.



A FirstEnergy Company

customers in 13 counties within a nearly 3,300-square-mile area of northern and central New Jersey. Our Emergency Command Center is home to our Incident Management Team, which is responsible for our coordinated planning and preparation efforts in advance of significant storms or emergencies. JCP&L is a subsidiary of FirstEnergy, a leading regional energy provider dedicated to safety, operational excellence and responsive customer service.

Joshua Marcus Group



Joshua Marcus Group, LLC • Info- Supplier for Promotional items-awards, coloring books, pens, mugs, safety educational literature.

"We Specialize In Rush Service". Business owned operated by New Jersey Exempt Firefighter.



Knowledge Center™ (KC) is a web-based, commercial off-the-shelf software solution supporting daily emergency management operations at all levels. Incident, resource,

critical infrastructure, and document management – all connected by real time communications capabilities – connect your responders to their resources keeping you aware, informed, and making a difference.



mounted radiation detector and the "INSTADOSE" Digital Dosimetry System.

Laurus Systems Inc., Sales, service, calibration of instruments for radiation detection! New this year, The "Mini rad-V", vehicle



Departments. Our commitment to you, prompt quality service at competitive pricing.

For 18 years **LifeSavers** has supplied first aid and safety products to OEM, Fire, EMS, and Police



Little Hearts Big World, LLC • Little Hearts Big World, LLC is a training company that specializes in providing high quality training and services for community, municipalities, and emergency services.



Lucky Dog Custom Apparel Offering a full service approach to custom apparel and promotional products. Screen printing and embroidery offered on-site. Everything from tee shirts to uniforms to office wear to safety & team gear.

Main Street Solars patented technology provides a cost effective way to provide auxiliary traffic control during an unexpected outage



that combine fiber optic infrastructures with innovative networking equipment. Our solutions enhance business efficiency, reduce costs, secure data and improve your overall network. We are your single point of contact for endless possibilities.

Millennium Communications Group Inc. provides advanced communication infrastructures utilizing integrated technology solutions. We offer broad IT solutions



Platform (IRAPP), emergency preparedness agencies collaborate in real time to create situational awareness through shared radio, video and data assets. The IRAPP allows new, existing and vintage communication systems to share resources through a secure, IP-based network. Mutualink's vision is to create an adaptive, scalable nationwide collaboration network, using the model incubated in New Jersey.

Mutualink is a secure multimedia resource-sharing platform used by dozens of New Jersey communities. Through the Interoperable Response and Preparedness



collaborate with one another.

NC4 delivers safety and security solutions that revolutionize how organizations collect, manage, share and disseminate information to reduce cyber threats, fight crime, manage incidents, and securely communicate and



New Jersey Department of Environmental Protection – Bureau of Dam Safety and Flood Control • The Dam Safety program works to ensure the safety and integrity of dams in New Jersey, thereby protecting people and property from the consequences of dam failures.



WHEN YOU NEED TO ALERT THOUSANDS
IN SECONDS

BOOTH: #103



www.swiftreach.com • info@swiftreach.com
1 800.794.3891

Snow Plows
Snow Plow Parts
Trailers
Trailer Parts
Auto, Truck and
Trailer Accessories

State Contract # A82779
Index # T-2622



New Jersey Locations:
Roselle Park, Hawthorne, Pequannock

YES,
WE
INSTALL!

FDR Hitches

SALES AND SERVICE 888-337-4482

goFDR.com

PREPARATION IS EVERYTHING

EMERGENCY MANAGEMENT SOLUTIONS THAT MAKE A
DIFFERENCE WHEN EVERY SECOND COUNTS.



Learn More:
millenniuminc.com/eec
info@millenniuminc.com
800.677.1919

One Point of Contact. Endless Possibilities.
Millennium Communications Group has the experience and expertise to provide cutting-edge solutions for Emergency Management. We will develop a tailored solution that addresses key business challenges, utilizes new technologies, and enhances operational efficiencies. With technology innovations that aid in emergency management, we are your single point of contact, for your emergency preparedness needs.

Visit us at booth 102



Contract Holder
Contract #GS-35F-0220R



KNOW IMMEDIATELY WHO IS RESPONDING!

And so much more!



Dispatches to your mobile devices • Mapping
Hydrants • Messaging • Incident Reporting • AVL
NFIRS • Scheduling • Records Management

(877) 509-0381 www.iamresponding.com

New Jersey Division of Fire Safety The mission of the New Jersey Division of Fire Safety shall be to serve as the central focus for the State's fire service community and the general public in all matters relating to fire safety through the development and enforcement of the State Uniform Fire Code, public education programs and firefighter training programs.

New Jersey Emergency Management Association - Our organization is committed to strengthening and promoting assistance and guidance to our members. We work and communicate across all functions, levels, localities and with other emergency service groups to build new and lasting relationships throughout the State uniting in a common goal to protect the property and lives of all residents within New Jersey. We challenge ourselves by embracing innovation, creativity and technology in all aspects of our work.



New Jersey Emergency Vehicles sells PL Custom, Rescue 1, Smeal, Miller Coach and Danko products throughout New Jersey and services any make of emergency vehicle and fire apparatus.



New Jersey Office of Emergency Management is responsible for coordinating and facilitating all emergency management mitigation, preparedness, response and recovery operations in New Jersey. Four bureaus, including Operational Planning, Emergency Management, Communications and Operational Dispatch form

the core of the organization. Through comprehensive and strategic planning, responder training and exercising the NJOEM utilizes an all-hazards approach to fulfilling its mission. Special program emphasis is applied to unique hazards such as hurricane evacuation, domestic preparedness, terrorism and risk reduction. Visit us at www.state.nj.us/njoem/.



New Jersey VOAD coordinates NJ organizations active in disaster and fosters cooperation and communication in preparedness, response, and recovery to improve services to people and communities affected by disaster.



PHILADELPHIA UNIVERSITY

Philadelphia University's M.S. Disaster Medicine and Management program provides a comprehensive foundation of disaster medicine and emergency management principles and practice. Students and graduates will prepare for, respond to and recover from natural and man-made disasters and mass casualty incidents. Through experiential learning and intensive online work, learners apply written and verbal communication skills, research analysis, interdisciplinary collaboration, and critical thinking to operational approaches of disaster management.

Pinnacle Wireless

Pinnacle Wireless is the premier service provider of wireless infrastructure and systems integration for public safety and commercial communications applications. Pinnacle specializes in Distributed Antenna Systems, Land Mobile Radio, microwave, and video surveillance. Pinnacle has extensive experience and technology that enables us to consistently exceed industry standards in innovation.



25 Years PMC Associates is a family owned and operated business providing wireless communications solutions to the public safety community for over 25 years.



PSE&G

Public Service Enterprise Group (PSEG) (NYSE:PEG) is a publicly traded diversified energy company with annual revenues of more than \$11

billion, and three principal subsidiaries: PSEG Power, PSEG Energy Holdings, and Public Service Electric and Gas Company (PSE&G). PSEG Power is a major unregulated independent power producer in the U.S. with three main subsidiaries: PSEG Fossil, PSEG Nuclear, and PSEG Energy Resources and Trade. PSEG Power operates one of the most balanced portfolios in the country, both in terms of fuel mix and market segment. PSE&G is the largest subsidiary of PSEG and one of the largest combined electric and gas companies in the United States, as well as New Jersey's oldest and largest publicly owned utility. PSE&G currently serves nearly three quarters of New Jersey's population in a service area consisting of a 2,600-square-mile diagonal corridor across the state from Bergen to Gloucester Counties.

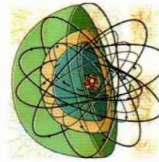

SME Associates - The company specializes in radiation monitoring instrumentation. Atlantic Nuclear is Ludlum Measurements Representative including decontamination accessories. SME Associates provides radiological safety and training.



SwiftReach provides simply yet powerful mass communications solutions. A user-friendly interface and intuitive mobile app enables users to create/launch any voice,

text, email and/or social media alert to a defined population. Backed by the SwiftReach NDN™ (Notification Delivery Network), public safety officials can effectively communicate emergency response efforts and keep residents informed.



tuesday's children

Formed in the aftermath of 9/11, **Tuesday's Children** is a response and recovery organization that supports youth, families, and communities impacted by terrorism and traumatic loss.



U.S. Flood Control Our Emergency Tiger Dam System is re-usable and environmentally friendly can be made into any shape and size (18 inches - 32 feet high and can be anywhere from 50 feet to 100 miles in length).



V.E. RALPH offers a complete line of emergency medical, mass casualty, and incident command equipment. For over 60 years, we have served public safety providers and emergency management teams in both the public and private sectors. We can source, specify, and deliver a wide range of products for your needs.



Verizon Wireless • The Verizon Wireless Business Continuity/Disaster Recovery (BC/DR) program focuses on identifying potential risks, implementing preventative measures, and by developing and testing BC/DR plans to reduce the impact of a disruption. Verizon Wireless works to keep our wireless network the Nation's most reliable, so we're ready for any disaster that may affect our customers and communities, and know these ongoing preparations matter. The Verizon Wireless network has been tested time and again when disaster strikes – be it hurricanes, wildfires, tornados or other disaster affecting our communities. We understand the importance of wireless communication in disasters and prepare year-round, so customer can rely on our network to keep them, their families, friends and employees connected – even when the unexpected strikes. By

EMERGENCY MANAGEMENT & LEADERSHIP

UNDERGRADUATE AND GRADUATE CERTIFICATES

Developed in partnership with key professional training organizations,
American Military University offers public safety leaders:

- Support through scholarship programs
- Cohort class registration options
- Financial incentives available for select partnerships

TAKE THE NEXT STEP TOWARD YOUR LEADERSHIP GOALS. LEARN MORE TODAY AT
PUBLICSAFETYATAMU.COM/NJEPA2015



American Military University is part of the accredited American Public University System, and is certified to operate by SCHEV.

building solid Public / Private partnerships with the Emergency Response community, Verizon Wireless becomes an integral part of planning, response and recovery efforts. The importance of these partnerships can never be overstated and we will continue our efforts, so that our partners know firsthand they can rely on us to keep them connected, as they respond to those who are affected by disaster".



Since 1988, **Western Shelter Systems** has been a market leader in manufacturing high quality sheltering solutions for the disaster and medical

response community around the world. Western Shelters have served as the standard for FEMA US&R teams in response to every major hurricane over the past 24 years. Our product line includes ridged and inflatable framed shelters; accessories such as HVAC, power generation and water handling for remote operations; and customized trailer systems and container based field hospitals designed to withstand the most austere environments.



Witt O'Brien's is a global leader in crisis and emergency management, with unrivaled experience and

knowledge of public safety, disaster mitigation, continuity of operations, and emergency management issues. We offer a full range of services to better prepare your organization before disaster strikes and help you recover more quickly if it does.



Zodiac Aerospace. Air Cruisers Company, LLC, dba Zodiac Aero Evacuation Systems, is a NJ based Manufacturer of Inflatable Emergency Evacuation Systems and Decontamination Shelters.



The Salvation Army - The Salvation Army's mission is to provide Emergency Disaster Services throughout all of the New Jersey Division utilizing local volunteers, staff, officers and local resources to both survivors and first responders in a timely manner. We will work with other response agencies to help provide physical, emotional and spiritual care at the time of need for as long as the need exists.



Servpro of Freehold, Middletown, and So. Jersey City/Bayonne specializes in the restoration and cleanup of water, mold and fire damage. We provide 24/7 emergency

service and offer reconstruction, duct cleaning, and carpet cleaning, sales and installation. We strive to restore your property "Like It Never Even Happened." servprooffreehold.com



K-9 Response Team



ORION

Futurity

Damage Assessment Solution

MANY THANKS
to the dedicated volunteers that make the
New Jersey Emergency
Preparedness Conference possible.

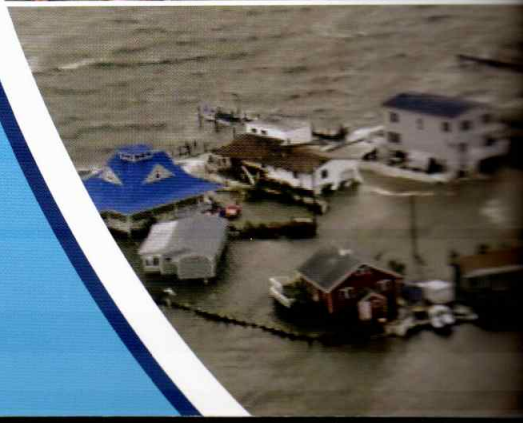

N J E P A

New Jersey Emergency Preparedness Association

P0 Box 962 Mays Landing, NJ 08330
609-548-8357 • njepa.org